



# Westinghouse

***STEAM AND SPRAY* Iron**



WST5020

You can be sure...if it's Westinghouse

# **IMPORTANT SAFEGUARDS**

When using electrical appliances, basic safety precautions should always be followed, including the following:

1. Read all instructions.
2. Use iron only for its intended use.
3. To protect against a risk of electric shock, do not immerse the iron in water or other liquids.
4. The iron should always be turned to the "MIN" setting before plugging or unplugging from outlet. Never yank cord to disconnect from outlet; instead, grasp plug and pull to disconnect.
5. Do not allow cord to touch hot surfaces. Let iron cool completely before putting away. Loop cord loosely around iron when storing.
6. Always disconnect iron from electrical outlet when filling with water or emptying and when not in use.
7. Do not operate iron with a damaged cord or if the iron has been dropped or damaged. To avoid the risk of electric shock, do not disassemble the iron. Incorrect reassembly can cause a risk of electric shock when the iron is used. Contact Consumer Service for examination and repair.
8. Close supervision is necessary for any appliance being used by or near children. Do not leave iron unattended while connected or on an ironing board.
9. Burns can occur from touching hot metal parts, hot water, or steam. Use caution when you turn a steam iron upside down---there may be hot water in the water tank.

## **SPECIAL INSTRUCTIONS**

1. To avoid a circuit overload, do not operate another high wattage appliance on the same circuit.
2. If an extension cord is absolutely necessary, a 15-ampere cord should be used. Cords rated for less amperage may overheat. Care should be taken to arrange the cord so that it cannot be pulled or tripped over.

## **SAVE THESE INSTRUCTIONS**

**For Household Use Only**

# **ADDITIONAL IMPORTANT SAFEGUARDS**

**CAUTION HOT SURFACES:** This appliance generates heat and escaping steam during use. Proper precautions must be taken to prevent the risk of burns, fires or other injury to persons or damage to property.

1. All users of this appliance must read and understand this Owner's Manual before operating or cleaning this appliance.
2. The cord to this appliance should be plugged into a 120V AC electrical outlet only.
3. If this appliance begins to malfunction during use, immediately unplug the cord. Do not use or attempt to repair the malfunctioning appliance.
4. Do not leave this appliance unattended during use.

## **Polarized Plug**

This appliance has a polarized plug (one blade is wider than the other). To reduce the risk of electric shock, this plug is intended to fit into a polarized outlet only one way. If the plug does not fit fully in the outlet, reverse the plug. If it still does not fit, contact a qualified electrician. Do not attempt to modify the plug in any way.

## **Electric Power**

If the electrical circuit is overloaded with other appliances, your appliance may not operate properly. It should be operated on a separate electrical circuit from other appliances.

# Getting To Know Your Iron

Product may vary slightly from illustrations.

## Adjustable Steam Control:

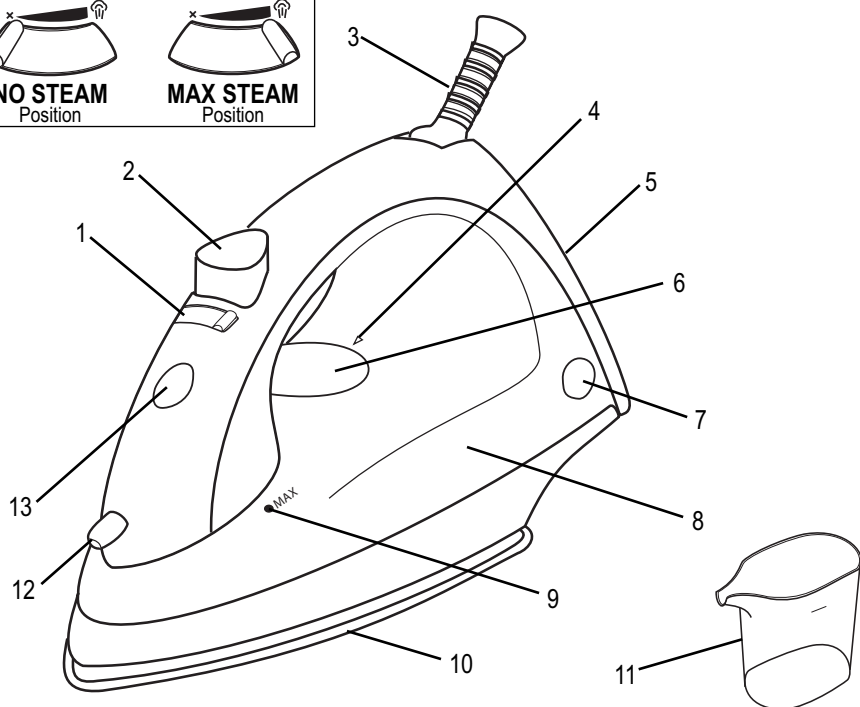
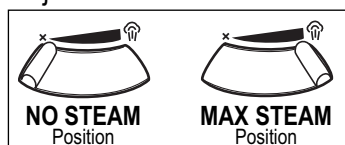

1. Adjustable Steam Control
2. Spray Button
3. Pivot Cord
4. Selection Arrow
5. Heel Rest
6. Temperature Control Dial
7. Thermostat Light

8. Water Tank
9. Maximum Water Level Line
10. Non-stick Soleplate
11. Filler Cup (P/N 50761)
12. Spray Nozzle
13. Water Fill Opening

## Before First Use

1. Remove all packaging materials from the Soleplate and the body of the Iron. Unwind and straighten the power cord.
2. Flush the soleplate steam vents to ensure that no stain is transferred onto the fabric from residue possibly left in the vents from the manufacturing process. (See USER MAINTENANCE INSTRUCTIONS.)

**NOTE:** When the Iron is used for the first time, you may notice a slight amount of smoke; this is normal and will stop after a few minutes as the Iron continues to heat.

## Spray Button

Use the Spray Button to moisten dry, difficult fabrics and to handle stubborn wrinkles. Simply aim the Spray Nozzle and press the Spray Button. The Spray function is also handy for moistening creases accidentally ironed into fabric. The Spray function can be used on any setting and does not affect the ironing temperature.

### *~ Ironing Tips ~*

- For best results, check garment labels for the temperature and steam setting recommended by the fabric manufacturer.
- Always iron garments that require a low temperature first. This will prevent damage to garments by using an iron that is too hot.
- If you are unsure of a garment's fabric content, start on a low setting and test the iron on an area of the garment that does not show, such as a seam. Gradually increase the heat setting until wrinkles remove without damaging the fabric.
- To freshen up garments made of velvet, felt, suede or velour, hold the steaming iron horizontally 2 inches (5cm) above the fabric for a gentle steaming. Make sure the iron does not come in contact with the fabric.
- To prevent shine, iron dark garments or those made of silk, acetate or rayon inside out.

# OPERATING INSTRUCTIONS

## Using as a Dry Iron

The Iron can be used on the dry setting with or without water in the Water Tank. However, it is best to avoid having water in the Water Tank while dry ironing.

1. Turn the Temperature Control Dial to the “MIN” setting and make sure that the Adjustable Steam Control is in the NO STEAM position.
2. Stand the Iron in the vertical position (on its Heel Rest) on a heat resistant surface and plug into a 120V outlet.
3. Turn the Temperature Control Dial to the desired setting. The red Thermostat Light will illuminate, indicating that the Iron is heating.

**NOTE:** For best results, check garment labels for the temperature setting recommended by the fabric manufacturer.

4. Once the Iron has reached the set temperature, the red Thermostat Light will go off, indicating that the Iron is ready for use.

**NOTE:** The red Thermostat Light will continue to cycle off and on during use as the Iron maintains the desired temperature.

5. When changing from a higher temperature setting to a lower temperature setting, wait until the red Thermostat Light cycles on and then off again before ironing.
6. When finished ironing, turn the Temperature Control Dial to the “MIN” position and unplug the Iron. Stand the Iron back in the vertical position (on its Heel Rest) and allow it to cool completely before cleaning or storing.

**WARNING:** Never fill the Water Tank while the Iron is still hot.

## Using as a Steam Iron

The Temperature Control Dial must remain at the “MAX” setting while steam ironing.

1. Turn the Temperature Control Dial to the “MIN” setting and make sure that the Adjustable Steam Control is in the NO STEAM position.
2. Make sure that the Iron is unplugged and has cooled completely before filling.

**CAUTION: IF THE IRON IS HOT, DO NOT FILL WITH WATER.**

3. **Filling the Water Tank:** Place the Iron in the horizontal position (on its Soleplate). Using the Filler Cup provided, slowly pour water through the Water Fill Opening until the Water Tank is filled to the Maximum Water Level Line; DO NOT OVERFILL.

**IMPORTANT: Use tap water or distilled water only. Do not use chemically descaled water or any other liquids.**

4. With the Water Tank full, stand the Iron in the vertical position (on its Heel Rest) on a heat resistant surface and plug into a 120V outlet.
5. Turn the Temperature Control Dial to the “MAX” setting. The red Thermostat Light will illuminate, indicating that the Iron is heating.

**NOTE:** For best results, check garment labels for the temperature and steam settings recommended by the fabric manufacturer.

6. Once the Iron has reached the set temperature, the red Thermostat Light will go off, indicating that the Iron is ready for use.

**NOTE:** The red Thermostat Light will continue to cycle off and on during use as the Iron maintains the desired temperature.

7. Slide the Adjustable Steam Control to the desired setting. Steam will be released continuously once the Iron is held in the horizontal position.

**NOTE:** Steam can be stopped by holding the Iron in the vertical position, or by sliding the Adjustable Steam Control back into the NO STEAM position.

**CAUTION: AVOID COMING IN CONTACT WITH ESCAPING STEAM.**

8. When finished ironing, press the Steam Button into the NO STEAM position, turn the Temperature Control Dial to the "MIN" setting, and unplug the Iron. If necessary, empty the Water Tank (see "Emptying the Water Tank"). Stand the Iron back in the vertical position (on its Heel Rest) and allow it to cool completely before cleaning or storing.

**NOTE:** The Water Tank should be emptied after each use.

## **Emptying the Water Tank**

The Water Tank should be emptied after each use.

1. After use, slide the Adjustable Steam Control into the NO STEAM position, turn the Temperature Control Dial to the "MIN" setting, and unplug the Iron.
2. While the Iron is still warm, hold the Iron over a sink and turn the Iron upside down, allowing water to drain from the Water Fill Opening.
3. Stand the Iron back in the vertical position (on its Heel Rest). The warmth of the Iron should dry out any remaining water.

**CAUTION: AVOID COMING IN CONTACT WITH WATER OR ESCAPING STEAM.**



# USER MAINTENANCE INSTRUCTIONS

This appliance requires little maintenance. It contains no user serviceable parts. Do not try to repair it yourself. Any servicing requiring disassembly must be preformed by a qualified appliance repair technician.

## Care and Cleaning

**CAUTION:** Unplug the Iron from the electrical outlet and allow it to cool completely before cleaning and storing. Never immerse the Iron in water or any other liquid.

**NOTE:** Do not put any chemical cleaning agents or solvents in the Water Tank, or on any part of the Iron.

1. Moisten a soft cloth with a dab of vinegar to remove spots from the Soleplate. Take care not to scratch the non-stick coating.

**CAUTION:** Never use scouring pads or abrasive cleaners on the Soleplate, as this may scratch the surface.

2. Wipe the outside surfaces of the Iron with a damp cloth. If necessary, use a small amount of mild detergent to clean.
3. Before using again, preheat and move the iron over an old cloth several times to remove any residue from the Soleplate.

## Flushing

Flushing the iron is advised after every 5 uses or more regularly to prevent harmful mineral build-up that can clog the iron and prevent it from heating and steaming properly.

1. With the Iron unplugged, turn the Temperature Control Dial to the “MIN” setting and slide the Adjustable Steam Control into the NO STEAM position. Make sure that the Iron has cooled completely.

**CAUTION: IF THE IRON IS HOT, DO NOT FILL WITH WATER.**

2. **Filling the Water Tank:** Place the Iron in the horizontal position (on its Soleplate). Using the Filler Cup provided, slowly pour water through the Water Fill Opening until the Water Tank is filled to the Maximum Water Level Line; DO NOT OVERFILL.

**IMPORTANT: Use tap water or distilled water only. DO NOT use chemically descaled water or any other liquids. DO NOT put any chemical cleaning agents or solvents into the Water Tank.**

3. With the Water Tank full, stand the Iron in the vertical position (on its Heel Rest) on a heat resistant surface and plug into a 120V outlet.
4. Turn the Temperature Control Dial to the “MAX” setting. The red Thermostat Light will illuminate, indicating that the Iron is heating. Once the Iron has reached the set temperature, the red Thermostat Light will go off, indicating that the Iron is ready for use.
5. Hold the Iron horizontally over a basin or bowl and slide the Adjustable Steam Control into the MAX STEAM position -- steam will begin to flow through the Soleplate. Continue to hold the Iron in this position until the Water Tank is empty. Water and steam will flush the scale and dust through the Soleplate and into the basin.

**CAUTION: AVOID COMING IN CONTACT WITH ESCAPING STEAM.**

6. When the Water Tank is empty, slide the Adjustable Steam Control into the NO STEAM position, turn the Temperature Control Dial to the “MIN” setting, and unplug the Iron. Stand the Iron back in the vertical position (on its Heel Rest) and allow it to cool completely before storing.

## Storing the Iron

Remove the cord from the outlet by grasping the plug -- **never pull on the cord**. Empty the Water Tank after each use (see “Emptying the Water Tank”). **Allow the Iron to cool completely before storing**. To protect the Soleplate, stand the Iron in an upright position on its Heel Rest; wrap the cord loosely around the base of the Iron.

# LIMITED ONE-YEAR WARRANTY

**Warranty Coverage:** This product is warranted to be free from defects in materials or workmanship for a period of one (1) year from the original purchase date. This product warranty is extended only to the original consumer purchaser of the product and is not transferable. For a period of one (1) year from the date of original purchase of the product, our Repair Center will, at its option, either (1) repair the product or (2) replace the product with a reconditioned comparable model. These remedies are the purchaser's exclusive remedies under this warranty.

**Warranty Service:** To obtain warranty service, you must call our warranty service number at 1-800-233-9054 for return instructions on how to deliver the product, in either the original packaging or packaging affording an equal degree of protection to the Repair Center specified below. You must enclose a copy of your sales receipt or other proof of purchase to demonstrate eligibility for warranty coverage.

**To return the appliance, ship to:**

ATTN: Repair Center  
708 South Missouri Street  
Macon, MO 63552 USA

**To contact us, please write to, call, or email:**

Consumer Relations Department  
PO Box 7366  
Columbia, MO 65205-7366 USA  
Phone: 1-800-233-9054  
Email: [consumer\\_relations@toastmaster.com](mailto:consumer_relations@toastmaster.com)

**What Is Not Covered:** This warranty does not cover damage resulting from misuse, accident, commercial use, improper service or any other damage caused by anything other than defects in material or workmanship during ordinary consumer use. This warranty is invalid if the serial number has been altered or removed from the product. This warranty is valid only in the United States and Canada.

**LIMITATION ON DAMAGES:** THERE SHALL BE NO LIABILITY FOR ANY INCIDENTAL OR CONSEQUENTIAL DAMAGES FOR BREACH OF ANY EXPRESS OR IMPLIED WARRANTY OR CONDITION ON THIS PRODUCT.

**DURATION OF IMPLIED WARRANTIES:** EXCEPT TO THE EXTENT PROHIBITED BY APPLICABLE LAW, ALL IMPLIED WARRANTIES AND CONDITIONS, INCLUDING, WITHOUT LIMITATION, IMPLIED WARRANTIES AND CONDITIONS OF MERCHANTABILITY AND FITNESS FOR A PARTICULAR PURPOSE OR USE ON THIS PRODUCT ARE LIMITED IN DURATION TO THE DURATION OF THIS WARRANTY.

Some jurisdictions do not allow the exclusion or limitation of incidental or consequential damages, or allow limitations on how long an implied warranty lasts, so the above limitations or exclusions may not apply to you. This warranty gives you specific legal rights and you may have other rights under the laws of your jurisdiction.

For more information on our products, visit our website: [www.maxim-toastmaster.com](http://www.maxim-toastmaster.com).

WESTINGHOUSE,  and "YOU CAN BE SURE...IF IT'S WESTINGHOUSE" are trademarks of WESTINGHOUSE ELECTRIC CORPORATION and used under license.