

Michael Graves Coffee Maker

owner's manual

SAVE THIS USE AND CARE BOOK



Model MGCM10

IMPORTANT SAFEGUARDS

When using electrical appliances, basic safety precautions should always be followed, including the following:

1. Read all instructions.
2. Do not touch hot surfaces. Use handles or knobs.
3. To protect against electric shock, do not place cord, plugs, or appliance in water or other liquid.
4. Close supervision is necessary when any appliance is used by or near children.
5. Unplug from outlet when not in use and before cleaning. Allow to cool before putting on or taking off parts, and before cleaning the appliance.
6. Do not operate any appliance with a damaged cord or plug or after the appliance malfunctions, or has been damaged in any manner. Contact Consumer Service for examination, repair or adjustment.
7. The use of an accessory not evaluated for use with this appliance may cause injuries.
8. Do not use outdoors.
9. Do not let cord hang over edge of table or counter, or touch hot surfaces.
10. Do not place on or near a hot gas or electric burner, or in a heated oven.
11. To disconnect, press **POWER** Button to "off", then remove plug from wall outlet.
12. Do not use for other than intended use.
13. Be certain Lids are securely in place before operating appliance.
14. Scalding may occur if the lid is removed during the brewing cycle.
15. The carafe is designed for use with this appliance. It must never be used on a range top.
16. Do not set a hot carafe on a wet or cold surface.
17. Do not use a cracked carafe or a carafe having a loose or weakened handle.
18. Do not clean carafe with cleansers, steel wool pads, or other abrasive material.

SAVE THESE INSTRUCTIONS

For Household Use Only

Additional Important Safeguards

WARNING: This appliance generates heat and escaping steam during use. Use proper precautions to prevent the risk of burns, fires, or other injury to persons or damage to property.

1. All users of this appliance must read and understand this Owner's Manual before operating or cleaning this appliance.
2. The cord to this appliance should be plugged into a 120V AC electrical outlet only.
3. Use **water only** in this appliance! Do not put any other liquids or food products in this appliance. Do not mix or add anything to the water placed in this appliance, except as instructed in the User Maintenance Instructions to clean the appliance.
4. DO NOT attempt to move an appliance containing hot liquids. Allow appliance to cool completely before moving.
5. Keep appliance at least 4 inches away from walls or other objects during operation. Do not place any objects on top of appliance while it is operating. Place the appliance on a surface that is resistant to heat.
6. If this appliance begins to malfunction during use, immediately unplug the cord. Do not use or attempt to repair the malfunctioning appliance.
7. If this appliance falls or accidentally becomes immersed in water or any other liquid, unplug it immediately. **Do not reach into the water! Do not use this appliance after it has fallen into or has become immersed in water.** Contact Consumer Service for examination and repair.
8. Do not leave this appliance unattended during use.
9. The appliance must be left to cool down sufficiently before adding more water to avoid splattering.
10. Always use fresh, cool water in your appliance. Warm water or other liquids, except as listed in cleaning section, may cause damage to the appliance.
11. DO NOT put Carafe into a microwave.
12. DO NOT leave empty Carafe on Warming Plate when appliance is turned ON, as the carafe may crack or become otherwise damaged.
13. DO NOT lift Filter Basket Lid until brewing is complete, and all parts have cooled.
14. **CAUTION: To prevent injury when utilizing Drip-Stop feature, replace Carafe within 1 minute of removing during brewing process.**

Polarized Plug

This appliance has a **polarized plug** (one blade is wider than the other). To reduce the risk of electric shock, this plug is intended to fit into a polarized outlet only one way. If the plug does not fit fully in the outlet, reverse the plug. If it still does not fit, contact a qualified electrician. Do not attempt to modify the plug in any way.

Short Cord Instructions

A short power-supply cord is provided to reduce the risk resulting from becoming entangled in or tripping over a longer cord.

Do not use an extension cord with this product.

Electric Power

If the electric circuit is overloaded with other appliances, your appliance may not operate properly. It should be operated on a separate electrical circuit from other appliances.

CAUTION: To prevent Plasticizers from migrating from the finish of the countertop or tabletop or other furniture, place **NON-PLASTIC** coasters or placemats between the appliance and the finish of the countertop or tabletop.

Failure to do so may cause the finish to darken, permanent blemishes may occur or stains can appear.

WARNING: TO REDUCE THE RISK OF FIRE OR ELECTRIC SHOCK, DO NOT REMOVE THE BOTTOM COVER. NO USER-SERVICEABLE PARTS INSIDE. REPAIR SHOULD BE DONE BY AUTHORIZED SERVICE PERSONNEL ONLY.

Getting To Know Your Michael Graves MGCM10 Coffee Maker

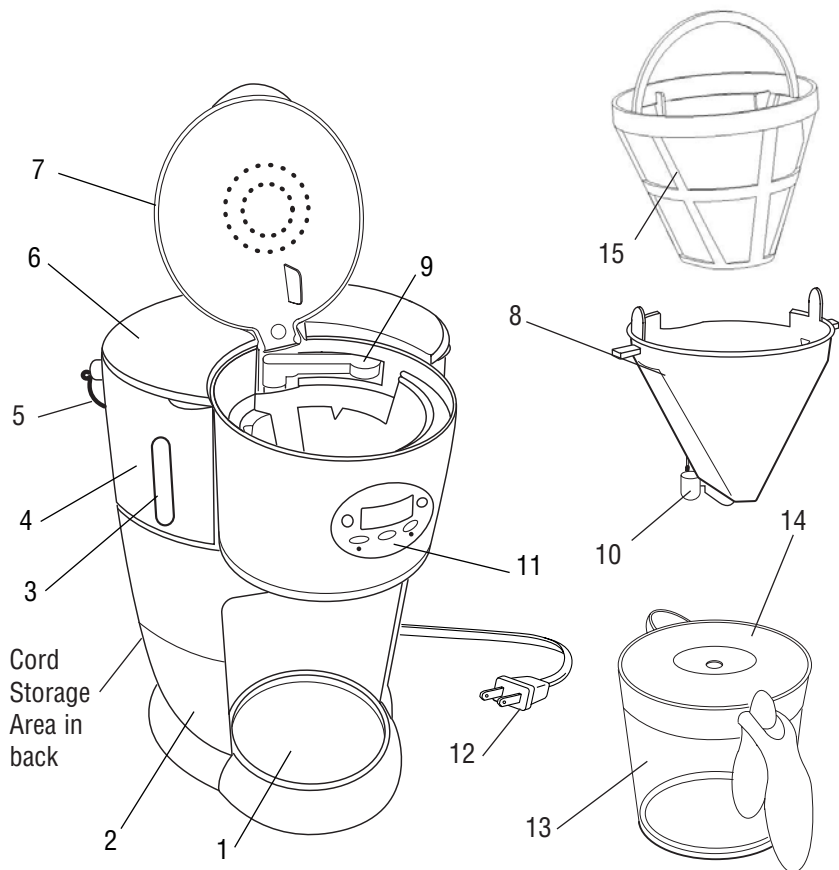

- | | |
|----------------------------------|------------------------------------|
| 1. Warming Plate | 9. Drip Arm |
| 2. Base | 10. Drip-Stop Assembly (P/N 31056) |
| 3. Water Level Indicator | 11. Control Panel / LCD Clock |
| 4. Reservoir (P/N 31050) | 12. Power Cord |
| 5. Reservoir Handle (P/N 31051) | 13. Carafe (with Lid, P/N 31057) |
| 6. Reservoir Lid (P/N 31052) | 14. Carafe Lid (P/N 31058) |
| 7. Filter Basket Lid (P/N 31053) | 15. Nylon Filter (P/N 31092) |
| 8. Filter Basket (P/N 31055) | |

Before First Time Use

CAUTION: Do not immerse Coffee Maker Base, Cord, or Plug into water or any other liquid.

Clean Coffee Maker System

1. To clean Coffee Maker of manufacturing residue, lift and remove the Reservoir and fill it with fresh, cold water to the 10-cup level. Close the Reservoir Lid and return it to the Coffee Maker.
2. Raise the Filter Basket Lid. **IMPORTANT:** Lock the Filter Basket in place by aligning the Tabs on the sides of the Filter Basket with the mating slots in the Housing. Push the Filter Basket down and rotate clockwise until the Filter Basket locks in place. (Reference "LOCK" direction on front tab of Filter Basket).
3. Swing the Drip Arm over the Filter Basket and lower the Filter Basket Lid. If the Filter Basket Lid does not fully close, the Drip Arm may not be properly centered or the Filter Basket not correctly locked in place. **NOTE: THE LID SHOULD NOT BE OPENED WHEN THE RESERVOIR LID IS OPENED.**
4. Plug the Coffee Maker into a 120V AC electrical outlet, then press the **POWER** Button to turn on the Coffee Maker. The green LED Power Light will illuminate. The Coffee Maker will "brew" the clear water to rinse the Coffee Maker's system.
5. Once the brewing cycle is complete, press the **POWER** Button to turn the Coffee Maker off. The LED beneath the button will turn off. Allow Coffee Maker to cool for 10-15 minutes. Discard the water in the Carafe.
6. Wash the Carafe, Filter Basket, Nylon Filter and Water Reservoir in warm, soapy water. Rinse well and dry thoroughly. **Do not wash removable parts in dishwasher.**
7. Wipe Coffee Maker with a soft, clean cloth or sponge. **Never immerse Coffee Maker Base in water or any other liquid.**

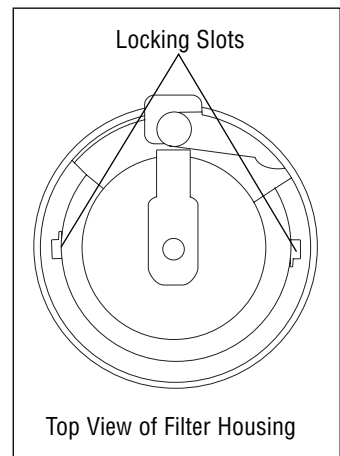
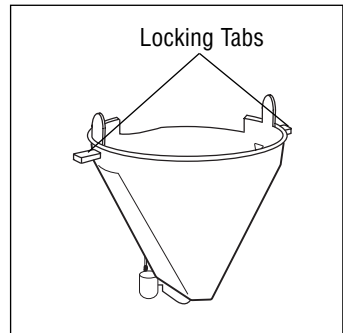

Setting the Clock

1. Plug the Coffee Maker into a 120V AC electrical outlet.

As soon as the Coffee Maker receives power, the LCD Clock Display will flash "AM 12:00".

2. Press the **PROGRAM** Button. "SET TIME" will appear in the LCD Display.
3. Press the **HOUR** Button to select the current hour for "AM" or "PM".
4. Press the **MIN** Button to select the current minutes.

NOTE: The HOUR and MIN Buttons can be pressed and held to rapidly advance the numbers.

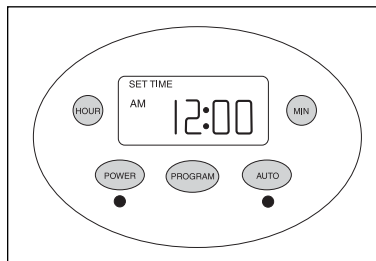

Setting the Timer for Automatic Operation

You may set the Timer to begin brewing coffee up to 24 hours in advance.

IMPORTANT: When programming for automatic operation, always be sure the proper amount of coffee and water are in the Coffee Maker and the Drip Arm is properly centered above the Filter Basket. See *To Brew Coffee* for recommend amounts.

1. After following steps 1-4 above, press the **PROGRAM** Button two times. The LCD Clock Display will show "SET TIMER" and the last set programmed time.
2. Press the **HOUR** Button to select the desired automatic operation hour for "AM" or "PM".
3. Press the **MIN** Button to select the desired automatic operation minutes.

NOTE: The HOUR and MIN Buttons can be pressed and held to rapidly advance the numbers.

4. After 5 seconds the LCD Display will return to the current time setting.
5. Press the **AUTO** Button one time. The green LED Auto Light will illuminate, indicating that the automatic timer has been activated.
6. To check or change the automatic time setting, press the **PROGRAM** Button two times.
7. When the preset time is reached, the Coffee Maker will automatically begin the brewing process.
8. To eliminate the automatic operation, press the **AUTO** Button again, the green LED Auto Light will not be illuminated.

NOTE: If the Coffee Maker is operated before the preset time, the AUTO Button will need to be reactivated. To do this, simply press the AUTO Button and the green LED Auto Light will illuminate.

Instructions for Use

To Brew Coffee

1. Plug the Coffee Maker into a 120V AC electrical outlet.
2. As soon as the Coffee Maker receives power, the clock will flash "AM 12:00." See *Setting the Clock*.

3. Place the Carafe on the Warming Plate.
4. Lift and remove the Reservoir and fill it with fresh, cold water to the desired level (see markings on Water Level Indicator). The Coffee Maker yields up to 10 5-oz. cups.
5. Return the Reservoir to the Coffee Maker, making sure it is properly seated and the Reservoir Lids are closed.
6. Lift the Filter Basket Lid, swing the Drip Arm back towards the Reservoir, and place the Nylon Coffee Filter or a #4 paper coffee filter in the Filter Basket. **DO NOT USE THE PAPER FILTER AND THE NYLON FILTER TOGETHER.**

NOTE: THE LID SHOULD NOT BE OPENED WHEN THE RESERVOIR LID IS OPENED.

7. Use a Measuring Spoon to place the desired amount of ground coffee in the filter. We recommend using one table-spoon for every two cups of coffee, or adjust to your taste. Do not exceed 8 tablespoons of ground coffee.

CAUTION: DO NOT fill with more than 8 spoonfuls (or 2 1/8 ounces) of ground coffee.

8. **IMPORTANT:** Lock the Filter Basket in place by aligning the Tabs on the sides of the Filter Basket with the mating slots in the Housing. Push the Filter Basket down and rotate clockwise until the Filter Basket locks in place.
9. Swing the Drip Arm over the center of the Filter Basket and lower the Filter Basket Lid. If the Lid does not fully close, the Drip Arm may not be properly centered or the Filter Basket not correctly locked in place.
10. Press the **POWER** Button to turn on the Coffee Maker. The green LED Power Light will illuminate and the brewing process will begin.

Note: If you wish to set the timer to make coffee at a later time, see *Setting the Timer for Automatic Operation*.

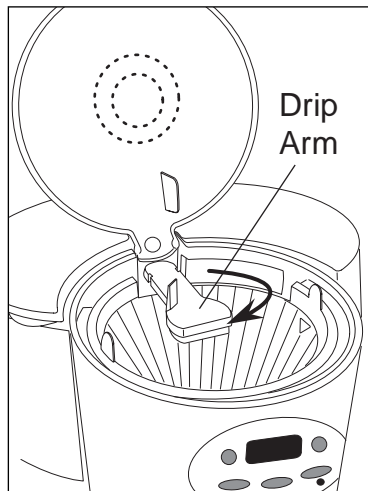
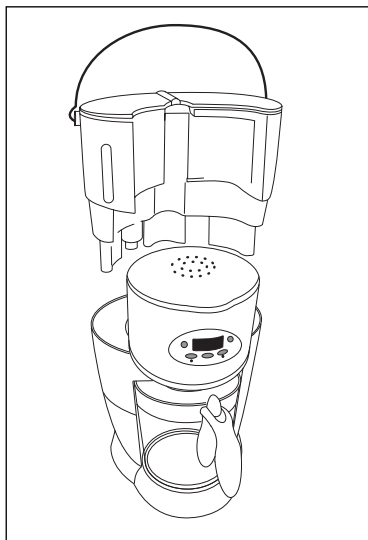

Instructions for Use (Cont.)

11. If you wish to pour a cup of coffee before the Carafe is filled, simply remove the Carafe and pour carefully. The Drip-Stop feature prevents additional brewed coffee from being released until the Carafe has been returned to its position on the Warming Plate.

IMPORTANT: The Drip-Stop feature lasts for 1 minute. Be sure to replace Carafe onto Warming Plate within a 1 minute time period.

12. Press the **POWER** Button to turn off the Coffee Maker, or for your convenience and safety, the Warming Plate will cycle on and off to keep brewed coffee warm for up to two hours.
13. Allow Coffee Maker to cool completely (10-15 minutes) before making another Carafe of coffee or cleaning. Discard used coffee grounds and re-fill with new pre-ground coffee.
14. Clean Coffee Maker as described in *User Maintenance Instructions*.

User Maintenance Instructions

This Michael Graves Coffee Maker requires little maintenance. It contains no user-serviceable parts. Do not try to repair it yourself. Any servicing requiring disassembly other than cleaning must be performed by a qualified appliance repair technician.

CAUTION: *Always unplug Coffee Maker and allow to cool thoroughly before cleaning. Never immerse Coffee Maker Base, Cord, or Plug in water or other liquids. Never use scouring pads or harsh cleansers to clean your Coffee Maker as they may damage the surface.*

1. Make sure the **POWER** Button is off. The green LED Power Light will not be illuminated.
2. Unplug and allow to cool completely before cleaning.
3. Raise the Filter Basket Lid. Swing the Drip Arm back toward the Reservoir. Using the handle, remove the Nylon Coffee Filter and dispose of coffee grounds. If using a #4 paper coffee filter, remove the Filter Basket, as described in step 4 below, and dispose of coffee grounds and paper filter.
4. Unlock the Filter Basket by slightly turning it counterclockwise and lift it from the housing (Reference "RELEASE" direction on front tab of Filter Basket).
5. Wash all removable parts with warm, soapy water. Rinse well and dry all parts thoroughly. **Do not wash removable parts in dishwasher.**
6. Never use scouring pads, harsh or abrasive cleansers, especially those containing alcohol or solvents, as they may damage the surface.
7. Wipe exterior surfaces with a soft, damp cloth or sponge.

Storage

Unplug unit, allow to cool, and clean before storing. Store in its box in a clean, dry place. Never store it while it is hot or still plugged in. Never wrap cord tightly around the appliance, use the Cord Storage Area at the back of the Coffee Maker. Do not put any stress on the cord where it enters the unit, as it could cause the cord to fray and break.

User Maintenance Instructions (Cont.)

DECALCIFYING

For best tasting coffee, and to promote longer use of your Coffee Maker, follow the procedure below for decalcifying every month, or after 30 uses. If you have hard water, you may notice a slowing of the brewing process—an indication you should decalcify more frequently. Decalcify immediately if the brewing process slows or if the Coffee Maker begins to steam during the brewing cycle.

1. Press **POWER** Button to turn machine off. Unplug the Coffee Maker and allow it to cool.
2. Fill Carafe with one cup of vinegar and three cups of cold water.
NOTE: You may also use a commercial cleaner made for automatic Coffee Makers. Follow manufacturer's instructions.
3. Lift Reservoir Lid and pour in the water/vinegar solution.
4. Set Carafe on the Warming Plate.
5. Check to be sure Filter Basket and Drip Arm are properly positioned, as if brewing a pot of coffee.
6. Plug the Coffee Maker into a 120V AC electrical outlet. Press the **POWER** Button to turn the Coffee Maker on. The green LED Power Light will illuminate.
7. Halfway through the brewing process, press **POWER** Button to turn the Coffee Maker off. The green LED Power Light will not be illuminated.
Carefully remove half-filled Carafe and place on a heat-resistant surface. Allow Coffee Maker to sit with cleaning solution for about 15 minutes.
8. Lift Water Reservoir Lid and pour solution in Carafe back into Water Reservoir. Replace Carafe on the Warming Plate.
9. Press **POWER** Button to turn Coffee Maker on. The green LED Power Light will illuminate.
Allow all solution to empty into Carafe. After all dripping stops, press **POWER** Button to turn Coffee Maker off. The green LED Power Light will not be illuminated. Discard solution in Carafe.
10. Allow Coffee Maker to cool for 10-15 minutes.
11. Repeat process for one more brewing cycle with clean, fresh water.
12. Wash Carafe and Filter Basket with hot water and a mild detergent. Rinse and dry thoroughly.

LIMITED ONE YEAR WARRANTY

Warranty: This product is warranted by Salton, Inc. to be free from defects in materials or workmanship for a period of (1) year from the original purchase date. This product warranty covers only the original consumer purchaser of the product.

Warranty Coverage: This warranty is void if the product has been damaged by accident in shipment, unreasonable use, misuse, neglect, improper service, commercial use, repairs by unauthorized personnel, normal wear and tear, improper assembly, installation or maintenance abuse or other causes not arising out of defects in materials or workmanship. This warranty is effective only if the product is purchased and operated in the USA, and does not extend to any units which have been used in violation of written instructions furnished with the product or to units which have been altered or modified or to damage to products or parts thereof which have had the serial number removed, altered, defaced or rendered illegible.

Implied Warranties: ANY IMPLIED WARRANTIES WHICH THE PURCHASER MAY HAVE ARE LIMITED IN DURATION TO ONE (1) YEAR FROM THE DATE OF PURCHASE. Some states do not allow limitations on how long an implied warranty lasts, so the above limitation may not apply to you.

Warranty Performance: During the above one-year warranty period, a product with a defect will be either repaired or replaced with a reconditioned comparable model (at our option) when the product is returned to the Repair Center, or the purchase price refunded. The repaired or replacement product will be in warranty for the balance of the one-year warranty period and an additional one-month period. No charge will be made for such repair or replacement.

Service and Repair: Should the appliance malfunction, you should first call toll-free 1 (800) 233-9054 between the hours of 9:00 am and 5:00 pm Central Standard Time and ask for CONSUMER SERVICE stating that you are a consumer with a problem. Please refer to model number MGCM10 when you call.

In-Warranty Service (USA): For an appliance covered under the warranty period, no charge is made for service or postage. Call for return authorization (1 800 233-9054).

Out-of Warranty Service: A flat rate charge by model is made for out-of-warranty service. Include \$10.00 (U.S.) for return shipping and handling. We will notify you by mail of the amount of the charge for service and require you to pay in advance for the repair or replacement.

For Products Purchased in the USA, but Used in Canada: You may return the product insured, packaged with sufficient protection, and postage and insurance prepaid to the USA address listed below. Please note that all customs duty / brokerage fees, if any, must be paid by you and we will require you to pay the cost of customs duty / brokerage fees to us in advance of our performing any service.

Risk During Shipment: We cannot assume responsibility for loss or damage during incoming shipment. For your protection, carefully package the product for shipment and insure it with the carrier. Be sure to enclose the following items with your appliance: any accessories related to your problem, your full return address and daytime phone number, a note describing the problem you experienced, a copy of your sales receipt or other proof of purchase to determine warranty status. C.O.D. shipments cannot be accepted.

To return the appliance, ship to:

Attn: Repair Center
Salton, Inc.
708 South Missouri Street
Macon, MO 63552

To contact us, please write to, call, or email:

Salton, Inc.
P.O. Box 7366
Columbia, MO 65205-7366
1 800 233-9054
Email: Salton@Saltonusa.com

Limitation of Remedies: No representative or person is authorized to assume for Salton, Inc. any other liability in connection with the sale of our products. There shall be no claims for defects or failure of performance or product failure under any theory of tort, contract or commercial law including, but not limited to negligence, gross negligence, strict liability, breach of warranty and breach of contract. Repair, replacement or refund shall be the sole remedy of the purchaser under this warranty, and in no event shall Salton be liable for any incidental or consequential damages, losses or expenses. Some states do not allow the exclusion or limitation of incidental or consequential damages, so the above limitation or exclusion may not apply to you.

Legal Rights: This warranty gives you specific legal rights, and you may also have other rights which vary from state to state.

For more information on Salton products: Visit our website: <http://www.eSalton.com>

© 2003 Salton, Inc.
All Rights Reserved

P/N 61377
Printed in China

Michael Graves Coffee Maker



Michael Graves

The highly acclaimed work of Michael Graves has restored a sense of humanity to modern architecture. Graves, one of the most noted architects of our time, has designed buildings for such clients as Disney,[™] including the company's corporate headquarters and the Walt Disney[™] World Swan and Dolphin Hotels. Gifted in design at every scale, Michael Graves has created products for the home that carry labels such as Alessi, FAO Schwarz, and Steuben. His work has been recognized with scores of awards. Most recently Michael Graves was selected for the 2001 American Institute of Architects Gold Medal award, the highest honor given by the AIA to an individual. In 1999, President Clinton presented Michael Graves with the National Medal of Arts.

The Michael Graves Design[™] Collection provides an inspired balance of form and function. Sensible and sublime, practical and whimsical, the objects envisioned by this world-renowned architect infuse our daily lives with joy.

A handwritten signature in black ink, which appears to read "Graves". The signature is written in a cursive, flowing style and is underlined with a single horizontal stroke.