

cook's essentials®

HIGH PERFORMANCE KITCHENWARE

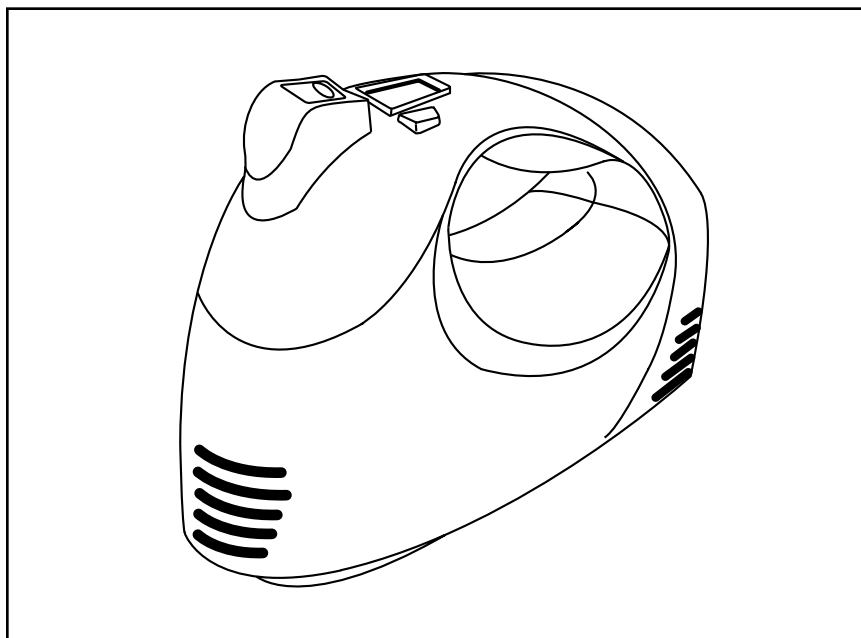

**16 SPEED ELECTRONIC
HAND MIXER**

Model CEHM16

Owner's Manual

IMPORTANT SAFEGUARDS

WARNING: A risk of fire and electric shock exists in all electrical appliances and may cause personal injury or death. Please follow all safety instructions.

When using electrical appliances, basic safety precautions should always be followed including the following:

1. READ ALL INSTRUCTIONS BEFORE USE.
2. To protect against risk of electrical shock, do not immerse body of Mixer, cord or plug in water or other liquids.
3. Close supervision is necessary when Mixer is used near children. This mixer is not for use by children.
4. Unplug from outlet when not in use, before putting on or taking off parts, and before cleaning.
5. Do not operate this or any appliance with a frayed or damaged cord or plug, or after the appliance malfunctions or has been dropped or damaged in any manner. Contact consumer service for repair information.
6. Do not let cord hang over edge of table or counter or touch hot surfaces, including the stove.
7. The use of attachments not recommended or sold by the manufacturer may cause fire, electric shock or injury.
8. Do not use outdoors.
9. To disconnect, depress ON/OFF button to turn Mixer off, then remove plug from wall outlet.
10. Avoid contacting moving parts. Keep hands, hair, clothing, as well as spatulas and other utensils, away from attachments (beaters and dough hooks) during operation to reduce the risk of injury to persons and/or damage to the Mixer.
11. Remove attachments from Mixer before washing them.
12. Do not use the appliance for other than its intended use.

SAVE THESE INSTRUCTIONS

THIS PRODUCT IS FOR HOUSEHOLD USE ONLY.

Additional Important Safeguards

1. All users of this appliance must read and understand this Owner's Manual before operating or cleaning this appliance.
2. The cord to this appliance should be plugged into a 120V AC electrical outlet only.
3. Avoid electric shock by unplugging the Hand Mixer before cleaning.
4. Do not leave appliance unattended while it is operating.
5. Remove attachments from Mixer before washing them.
6. Be sure unit is completely assembled before using.
7. Turn unit off when finished using. Do not disassemble the unit until the motor comes to a complete stop.

Polarized Plug

This appliance has a polarized plug (one blade is wider than the other). As a safety feature to reduce the risk of electrical shock, this plug is intended to fit in a polarized outlet only one way. If the plug does not fit fully into the outlet, reverse the plug. If it still does not fit, contact a qualified electrician. Do not attempt to defeat this safety feature.

Introduction

Congratulations on your purchase of the cook's essentials® 16 Speed Electronic Hand Mixer. Packed with power, this Hand Mixer boasts a full 240 Watts of power with 16 separate speeds — powerful enough to cut through a double batch of cookie dough with ease! The "easy-touch" up/down speed controls make your mixing tasks easy and comfortable.

A large, lighted, digital display features both a speed and mixing time read-out for precise mixing every time. And, don't worry about a quick start-up — this Mixer starts gently every time so you don't have to worry about splatter.

Getting to Know Your CEHM16 Electronic Hand Mixer

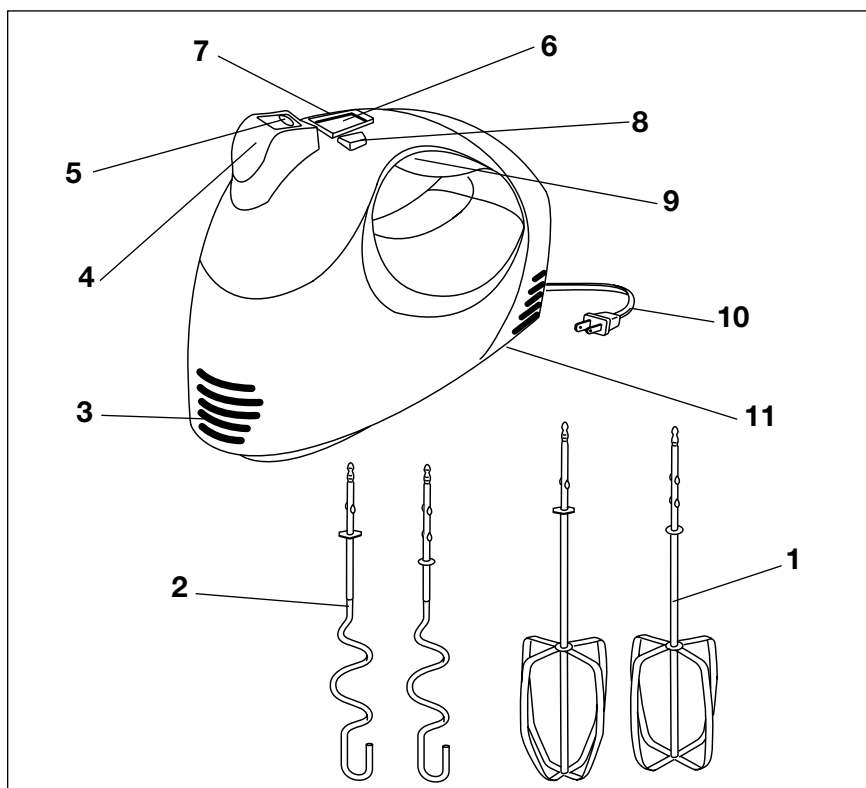

1. **Beaters** - Use to mix batter or whip potatoes. (w/Round Collar P/N 70676; w/Hex Collar P/N 70677)
2. **Dough Hooks** - Use to mix heavy batter and doughs. w/Round Collar P/N 70674; w/Hex Collar P/N 70675)
3. **Ventilation** - Keeps air circulating through the Mixer.
4. **Eject Button** - Allows easy release of beaters or dough hooks.
5. **ON/OFF Button** - Turns the Mixer and digital display on and off.
6. **Digital Display** - Shows level of speed and amount of time running.
7. **Increase Speed Control Button** - Allows easy increase of speeds 1-16.
8. **Decrease Speed Control Button** - Allows easy decrease of speeds 1-16.
9. **Handle**
10. **Retractable Power Supply Cord with Polarized Plug**
11. **Power Supply Cord Retract Button**

Before Using for the First Time

1. Carefully unpack Mixer.
2. Wash Beaters and Dough Hooks in warm, soapy water. Rinse well and dry thoroughly.
3. Wipe Mixer with a soft, clean cloth or sponge. Never immerse the Mixer in water or any other liquid.

HOW TO INSTALL YOUR MIXER ATTACHMENTS

CAUTION: Always unplug Mixer from outlet before installing or removing attachments. Use either both beaters or both dough hooks. Do not attempt to use a dough hook with a beater. This could damage the Mixer.

NOTE: The Left-hand Dough Hook and Beater have a small round metal washer collar around the top of their stems. The Right-hand Dough Hook and Beater have a hexagonal collar around the top of their stems. The attachment with the hex collar is to be inserted into the matching hole in the bottom of the Mixer. See Figure 1.

1. Unplug Mixer.
2. Choose attachment type. **Do not attempt to use a beater with a dough hook; use same type attachments only.**
3. Push attachment stem into Mixer hole and rotate until it locks into position. See Figure 1. The attachment will fit snugly into the hole. Repeat for second attachment.
4. After installing attachment(s), gently tug on each attachment to be sure it is secure.

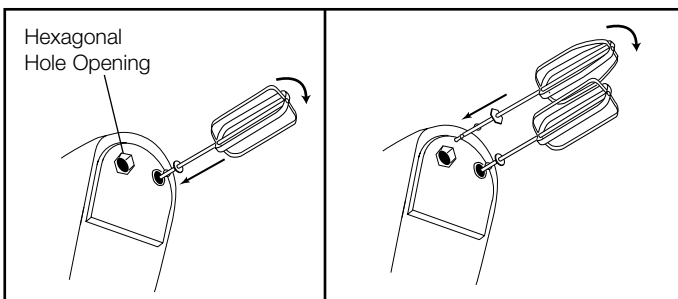

Figure 1

Operating Instructions

1. Be sure Mixer is unplugged and the ON/OFF Button is in the "OFF" position.
2. Attach Beaters or Dough hooks. (See "HOW TO INSTALL YOUR MIXER ATTACHMENTS", page 5).
3. Slowly pull out on the Retractable Cord and release slightly until it locks into position. Plug Mixer into a standard 120V AC electrical outlet.
4. With mixer attachments in place, hold Mixer over container (with ingredients to be blended or mixed).
5. Pull the ON/OFF Button backward. The Mixer's digital display will show the SPEED at "0" and the MIN./SEC. at "0:00".
6. Press the "Increase" Button to begin mixing. See "MIXING GUIDE" for reference.

The Mixer will default to the lowest speed setting ("1") and the timer will begin counting mixing time. Press the "Increase" or "Decrease" Button as desired to suit mixing task. To increase speed, press the "Increase" Button; to decrease speed, press the "Decrease" Button. To advance to a higher or lower speed quickly, simply hold down either button. **NOTE:** With each press of the "Increase" Speed Button, the mixer will advance to the next speed (each successive speed has greater power).

The timer will continue displaying the mixing duration until the ON/OFF button is pushed forward to the "OFF" position or when the mixing time reaches 9 minutes and 59 seconds. (This mixer has a safety feature which will automatically shut the mixer motor off after a total mixing time of 9 minutes and 59 seconds). This is a safety feature which prevents overheating. Push the ON/OFF button forward to turn the mixer off and allow the mixer to "rest" a few minutes then begin mixing again.

7. When mixing task is complete, push the ON/OFF button forward. The digital display will go blank and the motor will stop running. Remove plug from electrical outlet, firmly hold the cord and press in on the Power Supply Cord Retract Button. Allow the Cord to **slowly** retract.
8. Grasp attachments and push down on Eject Button to eject beaters or dough hooks.
9. Clean unit and attachments as instructed in "USER MAINTENANCE INSTRUCTIONS."

Operating Instructions cont.

MIXING GUIDE

Refer to the following mixing guide for speed selections. As you add ingredients, the consistency of the mixture can change. As this happens, it may be desirable to select a higher speed setting.

Speed	Function	Use
1	Knead	Use to knead dough
2-3	Fold	Use to start mixing or for "LOW" mixing recipes
4	Stir	Use to stir liquids or gently moisten dry ingredients
5-6	Blend	Use to blend ingredients or for a stronger knead
7	Mix	Use to combine dry and liquid ingredients alternately
8	Combine	Use to mix/blend all ingredients
9-10	Cake Mix	Use for cake mixes or for "MEDIUM" mixing recipes
11	Cream	Use for creaming sugar and butter together
12	Frostings	Use to prepare light, fluffy frostings or candy
13	Whip	Use to develop a light, fluffy texture
14	Whip Potatoes	Use to mash/whip cooked potatoes
15	Whip Cream	Use to whip cream
16	Egg Whites	Use when whipping egg whites or for "HIGH" mixing recipes

User Maintenance Instructions

This cook's essentials® CEHM16 Hand Mixer requires little maintenance. It contains no user-serviceable parts. Any servicing requiring disassembly must be performed by a qualified appliance repair technician.

CAUTION: *Never immerse Mixer in Water or any other liquid.*

1. Unplug Mixer: Firmly grasp the cord and press in on the Power Supply Cord Retract Button. Allow the Cord to **slowly** retract. If the cord cannot retract fully, pull it out and then retract again.
2. Eject mixer attachments from Mixer and wash attachments in warm water and a mild detergent or in the dishwasher. (Mixer attachments are dishwasher-safe.) Rinse and dry thoroughly.
3. Wipe exterior surface of Mixer with a damp cloth or sponge.
4. Store in its original box in a cool, dry place.

LIMITED ONE YEAR WARRANTY

Warranty: This cook's essentials® product is warranted by the manufacturer to be free from defects in materials or workmanship for a period of (1) year from the original purchase date. This product warranty covers only the original consumer purchaser of the product.

Warranty Coverage: This manufacturer's warranty is void if the product has been damaged by accident in shipment, unreasonable use, misuse, neglect, improper service, commercial use, repairs by unauthorized personnel, normal wear and tear, improper assembly, installation or maintenance abuse or other causes not arising out of defects in materials or workmanship. This warranty is effective only if the product is purchased and operated in the USA, and does not extend to any units which have been used in violation of written instructions furnished with the product or to units which have been altered or modified or to damage to products or parts thereof which have had the serial number removed, altered, defaced or rendered illegible.

Implied Warranties: ANY IMPLIED WARRANTIES WHICH THE PURCHASER MAY HAVE ARE LIMITED IN DURATION TO ONE (1) YEAR FROM THE DATE OF PURCHASE. Some states do not allow limitations on how long an implied warranty lasts, so the above limitation may not apply to you.

Warranty Performance: During the above one-year manufacturer's warranty period, a product with a defect will be either repaired or replaced with a reconditioned comparable model (at our option) when the product is returned to the Repair Center, or the purchase price refunded. The repaired or replacement product will be in warranty for the balance of the one-year warranty period and an additional one-month period. No charge will be made for such repair or replacement.

Service and Repair: Should the appliance malfunction, you should first call toll-free 1 (800) 233-9054 between the hours of 9:00 am and 5:00 pm Central Standard Time and ask for CONSUMER SERVICE stating that you are a consumer with a problem. Please refer to model number when you call.

In-Warranty Service (USA): For an appliance covered under the manufacturer's warranty period, no charge is made for service or postage. Call for return authorization (1 800 233-9054).

Out-of Warranty Service: A flat rate charge by model is made for out-of-warranty service. Include \$8.00 (U.S.) for return shipping and handling. We will notify you by mail of the amount of the charge for service and require you to pay in advance for the repair or replacement.

For Products Purchased in the USA, but Used in Canada: You may return the product insured, packaged with sufficient protection, and postage and insurance prepaid to the USA address listed below. Please note that all customs duty/brokerage fees, if any, must be paid by you and we will require you to pay the cost of customs duty/brokerage fees to us in advance of our performing any service.

Risk During Shipment: We cannot assume responsibility for loss or damage during incoming shipment. For your protection, carefully package the product for shipment and insure it with the carrier. Be sure to enclose the following items with your appliance: any accessories related to your problem, your full return address and daytime phone number, a note describing the problem you experienced, a copy of your sales receipt or other proof of purchase to determine warranty status. C.O.D. shipments cannot be accepted.

To Return the Appliance, ship to:

Attn: Repair Center
708 South Missouri Street
Macon, MO 63552

To Contact us, please write to or call:

Repair Department
P.O. Box 7366
Columbia, MO 65205-7366
1(800) 233-9054

Limitation of Remedies: No representative or person is authorized to assume for the manufacturer any other liability in connection with the sale of our products. There shall be no claims for defects or failure of performance or product failure under any theory of tort, contract or commercial law including, but not limited to negligence, gross negligence, strict liability, breach of warranty and breach of contract. Repair, replacement or refund shall be the sole remedy of the purchaser under this warranty, and **in no event shall the manufacturer be liable for any incidental or consequential damages, losses or expenses.** Some states do not allow the exclusion or limitation of incidental or consequential damages, so the above limitation or exclusion may not apply to you.

Legal Rights: This manufacturer's warranty gives you specific legal rights, and you may also have other rights which vary from state to state.

cook's essentials® is a registered trademark of QVC, Inc.

© 2002

Version 1

P/N 61050

Printed in China 4/02