



Westinghouse

toasterSLICER™



**WST3001W
WST3001BLK**

You can be sure...if it's Westinghouse

IMPORTANT SAFEGUARDS

When using electrical appliances, basic safety precautions should always be followed including the following:

1. Read all instructions.
2. Do not touch hot surfaces. Use handles or knobs
3. To protect against electrical shock do not immerse cord, plugs, or appliance in water or other liquid.
4. Close supervision is necessary when any appliance is used by or near children.
5. Unplug from outlet when not in use, when changing blades, and before cleaning. Allow to cool before putting on or taking off parts.
6. Do not operate any appliance with a damaged cord or plug or after the appliance malfunctions or has been damaged in any manner. Contact Consumer Service for examination, repair or adjustment.
7. The use of accessory attachments not recommended by the appliance manufacturer may cause injuries.
8. Do not use outdoors.
9. Do not let cord hang over edge of table or counter, or touch hot surfaces.
10. Do not place on or near a hot gas or electric burner, or in a heated oven.
11. To disconnect press the CANCEL button, then remove plug from wall outlet.
12. Do not use appliance for other than intended use.
13. Oversize foods, metal foil packages, or utensils must not be inserted in a toaster as they may involve a risk of fire or electric shock.
14. A fire may occur if toasters are covered or touching flammable material, including curtains, draperies, walls, and the like, when operation.
15. Do not attempt to dislodge food when toaster is plugged in.
16. Never feed bagel by hand. Always use pusher.
17. Avoid contacting moving parts.
18. Blades are sharp. Handle carefully. Always handle blades with hand away from cutting edge. Always store blades with cutting edge away from you.

SAVE THESE INSTRUCTIONS
For Household Use Only

ADDITIONAL IMPORTANT SAFEGUARDS

CAUTION HOT SURFACES:

This appliance generates heat and escaping steam during use. Proper precautions must be taken to prevent the risk of burns, fires, or other injury to persons or damage to property.

1. A person who has not read and understood all operating and safety instructions is not qualified to operate this appliance. All users of this appliance must read and understand this Owner's Manual before operating or cleaning this appliance.
2. **Unplug from outlet when not in use and before cleaning. To avoid electric shock, never immerse or rinse this appliance in water or any other liquid.**
3. If this appliance falls or accidentally becomes immersed in water, unplug it from the wall outlet immediately. **Do not reach into the water!** Do not use this appliance after it has fallen into or becomes immersed in water.
4. When using this appliance, provide adequate air space above and on all sides for air circulation. Do not operate this appliance while it is touching or near curtains, wall coverings, clothing, dish towels or other flammable materials.
5. To reduce the risk of fire, do not leave this appliance unattended during use.
6. If this appliance begins to malfunction during use, immediately press the CANCEL button and unplug the cord. Do not use or attempt to repair a malfunctioning appliance!
7. The cord to this appliance should only be plugged into a 120V AC electrical wall outlet.
8. Do not use this appliance in an unstable position.
9. Use the Toaster on a hard, flat surface. Do not place it near a flame or heat or on a soft surface (such as carpet). Avoid placing it where it may tip over during use. Dropping the Toaster could cause it to malfunction. If this appliance begins to malfunction during use, immediately press the CANCEL button and unplug the cord. Do not use or attempt to repair the malfunctioning appliance.
10. Do not use this appliance for other than intended use.
11. Operate the appliance only when the Blade-Release Cap is properly engaged and tightened.
12. Handle the blade carefully when cleaning, removing and inserting, as the Blade is extremely sharp. Do not touch the sharp edge of the Blade. Do not use or install the Blade in any way other than recommended in this manual.

WARNING: ELECTRICAL SHOCK HAZARD.

Never attempt to dislodge food inside the Toaster while the Toaster is plugged in. Doing so could cause an electrical shock hazard or a risk of fire.

CAUTION: This appliance is hot during operation and retains heat for some time after turning off. Always use oven mitts when handling hot materials and allow metal parts to cool before cleaning. Do not place anything on top of the Toaster while it is operating or while it is hot.

CAUTION:

- **DO NOT** toast pastries with runny fillings or frosting.
- **DO NOT** toast torn slices of bread.
- **DO NOT** place buttered bread or wrapped food into the Toaster.
- **DO NOT** toast small-size breads, mini-baguettes, breadsticks, etc.

Polarized Plug

This appliance has a polarized plug (one blade is wider than the other). To reduce the risk of electric shock, this plug is intended to fit into a polarized outlet only one way. If the plug does not fit fully in the outlet, reverse the plug. If it still does not fit, contact a qualified electrician. Do not attempt to modify the plug in any way.

ELECTRIC POWER

If the electrical circuit is overloaded with other appliances, your appliance may not operate properly. It should be operated on a separate electrical circuit from other appliances.

Plasticizer Warning

CAUTION: To prevent Plasticizers to migrate from the finish of the countertop or tabletop or other furniture, place **NON-PLASTIC** coasters or placemats between the appliance and the finish of the countertop or tabletop. **Failure to do so may cause the finish to darken, permanent blemishes may occur or stains can appear**

GETTING TO KNOW YOUR

TOASTERSLICER:

Your **toasterSLICER** has a number of control buttons and several unique features. Please take a moment to acquaint yourself with them:

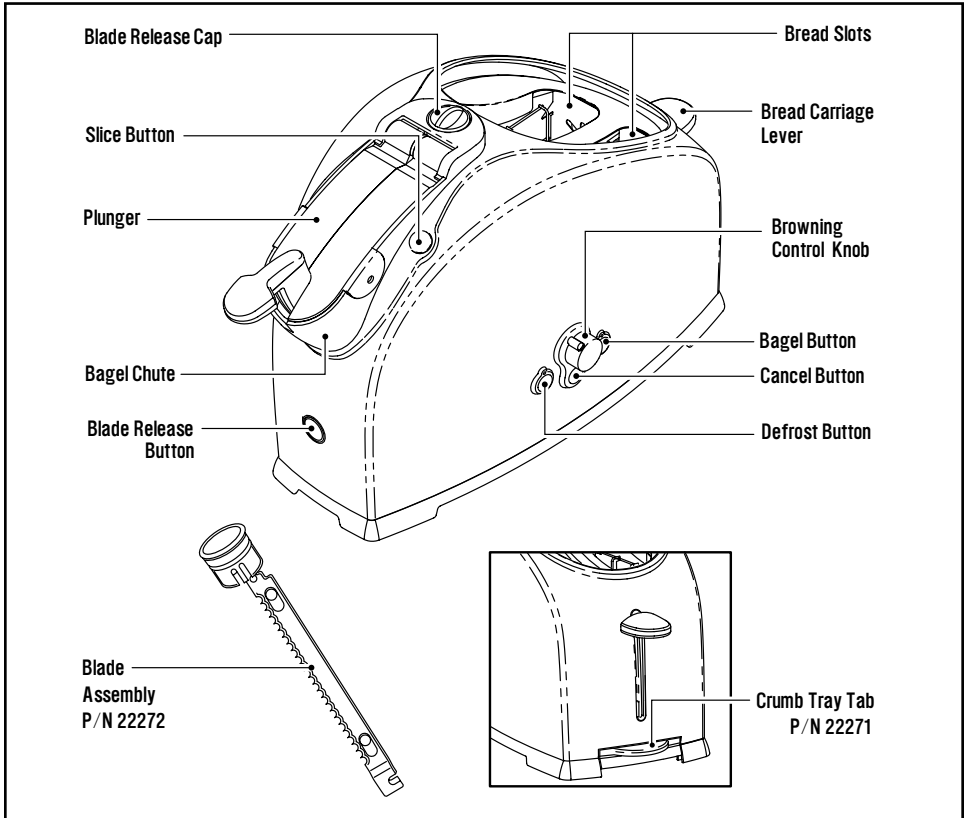

BEFORE FIRST USE:

1. Carefully unpack your **toasterSLICER** and remove all packaging materials.
2. To remove any dust that may have accumulated during packaging, simply wipe the **toasterSLICER** exterior with a clean, damp cloth.
3. Do not use abrasive cleansers.
4. Do not put the **toasterSLICER**, Cord or Plug in water or other liquid.

INSTRUCTIONS FOR USE:

Before using the toaster portion of the **toasterSLICER** for the first time, you should run it through one toasting cycle without any bread inserted. This will remove the "brand new smell" that all heating elements emit the first time they are used.

Place the unit on a sturdy, dry surface and plug the power cord into a standard, 120-volt electrical outlet. Turn the browning control knob clockwise to its maximum setting and depress the bread carriage lever. Make sure the room is well ventilated during this process. (This is simply to allow the smell to dissipate more quickly - there is nothing harmful about the odor.) After the toasting cycle is complete and the lever pops up, you will be ready to use your **toasterSLICER**.

To toast bread:

- 1) Select the desired level of browning with the browning control knob. The browning level increases as you turn the knob clockwise.
- 2) Place your bread in the bread slot.
- 3) Press the bread carriage lever down until it locks into place.
- 4) When the set degree of browning has been reached, the bread carriage lever will automatically pop up.
- 5) Remove the bread.

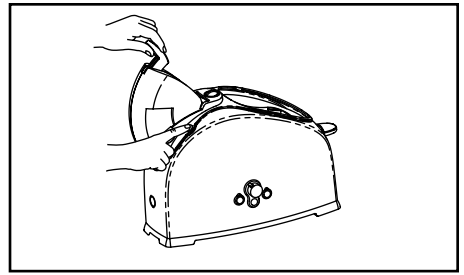

- 4) When slicing is complete, release the **SLICE** button to deactivate the cutting blade.
- 5) To deposit the sliced bagel into the **toasterSLICER's** bread slots, simply push down on the plunger until it is in the fully depressed position.

To slice and toast bagels:

(Note: Slicing frozen bagels is not recommended. It increases blade wear significantly.)

- 1) Lift the plunger and insert an unsliced bagel into the bagel chamber.
- 2) Depress the plunger until the bagel comes

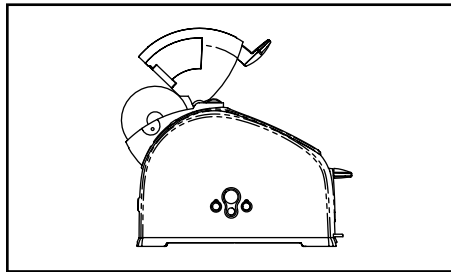
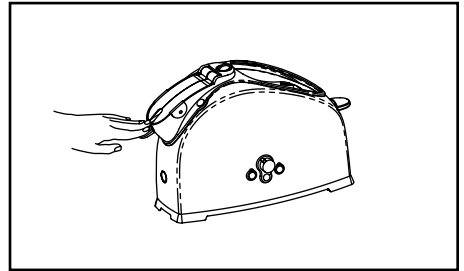

- in contact with the inside cutting blade.
- 3) Depress the **SLICE** button with your index finger.

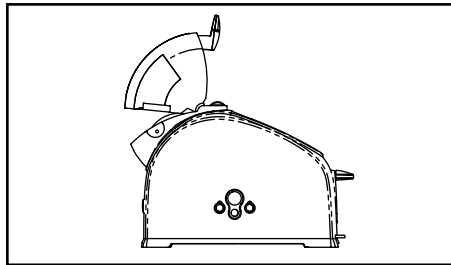

- 6) Select the desired level of browning with the browning control knob.
- 7) Press the carriage lever down until it locks into place.
- 8) Press the **Bagel** button and the LED light will illuminate.
- 9) When the set degree of browning has been reached, the bread carriage lever will automatically pop up.
- 10) Remove the bagel.

This activates the cutting blade. While keeping the **SLICE** button depressed, push down gently but firmly on the plunger with your other hand. The plunger will guide the bagel into contact with the cutting blade. For safety purposes, the slicing knife will only operate once the plunger comes into contact with the bagel chamber. (Note: Slicing will be completed before the plunger is fully depressed.)

FEATURES AND CONTROLS:

Browning Control Knob

- The required toasting time of the bread or bagel will vary depending on the type, thickness and freshness of the bread. Bagels and thicker breads require longer toasting times, as do breads with higher moisture content.
- When toasting only one piece of bread, the **browning control knob** should be set to a slightly lower setting.
- If you are re-toasting a slice of bread, set the **browning control knob** to a low (light) setting.

Cancel button

- Press the **CANCEL** button at any time to stop the toasting cycle immediately. The bread carriage lever will return to its starting position and you can then remove the bread.

Defrost button

- To toast frozen bread or other frozen items (waffles, etc.), press the **DEFROST** button after the bread carriage lever has been locked down. The button's LED light will illuminate and the toasting cycle will automatically be extended.

Bagel button

When toasting bagels, press the **BAGEL** button after you depress the bread carriage lever. When placing pre-cut bagels or English muffins in toaster, make sure cut sides are facing in.

GENERAL TOASTING & SAFETY HINTS:

- In order to achieve uniform browning, it is best to wait a minimum of 30 seconds between each toasting cycle.
- Fresh bread takes longer to toast than slightly stale bread; adjust the **browning control knob** accordingly.
- When toasting two slices of bread at once, it is recommended that they be of equal size and freshness.
- Your **toasterSLICER** can be used to toast any foods designed for use in a toaster (bread, bagels, frozen waffles, tea cakes, toaster muffins, etc.). However, do not use items that are wider than the bread slots can accommodate.
- If oversized bread has somehow jammed the bread carriage lever in the down position, unplug the toaster and allow the bread to cool before attempting to remove the bread. **Never insert your hands or any utensils into the bread slots of the toasterSLICER.**

CARE AND CLEANING:

The **toasterSLICER** has a crumb tray that will collect crumbs from both the toasting chamber and the slicing area. It should be emptied and cleaned periodically. Before emptying the crumb tray, always unplug the **toasterSLICER** and wait for it to cool down completely. Tap the sides of the unit lightly to dislodge any crumbs in the bread slots. Then remove the crumb tray by pulling the tab on the side of the unit.

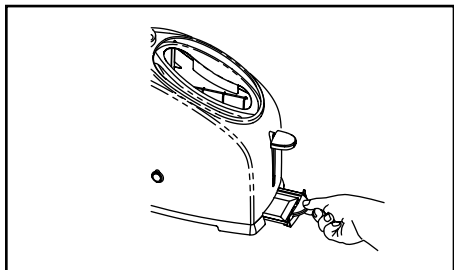

Empty crumbs into the garbage and wash the crumb tray gently in warm, soapy water. Dry the tray thoroughly before reinstalling it in the **toasterSLICER**. **NEVER** operate the **toasterSLICER** without the crumb tray, or if the crumb tray is wet.

To remove the cutting blade for cleaning, press the **BLADE RELEASE** button located below the plunger, and turn the blade release cap 90 degrees. Then pull up on the blade release cap to with-draw the blade.

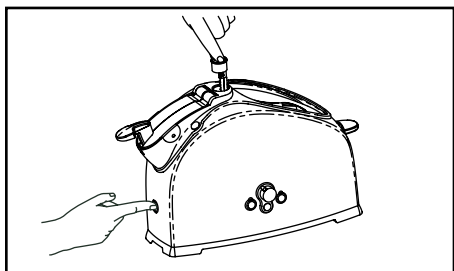

Wash the cutting blade in warm soapy water, and **dry it thoroughly** before re-inserting it in the **toasterSLICER**. **Never** operate the **toasterSLICER** with a wet cutting blade.

After cleaning, simply grasp the blade release

cap and re-*insert the blade into the top of the **toasterSLICER**, making sure the cutting edge is facing the plunger. You will feel the blade click into place when it is aligned properly. It is not necessary to use the blade release button when re-inserting the cutting blade. **Handle the cutting blade carefully - it is sharp.**

Always make sure the **toasterSLICER** is unplugged and completely cooled before cleaning the outside of the unit. Wipe the outside of the **toasterSLICER** with a damp cloth and dry it with a dry cloth or paper towel.

- **NEVER** immerse the **toasterSLICER** in water.
- **NEVER** use sharp objects to scrape or clean the inside of the **toasterSLICER**.
- **NEVER** insert your fingers or any utensils into the bread slots.
- **Blades are sharp. Handle carefully. Always handle blades with hand away from cutting edge. Always store blades with cutting edge away from you.**

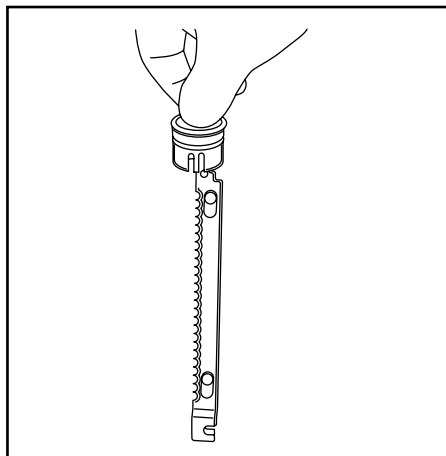

LIMITED ONE YEAR WARRANTY

Warranty: This Westinghouse® • product is warranted by Salton, Inc. to be free from defects in materials or workmanship for a period of (1) year from the original purchase date. This product warranty covers only the original consumer purchaser of the product.

Warranty Coverage: This warranty is void if the product has been damaged by accident in shipment, unreasonable use, misuse, neglect, improper service, commercial use, repairs by unauthorized personnel, normal wear and tear, improper assembly, installation or maintenance abuse or other causes not arising out of defects in materials or workmanship. This warranty is effective only if the product is purchased and operated in the USA, and does not extend to any units which have been used in violation of written instructions furnished with the product or to units which have been altered or modified or to damage to products or parts thereof which have had the serial number removed, altered, defaced or rendered illegible.

Implied Warranties: ANY IMPLIED WARRANTIES WHICH THE PURCHASER MAY HAVE ARE LIMITED IN DURATION TO ONE (1) YEAR FROM THE DATE OF PURCHASE. Some states do not allow limitations on how long an implied warranty lasts, so the above limitation may not apply to you.

Warranty Performance: During the above one-year warranty period, a product with a defect will be either repaired or replaced with a reconditioned comparable model (at our option) when the product is returned to the Repair Center, or the purchase price refunded. The repaired or replacement product will be in warranty for the balance of the one-year warranty period and an additional one-month period. No charge will be made for such repair or replacement.

Service and Repair: Should the appliance malfunction, you should first call toll-free 1 (800) 934-7455 between the hours of 9:00 am and 5:00 pm Central Standard Time and ask for CONSUMER SERVICE stating that you are a consumer with a problem. Please refer to model number WST2000BLK when you call.

In-Warranty Service (USA): For an appliance covered under the warranty period, no charge is made for service or postage. Call for return authorization (1 800 934-7455).

Out-of-Warranty Service: A flat rate charge by model is made for out-of-warranty service. Include \$12.00 (U.S.) for return shipping and handling. We will notify you by mail of the amount of the charge for service and require you to pay in advance for the repair or replacement.

For Products Purchased in the USA, but Used in Canada: You may return the product insured, packaged with sufficient protection, and postage and insurance prepaid to the USA address listed below. Please note that all customs duty / brokerage fees, if any, must be paid by you and we will require you to pay the cost of customs duty / brokerage fees to us in advance of our performing any service.

Risk During Shipment: We cannot assume responsibility for loss or damage during incoming shipment. For your protection, carefully package the product for shipment and insure it with the carrier. Be sure to enclose the following items with your appliance: any accessories related to your problem, your full return address and daytime phone number, a note describing the problem you experienced, a copy of your sales receipt or other proof of purchase to determine warranty status. C.O.D. shipments cannot be accepted.

To return the appliance, ship to:

Attn: Repair Center
Salton, Inc.
708 South Missouri Street
Macon, MO 63552

To contact us, please write to, call, or email:

Salton, Inc.
P.O. Box 6916
Columbia, MO 65205-1637
1(800) 934-7455
Email: Salton@Saltonusa.com

Limitation of Remedies: No representative or person is authorized to assume for Salton, Inc. any other liability in connection with the sale of our products. There shall be no claims for defects or failure of performance or product failure under any theory of tort, contract or commercial law including, but not limited to negligence, gross negligence, strict liability, breach of warranty and breach of contract. Repair, replacement or refund shall be the sole remedy of the purchaser under this warranty, and in no event shall Salton be liable for any incidental or consequential damages, losses or expenses. Some states do not allow the exclusion or limitation of incidental or consequential damages, so the above limitation or exclusion may not apply to you.

Legal Rights: This warranty gives you specific legal rights, and you may also have other rights which vary from state to state.

WESTINGHOUSE™,  and "YOU CAN BE SURE...IF IT'S WESTINGHOUSE™" are trademarks of WESTINGHOUSE ELECTRIC CORPORATION and used under license by Salton, Inc.

For more information on Salton products: Visit our website: www.eSalton.com

NOTES

[illegible]

LIMITED ONE YEAR WARRANTY

Warranty: This Westinghouse® • product is warranted by Salton, Inc. to be free from defects in materials or workmanship for a period of (1) year from the original purchase date. This product warranty covers only the original consumer purchaser of the product.

Warranty Coverage: This warranty is void if the product has been damaged by accident in shipment, unreasonable use, misuse, neglect, improper service, commercial use, repairs by unauthorized personnel, normal wear and tear, improper assembly, installation or maintenance abuse or other causes not arising out of defects in materials or workmanship. This warranty is effective only if the product is purchased and operated in the USA, and does not extend to any units which have been used in violation of written instructions furnished with the product or to units which have been altered or modified or to damage to products or parts thereof which have had the serial number removed, altered, defaced or rendered illegible.

Implied Warranties: ANY IMPLIED WARRANTIES WHICH THE PURCHASER MAY HAVE ARE LIMITED IN DURATION TO ONE (1) YEAR FROM THE DATE OF PURCHASE. Some states do not allow limitations on how long an implied warranty lasts, so the above limitation may not apply to you.

Warranty Performance: During the above one-year warranty period, a product with a defect will be either repaired or replaced with a reconditioned comparable model (at our option) when the product is returned to the Repair Center, or the purchase price refunded. The repaired or replacement product will be in warranty for the balance of the one-year warranty period and an additional one-month period. No charge will be made for such repair or replacement.

Service and Repair: Should the appliance malfunction, you should first call toll-free 1 (800) 934-7455 between the hours of 9:00 am and 5:00 pm Central Standard Time and ask for CONSUMER SERVICE stating that you are a consumer with a problem. Please refer to model number WST2000BLK when you call.

In-Warranty Service (USA): For an appliance covered under the warranty period, no charge is made for service or postage. Call for return authorization (1 800 934-7455).

Out-of-Warranty Service: A flat rate charge by model is made for out-of-warranty service. Include \$12.00 (U.S.) for return shipping and handling. We will notify you by mail of the amount of the charge for service and require you to pay in advance for the repair or replacement.

For Products Purchased in the USA, but Used in Canada: You may return the product insured, packaged with sufficient protection, and postage and insurance prepaid to the USA address listed below. Please note that all customs duty / brokerage fees, if any, must be paid by you and we will require you to pay the cost of customs duty / brokerage fees to us in advance of our performing any service.

Risk During Shipment: We cannot assume responsibility for loss or damage during incoming shipment. For your protection, carefully package the product for shipment and insure it with the carrier. Be sure to enclose the following items with your appliance: any accessories related to your problem, your full return address and daytime phone number, a note describing the problem you experienced, a copy of your sales receipt or other proof of purchase to determine warranty status. C.O.D. shipments cannot be accepted.

To return the appliance, ship to:

Attn: Repair Center
Salton, Inc.
708 South Missouri Street
Macon, MO 63552

To contact us, please write to, call, or email:

Salton, Inc.
P.O. Box 6916
Columbia, MO 65205-1637
1(800) 934-7455
Email: Salton@Saltonusa.com

Limitation of Remedies: No representative or person is authorized to assume for Salton, Inc. any other liability in connection with the sale of our products. There shall be no claims for defects or failure of performance or product failure under any theory of tort, contract or commercial law including, but not limited to negligence, gross negligence, strict liability, breach of warranty and breach of contract. Repair, replacement or refund shall be the sole remedy of the purchaser under this warranty, and in no event shall Salton be liable for any incidental or consequential damages, losses or expenses. Some states do not allow the exclusion or limitation of incidental or consequential damages, so the above limitation or exclusion may not apply to you.

Legal Rights: This warranty gives you specific legal rights, and you may also have other rights which vary from state to state.

WESTINGHOUSE™,  and "YOU CAN BE SURE...IF IT'S WESTINGHOUSE™" are trademarks of WESTINGHOUSE ELECTRIC CORPORATION and used under license by Salton, Inc.

For more information on Salton products: Visit our website: www.eSalton.com