

White-Westinghouse™

Iced Tea/ Iced Coffee Maker

OWNER'S MANUAL

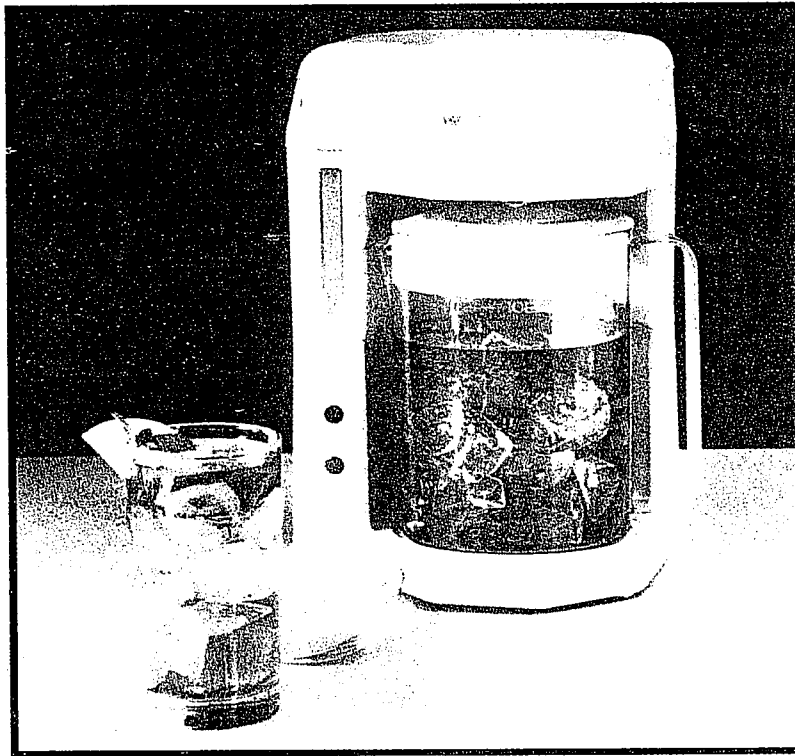

MODEL WWTCM4

IMPORTANT SAFETY INSTRUCTIONS

When using electrical appliances, basic safety precautions should always be followed, including the following:

- 1. READ ALL INSTRUCTIONS BEFORE USING.**
2. Do not touch hot surfaces. Use handles or knobs.
3. To protect against fire, electric shock, and injury to persons, do not immerse cord, plugs, or appliance in water or other liquid.
4. Close supervision is necessary when any appliance is used by or near children.
5. Unplug from outlet when not in use and before cleaning. Allow to cool before putting on or taking off parts and before cleaning the appliance.
6. Do not operate any appliance with a damaged cord or plug, or after the appliance malfunctions or has been damaged in any manner. Contact Consumer Service.
7. The use of accessory attachments not recommended by the appliance manufacturer may result in fire, electric shock or injury to persons.
8. Do not use outdoors.
9. Do not let cord hang over edge of table or counter, or touch hot surfaces.
10. Do not place on or near hot gas or electric burner, or in a heated oven.
11. Do not use appliance for other than intended use.
12. Be certain Lids are securely in place before operating appliance.
13. Scalding may occur if the Lid is removed during the brewing cycle.
14. The Carafe is designed for use with this appliance. It must never be used on a range top.
15. Do not set a hot Carafe on a wet or cold surface.
16. Do not use a cracked Carafe or a Carafe with a loose or weakened Handle.
17. Do not clean Carafe with cleansers, steel wool pads or other abrasive materials.
18. Do not use Carafe in a microwave oven.

SAVE THESE INSTRUCTIONS
THIS APPLIANCE IS FOR HOUSEHOLD USE ONLY

This appliance may be plugged into any 120-volt AC electrical outlet (ordinary household current). Do not use any other electrical outlet.

POLARIZED PLUG

This appliance has a polarized plug (one blade is wider than the other): To reduce the risk of electric shock, this plug is intended to fit into a polarized outlet only one way. If the plug does not fit fully in the outlet, reverse the plug. If it still does not fit, contact a qualified electrician. Do not attempt to modify the plug in any way.

SHORT CORD INSTRUCTIONS

A short power-supply cord is provided to reduce the risk resulting from becoming entangled in or tripping over a longer cord.

Longer power-supply cords or extension cords are available and may be used if care is exercised in their use.

If a longer power-supply cord or extension cord is used, (1) the marked electrical rating of the extension cord should be at least as great as the electrical rating of the appliance, and (2) the longer cord should be arranged so that it will not drape over the counter top or table top where it can be pulled on by children or tripped over unintentionally.

OPERATING INSTRUCTIONS

PRODUCT MAY VARY SLIGHTLY FROM ILLUSTRATIONS

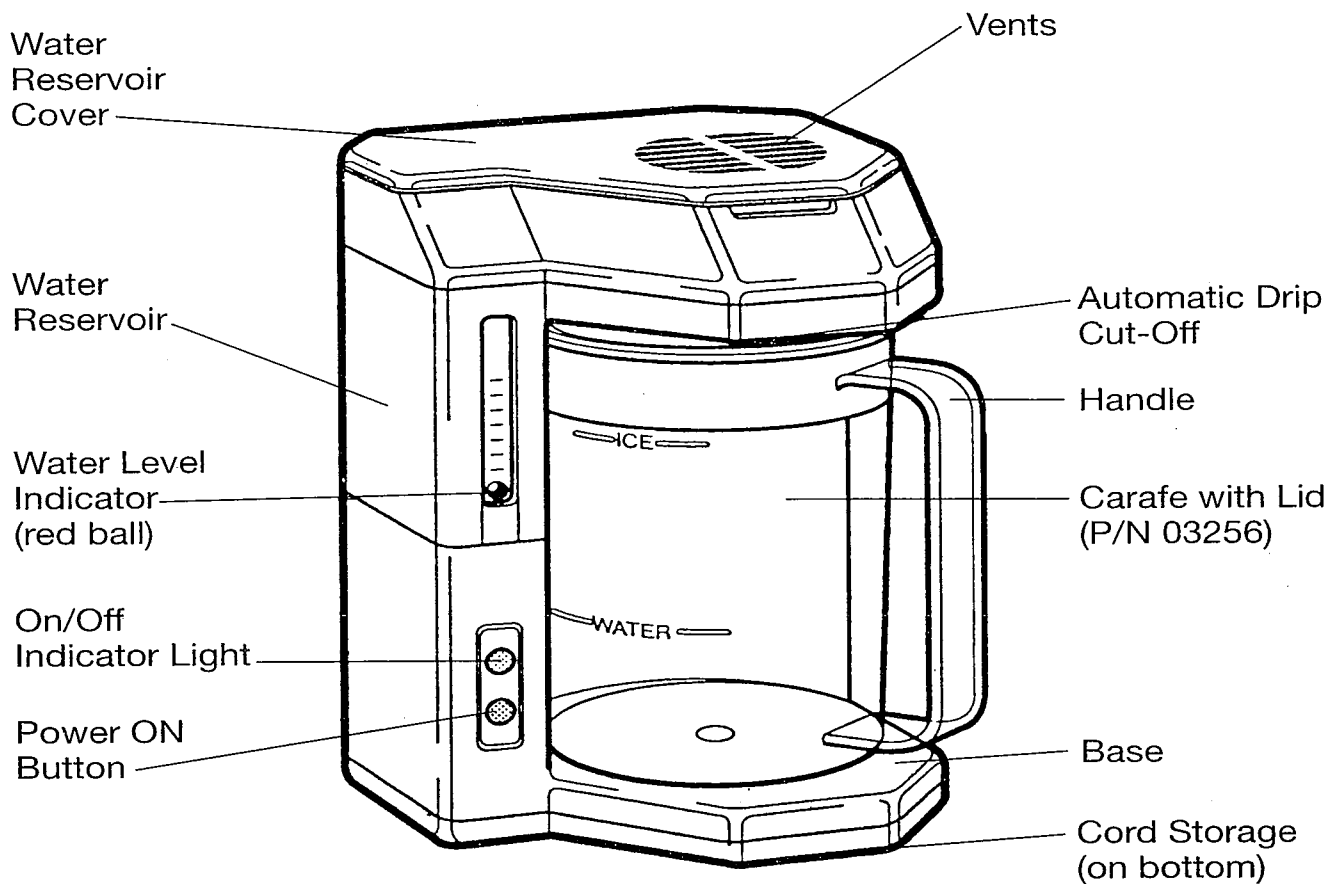

FILTER ASSEMBLY

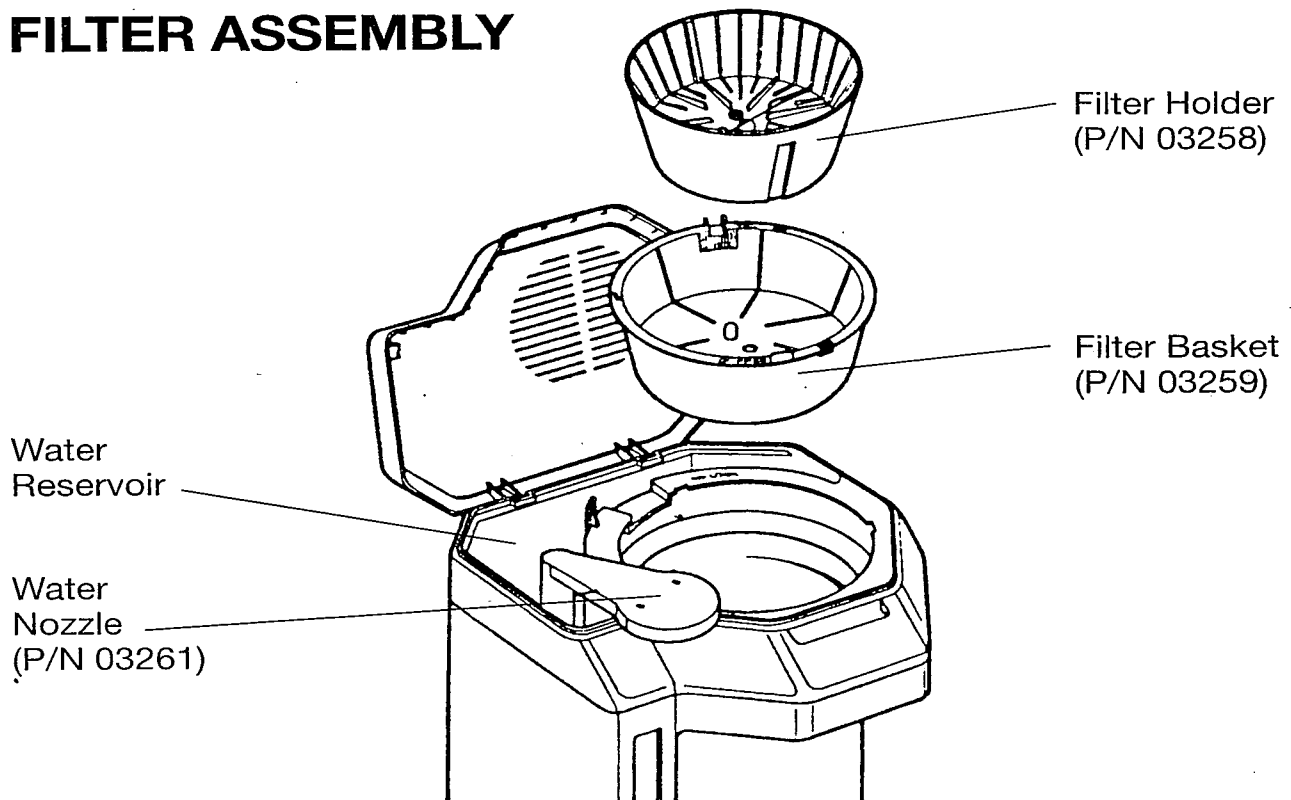

FILTER PLACEMENT

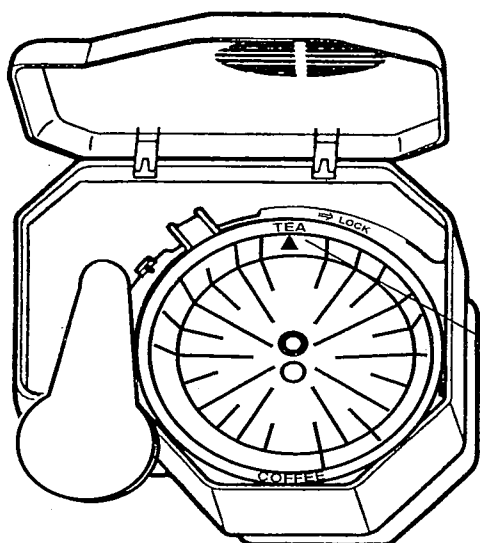

ICED TEA

To make iced tea, turn the Filter Holder so that the little button in the Filter Holder fits in the hole on the bottom of the Filter Basket and the arrow points to "TEA." The tea has to steep before pouring into the Carafe.

The arrow points to "TEA"

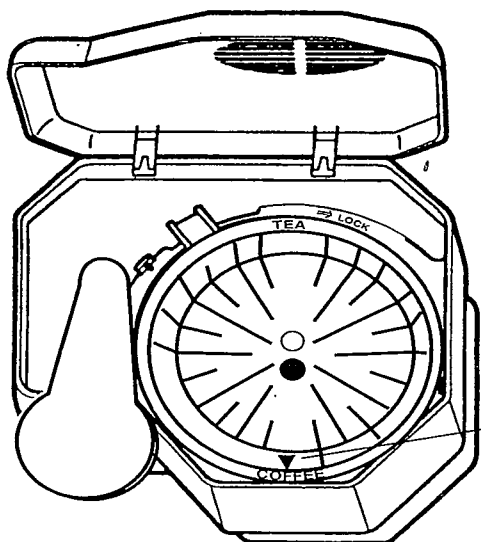

ICED COFFEE

To make iced coffee, turn the Filter Holder so that the arrow points to "COFFEE" and so that the coffee can pour straight through both holes into the Carafe.

The arrow points to "COFFEE"

BEFORE FIRST USE

Become familiar with the Iced Tea/Iced Coffee Maker parts. Read all instructions carefully. Check the Carafe to make sure that it is empty. Remove any literature.

Wash the Carafe, Lid, Filter Basket and Filter Holder in warm, soapy water, rinse well and dry thoroughly. Wipe unit with a soft cloth or sponge. Never immerse unit or cord in water or other liquid. Now, fill Carafe to the "WATER" Line with cold water, lift the Water Reservoir Cover and pour the water into the Water Reservoir. Close Water Reservoir Cover. Place Carafe with Lid over the Base, making sure the Automatic Drip Cut-Off is properly engaged with the Lid.

Plug unit into electrical outlet and press Power ON Button. The On/Off Indicator Light will illuminate. Allow water to cycle through once or twice without coffee or tea. This will clean the Water Reservoir, Filter Basket and Filter Holder prior to initial use.

DIRECTIONS FOR MAKING AUTOMATIC ICED TEA/ICED COFFEE

1. Lift the Cover of the Water Reservoir; pour in cold, clean water to the desired level...the water level is shown by the Red Ball in the Water Level Indicator.

2. Turn Water Nozzle aside so that the Filter Holder can be assembled.

3. **To make iced tea**, turn the Filter Holder so that the little button in the Filter Holder fits in the hole on the bottom of the Filter Basket and the arrow points to "TEA."
(See illustration on the previous page.)
The tea has to steep before pouring into the Carafe.

Use 2-3 tea bags to make one full Carafe.

4. **To make iced coffee**, turn the Filter Holder so that the arrow points to "COFFEE" and so that the coffee can pour straight through both holes into the Carafe.
(See illustration on the previous page.)

Use 4-6 rounded teaspoons of fresh ground coffee to make one full Carafe.

5. **ALWAYS USE A PAPER OR MESH FILTER, 8-12 cups, basket style.** After using the Iced Tea/Iced Coffee Maker several times, the amount of tea bags or coffee used can be adjusted to taste.

6. Fill the Carafe with ice cubes to the Ice Marker Line.

7. Be sure the Carafe is sitting in the proper position, making sure the Automatic Drip Cut-Off is properly engaged with the Lid. Turn Water Nozzle over the Filter Holder and close the Water Reservoir Cover.

8. Plug in the appliance and switch the machine on by pressing the red Power ON Button.

9. The On/Off Indicator Light will illuminate and the water will start to filter through the machine, into the Carafe. This unit is equipped with an Automatic Drip Cut-Off that operates automatically when the Carafe is removed or inserted into the unit. When the coffee or tea has finished brewing, the appliance will automatically shut off.

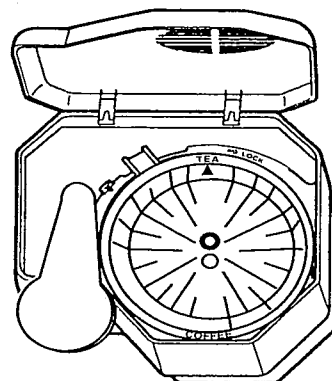

Turn Water Nozzle aside so that the Filter Holder can be assembled.

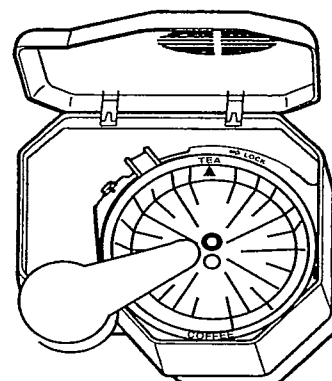

Turn Water Nozzle back into position, so that it sits over the Filter Holder.

AUTOMATIC DRIP CUT-OFF

After approximately 2 cups of iced tea or iced coffee have dripped into the Carafe, the Carafe may be removed and the coffee or tea will stop dripping. The Cut-Off is located on the bottom of the Filter Basket and is activated when the Carafe is removed. This design makes it possible to remove the Carafe and pour a cup of iced tea or iced coffee before the entire Carafe is brewed. Make sure that at least 2 cups of coffee or tea has dripped into the Carafe before removing it. The Carafe should be placed back onto the Base immediately after pouring a cup of tea or coffee so that the brew process can resume.

FOR BEST RESULTS

Always use fresh, cold water.

Freshly ground coffee is very important. It is recommended that beans be ground just before making coffee. Freshly ground beans will give more flavor and aroma. Coffee beans can be stored in the freezer and ground while still frozen.

For best results, use only medium-fine ground coffee in this appliance.

RECIPES

In addition to iced tea or iced coffee made from the standard supermarket tea or coffee blends, the White-Westinghouse™ Iced Tea/Iced Coffee Maker works equally well with your favorite gourmet teas and coffees. As measurements for making specialty brews may differ, it may be necessary to experiment a bit with the amounts used to create a brew sufficiently strong enough to retain its gourmet flavor when ice cubes are added. To enhance a special brew even more, try some of the recipes that follow.

Spiced Coffee

1/2 cup medium-bodied coffee
1/4 teaspoon ground cinnamon
1/8 teaspoon (scant) freshly ground nutmeg
3 cups cold water

Place a new filter in the Filter Holder. Add ground coffee. Sprinkle cinnamon and nutmeg over the top before brewing. Pour into tall glasses containing additional ice cubes and serve immediately. Add sugar and cream to taste.

Serves 4.

Spiced Coffee A La Mode

Follow directions for making Spiced Coffee and pour into glasses, being careful not to overfill them. Add a scoop of vanilla or coffee ice cream, garnish with whipped cream and a sprinkle of cinnamon-nutmeg mixture.

Mocharoca

1/2 cup ground Mocha coffee
3 cups cold water
1/8 teaspoon ground cardamom
Several grinds nutmeg

Place a new filter in the Filter Holder. Add ground coffee. Top with cardamom and nutmeg. Brew coffee, pour into tall glasses containing additional ice cubes, if desired, and serve immediately. Add sugar and cream to taste. For a festive touch, garnish with a spoonful of whipped cream and shaved chocolate.

Serves 4.

Tropicalicious Tea

4-5 teabags or 1-1/2 to 2 tablespoons loose tea

3-4 cups water

8-10 whole cloves

1 cinnamon stick (2 inches)

1/3 cup granulated sugar

1/2 cup orange juice

4 to 5 tablespoons lemon juice

Thin orange slices, for garnish

Place a new filter in the Filter Holder. Place tea, cloves and cinnamon in filter and allow to brew. While tea is brewing, combine orange juice, lemon juice and sugar. When tea has finished brewing, add sugar, orange and lemon juice mixture to carafe. Let tea stand for a few minutes. Pour over ice into glasses and add orange slices for garnish.

Serves 4.

Chocaholics' Tea

4 tablespoons loose orange pekoe tea

3-4 cups cold water

2 to 2-1/2 teaspoons unsweetened cocoa powder

2 to 2-1/2 teaspoons brown sugar

1/2 teaspoon grated orange peel

3/4 cup sweetened whipped cream

1 tablespoon grated dark chocolate

Place a new filter in the Filter Holder. Brew tea in Filter Holder. Add cocoa, brown sugar and orange peel to Carafe, stir thoroughly and let mixture steep for 30 minutes. Add ice to tall glasses and pour. Top with whipped cream and a sprinkling of chocolate on the whipped cream.

Serves 4.

NOTE: When making specialty teas, a filter must be used. For best results, allow the tea to steep for a while to enhance the flavor before adding ice.

USER MAINTENANCE INSTRUCTIONS

This appliance requires little maintenance. **To reduce the risk of electric shock, do not open or remove bottom Cover of unit.** It contains no user serviceable parts. Do not try to repair it yourself. Refer it to qualified personnel if servicing is needed.

CAUTION: Allow the machine to cool down before adding more water to the Water Reservoir or before cleaning.

DO NOT IMMERSE UNIT IN WATER OR ANY OTHER LIQUID!!!

Use only cold water to fill the Water Reservoir. Never use warm or hot water. Never use any liquid other than water.

TO CLEAN: Always unplug the appliance before cleaning.

The Carafe, Lid, Filter and Filter Holder may be washed in warm, soapy water. The unit can be wiped clean with a soft, slightly damp cloth. Never use abrasive scouring pads or cleansers. **Never immerse unit in water or any other liquid.**

At least once a month, follow the instructions for Decalcifying.

The inside of the Water Reservoir should occasionally be rinsed out with clean, cold water. Never clean with a cloth, as this can leave lint.

DECALCIFYING

Any appliance used for boiling water will inevitably become calcified in areas where the water contains lime. It may therefore be necessary to decalcify the appliance from time to time; for example, when the filtering process takes noticeably longer than usual.

INSTRUCTIONS FOR DECALCIFYING

1. Add 4 teaspoons plain white distilled vinegar (containing 3% acetic acid) to 2 cups of water.
2. Pour the vinegar/water solution into the Water Reservoir. (This will allow the vinegar/water solution to run through the machine as though preparing coffee, but without the coffee.) Plug in the appliance and press the Power ON Button.
3. Repeat this operation two or three more times, depending on the degree of calcification.
4. Now fill the appliance with fresh cold water (omit vinegar), and press the Power ON Button. Allow the water to circulate through the machine in the same way as described for the vinegar water solution. Repeat the plain water operation 2-3 times to make sure that the machine is clean and free of any vinegar taste.

TO STORE

Unplug unit; store in its box in a clean, dry place. Never store it while it is hot or still plugged in. **Never wrap cord tightly around the appliance.** Do not put any stress on the cord where it enters the unit, as it could cause the cord to fray and break. The power cord may be wound loosely around the cord storage area on the bottom of the unit.

ONE-YEAR LIMITED WARRANTY

This White-Westinghouse product warranty extends to the original consumer purchaser of the product.

Warranty Duration: This product is warranted to the original consumer purchaser for a period of one (1) year from the original purchase date.

Warranty Coverage: This product is warranted against defective materials or workmanship. This warranty is void if the product has been damaged by accident, in shipment, unreasonable use, misuse, neglect, improper service, commercial use, repairs by unauthorized personnel or other causes not arising out of defects in materials or workmanship. This warranty is effective only if the product is purchased and operated in the USA, and does not extend to any units which have been used in violation of written instructions furnished, or to units which have been altered or modified or to damage to products or parts thereof which have had the serial number removed, altered, defaced or rendered illegible.

Warranty Disclaimers: This warranty is in lieu of all warranties expressed or implied, and no representative or person is authorized to assume any other liability in connection with the sale of our products. There shall be no claims for defects or failure of performance or product failure under any theory of tort, contract or commercial law including, but not limited to, negligence, gross negligence, strict liability, breach of warranty and breach of contract.

Warranty Performance: During the above one-year warranty period, a product with a defect will be either repaired or replaced with a comparable model (at the store's option) when the product is returned to Kmart. The repaired or replacement product will be in warranty for the balance of the one-year warranty period and an additional one-month period. No charge will be made for such repair or replacement.

Important Notice

If any parts are missing or defective, return this product to the place of purchase.

Consumer Service

This White-Westinghouse product is distributed by:
Salton, Inc.

708 South Missouri St.

Macon, MO 63552-1343

Any questions or comments can be directed to Salton's address, or call the Consumer Service Department:

1-800-233-9054

Monday-Friday

8 a.m. - 5 p.m. CST

White-Westinghouse trademark used under license.

©2001 White Consolidated Industries, Inc.

Made in China for
Kmart Corporation
Troy, Michigan 48084

Printed in China

P/N 60657