



Westinghouse

saladXPRESS™

slice, grate, wash, dry & serve salad™



WST2020

You can be sure...if it's Westinghouse

IMPORTANT SAFEGUARDS

When using electrical appliances, basic safety precautions should always be followed including the following:

1. Read all instructions.
2. To protect against risk of electrical shock do not put cord, plugs, or appliance in water or other liquid.
3. Close supervision is necessary when any appliance is used by or near children.
4. Unplug from outlet when not in use, before putting on or taking off parts, and before cleaning.
5. Avoid contacting moving parts. Keep fingers out of discharge opening.
6. Do not operate any appliance with a damaged cord or plug or after the appliance malfunctions, or is dropped or damaged in any manner. Contact Consumer Service.
7. The use of attachments not recommended or sold by the manufacturer may cause fire, electric shock or injury.
8. Do not use outdoors.
9. Do not let cord hang over edge of table or counter.
10. Do not let cord contact hot surface, including the stove.
11. Never feed food by hand. Always use food plunger.
12. Blades are sharp. Handle carefully.
13. Keep hands and utensils away from moving blades or disc while processing food to reduce risk of severe injury to persons or damage to the food processor. A scraper may be used but must only be used only when the food processor is not running.
14. To reduce the risk of injury. Never place cutting blade or disc on base without first putting bowl properly in place.
15. Be certain cover is locked in place before operating appliance.
16. Do not attempt to defeat the safety latch mechanism.

**SAVE THESE INSTRUCTIONS
FOR HOUSEHOLD USE ONLY**

ADDITIONAL IMPORTANT SAFEGUARDS

1. All users of this appliance must read and understand this Owner's Manual before operating or cleaning this appliance.
2. The cord to this appliance should be plugged into a 120V AC electrical outlet only.
3. Do not leave this appliance unattended during use.
4. If this appliance begins to malfunction during use, immediately turn the unit OFF and unplug the cord. Do not use or attempt to repair the malfunctioning appliance.
5. If this appliance falls or accidentally becomes immersed in water, unplug it immediately. Do not reach into the water! Do not use this appliance after it has fallen into or becomes immersed in water.
6. To reduce the risk of injury to persons or property, never use this appliance in an unstable position.
7. Do not use this appliance for other than its intended use.

POLARIZED PLUG

This appliance has a polarized plug (one blade is wider than the other). To reduce the risk of electric shock, this plug is intended to fit into a polarized outlet only one way. If the plug does not fit fully in the outlet, reverse the plug. If it still does not fit, contact a qualified electrician. Do not attempt to modify the plug in any way.

SHORT CORD INSTRUCTIONS

A short power-supply cord is provided to reduce the risk resulting from becoming entangled in or tripping over a longer cord. Longer detachable power-supply cords or extension cords are available and may be used if care is exercised in their use. If a longer detachable power-supply cord or extension cord is used, (1) the marked electrical rating of the cord set or extension cord should be at least as great as the electrical rating of the appliance, and (2) the cord should be arranged so that it will not drape over the countertop or tabletop where it can be pulled on by children or tripped over unintentionally.

ELECTRIC POWER

If the electrical circuit is overloaded with other appliances, your appliance may not operate properly. It should be operated on a separate electrical circuit from other appliances

INTRODUCTION:

Congratulations on your purchase of the **Westinghouse saladXPRESS**, the world's first electric appliance that allows you to slice, chop, wash, dry and serve salad. In just a few easy steps, you can now create delicious and exciting salads from start to finish.

The **saladXPRESS** comes with two stainless steel cutting discs. The grating disc allows you to easily and efficiently shred vegetables such as cabbage, carrots, radishes and chili peppers. It can even be used to grate cheese or chop nuts. Switch to the slicing disc and you have the perfect tool for slicing vegetables, meat, fruit or hard boiled eggs. The **saladXPRESS** will even spin-dry your leafy greens at the touch of a button.

Whether you want to shred vegetables for cole slaw, slice fruit for torte toppings, crumble cookies for crusts, or grate cheese for pizza, the **saladXPRESS** provides you with a powerful and versatile new kitchen appliance to make food preparation exciting and easy.

Getting to know your Westinghouse WST2020 saladEXPRESS

The box containing your Westinghouse saladEXPRESS should include the following parts. If any of the following are missing, contact consumer service:

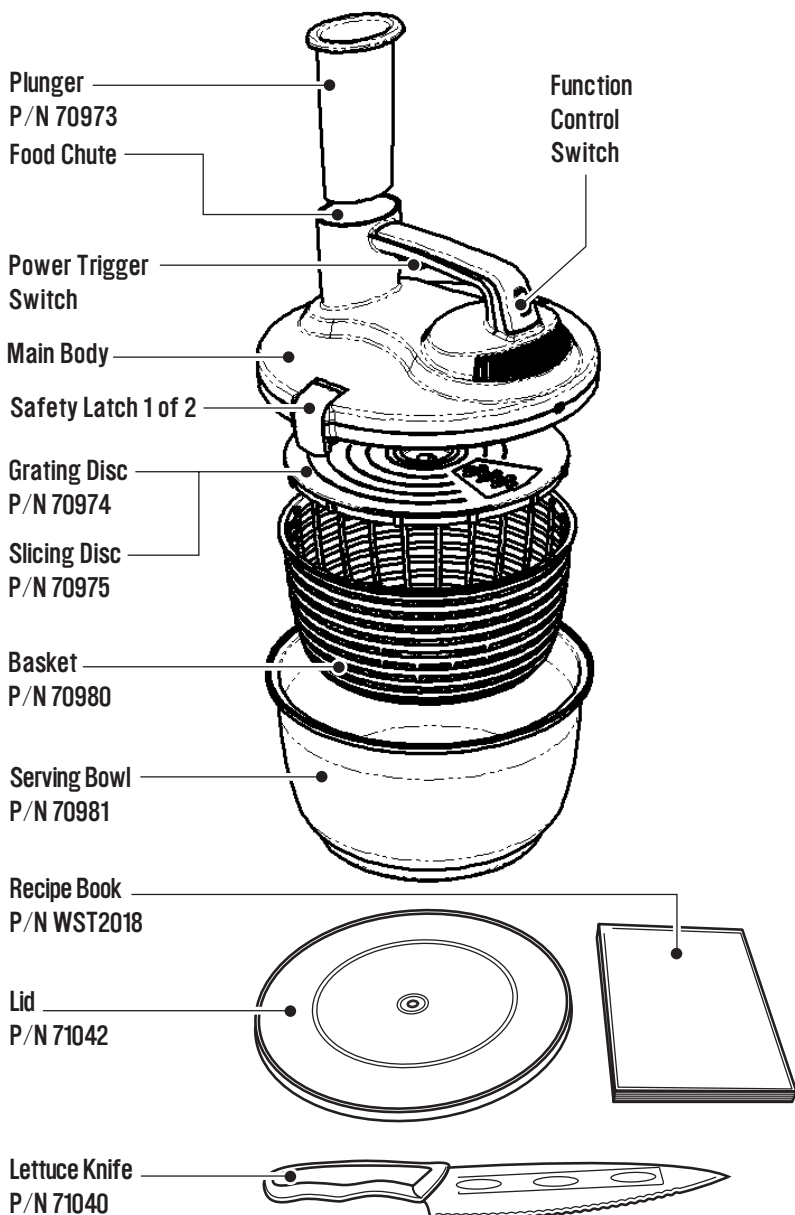

BEFORE FIRST USE:

- 1) Before you assemble your Westinghouse saladXPRESS for the first time, set the main body aside and wash each of the other parts carefully, as described in the CARE AND CLEANING section of this manual. Use warm, soapy water on all parts except the main body, which should be cleaned with a damp sponge or cloth. DO NOT immerse the main body in water.
- 2) Make sure you handle the cutting discs with extra care. Failure to do so could result in personal injury.
- 3) Dry all parts thoroughly before assembly.

4) With the power cord unplugged and function control set to OFF, hold the main body of the saladXPRESS upside down (or place it upside down on a dry surface) and fit either the grating or slicing disc over the drive shaft and turn the twist cap in a clockwise motion to fasten the disc securely to the main body.

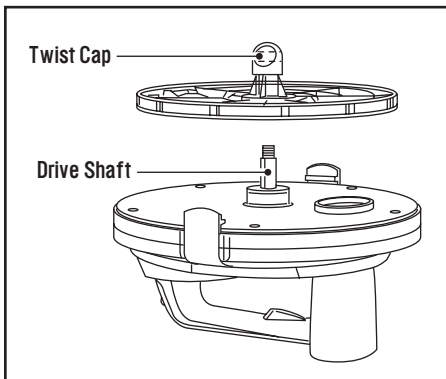

- 5) Place the serving bowl on a clean dry, surface. Set the basket inside it.
- 6) Turn the Main body of the saladXPRESS right side up and place it into the bowl. The raised areas on the outside of the cutting disc should fit inside the lip of the basket.
- 7) Fasten both of the safety latches over the edge of the bowl. Latches will snap into place. As a safety feature, the saladXPRESS will not operate unless the latches are correctly locked in place.

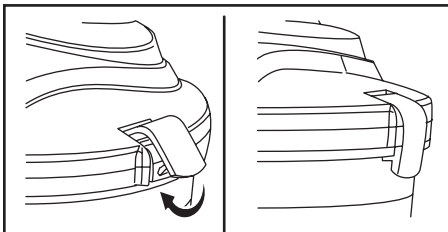

8) Make sure the function control switch on the main body of the saladXPRESS is set to OFF and plug your saladXPRESS into an electrical outlet. It is now ready for use.

INSTRUCTIONS FOR USE:

To shred, grate or slice food:

1) Select and attach the appropriate cutting disc to the main body of the saladXPRESS as described in the previous section.

2) Attach the main body of the saladXPRESS to the bowl and fasten it with the safety latches.

3) Set the function control switch to SLICE/GRATE.

4) Using consistent, even pressure on the plunger, feed food into the chute while pressing the power trigger switch located underneath the top of the handle. The motor of the saladXPRESS will only operate while the power trigger is pressed.

5) To turn the motor off, simply release the power trigger switch.

6) Sliced or shredded food will fall into the bowl. To retrieve food, turn the function control switch to OFF, release the safety latches and lift the main body of the saladXPRESS away from the bowl.

7) The motor on the saladXPRESS will not activate if the safety latches are not correctly fastened around the edge of the bowl. If the motor does not respond when you press the power trigger switch, make sure that the latches are fastened, the function control switch is not set to OFF, and the unit is plugged in.

To spin salad greens:

1) Fill the basket with the salad greens you want to spin.

2) One of the cutting discs must be attached to the main body of the saladXPRESS for the spin dry function to operate.

3) Attach the main body of the saladXPRESS to the bowl and fasten it with the safety latches.

4) Set the function control to SPIN DRY.

5) Press the power trigger switch to start the spinning motion. Five to twenty seconds of spinning is usually sufficient to dry salad greens.

6) To retrieve salad greens, turn the function control switch to OFF, release the safety latches and lift the main body of the saladXPRESS away from the bowl.

7) Never use SLICE/GRATE speed to spin salad greens.

SUGGESTIONS AND HINTS:

Your Westinghouse saladXPRESS has a wide array of uses - the only limit is your imagination. Here are a few suggestions:

- Shred cabbage and carrots for a delicious creamy cole slaw.
- Use the slicing disc to slice mushrooms, peppers and onions for a quick and zesty omelet. Then use the grating disc to grate cheese for it.
- Shred or slice hard boiled eggs for salads and dips.
- Slice salami, turkey or other cooked meats and shred cheeses for chef salads.
- Shred nuts for granola or pie toppings. Or mix the nuts with yogurt and fresh fruit for a healthful snack.
- Shred cheese and slice lettuce, scallions, olives and chili peppers for taco toppings.
- Slice potatoes for chips or American fries, or shred them for delicious hash browns or potato pancakes.
- Shred carrots for carrot cake, or zucchini for wholesome bread.
- Shred chocolate or coconut for cake toppings and cookie dough.
- Slice radishes, zucchini, celery, turnips and other vegetables for hors d'oeuvres and vegetable trays.
- Shred pickles, red peppers and onions for hamburger relish.
- Apples and nuts for savory turkey stuffing.
- Shred cheese for pizza and then slice pepperoni, zucchini, mushrooms, onions or almost any vegetable for toppings.
- Sliced and shredded vegetables can also be used for delicious stir-fry dinners.
- Use the shredder to shred nuts, graham crackers or other cookies for pie crusts.
- Bread and cracker crumbs can be grated for topping casseroles, fish or chicken.

Quick Reference Guide for the Grating and Slicing Discs:

Food Type	Grating	Slicing
Fruits		
Apples	*	*
Avocados		*
Bananas		*
Citrus Rinds	*	
Coconut	*	
Kiwi	*	
Mangos		*
Nectarines		*
Oranges/Lemons	*	
Papayas		*
Peaches		*
Pears	*	
Pineapples	*	*
Strawberries		*
Vegetables		
Cabbage	*	*
Carrots	*	*
Celery		*
Cucumbers	*	*
Peppers		*
Lettuce		*
Mushrooms		*
Olives	*	*
Onions	*	*
Pickles	*	*
Potatoes	*	*
Scallions		*
Sweet Potatoes	*	*
Turnips		*
Zucchini	*	*
Food Type Grating Slicing		
Other Foods		
Bread	*	
Cheese	*	
Chocolate	*	
Cookies/Crackers	*	
Hard Boiled Eggs	*	*
Meat (cooked)	*	*
Nuts	*	*
Tofu		*

CARE, CLEANING AND STORAGE:

Always unplug your saladXPRESS from the electrical outlet before cleaning any part of it.

The serving bowl, basket, cutting discs and plunger are all dishwasher safe. If you wash the basket in the dishwasher, wash it on the **top rack only** to prevent heat damage. The cutting discs and plunger should be positioned securely so they will not fall through the dishwasher rack. You can also wash these parts by hand, using warm soapy water. Handle the cutting discs with extra care, as they are very sharp. Rinse and dry the discs carefully before each use. **Do not wash the main body in the dishwasher.**

To clean the main body, use a damp sponge or cloth to remove any residue. Stubborn stains can be removed with a mild non-abrasive cleaner. Dry carefully before next use. **NEVER** immerse the main body of **saladXPRESS** in water.

You should check the main body of your **saladXPRESS** periodically for damage. If any part of the body is chipped or cracked, do not use the appliance. Contact consumer service.

For compact storage of the **saladXPRESS**, place the plunger in the basket, place basket in bowl, and turn the main body upside down so it fits in the bowl.

LIMITED ONE YEAR WARRANTY

Warranty: This Westinghouse product is warranted by Salton, Inc. to be free from defects in materials or workmanship for a period of (1) year from the original purchase date. This product warranty covers only the original consumer purchaser of the product.

Warranty Coverage: This warranty is void if the product has been damaged by accident in shipment, unreasonable use, misuse, neglect, improper service, commercial use, repairs by unauthorized personnel, normal wear and tear, improper assembly, installation or maintenance abuse or other causes not arising out of defects in materials or workmanship. This warranty is effective only if the product is purchased and operated in the USA, and does not extend to any units which have been used in violation of written instructions furnished with the product or to units which have been altered or modified or to damage to products or parts thereof which have had the serial number removed, altered, defaced or rendered illegible.

Implied Warranties: ANY IMPLIED WARRANTIES WHICH THE PURCHASER MAY HAVE ARE LIMITED IN DURATION TO ONE (1) YEAR FROM THE DATE OF PURCHASE. Some states do not allow limitations on how long an implied warranty lasts, so the above limitation may not apply to you.

Warranty Performance: During the above one-year warranty period, a product with a defect will be either repaired or replaced with a reconditioned comparable model (at our option) when the product is returned to the Repair Center, or the purchase price refunded. The repaired or replacement product will be in warranty for the balance of the one-year warranty period and an additional one-month period. No charge will be made for such repair or replacement.

Service and Repair: Should the appliance malfunction, you should first call toll-free 1 (800) 934-7455 between the hours of 9:00 am and 5:00 pm Central Standard Time and ask for CONSUMER SERVICE stating that you are a consumer with a problem. Please refer to model number WST2020 when you call.

In-Warranty Service (USA): For an appliance covered under the warranty period, no charge is made for service or postage. Call for return authorization (1 800 934-7455).

Out-of Warranty Service: A flat rate charge by model is made for out-of-warranty service. Include \$ 10.00 (U.S.) for return shipping and handling. We will notify you by mail of the amount of the charge for service and require you to pay in advance for the repair or replacement.

For Products Purchased in the USA, but Used in Canada: You may return the product insured, packaged with sufficient protection, and postage and insurance prepaid to the USA address listed below. Please note that all customs duty / brokerage fees, if any, must be paid by you and we will require you to pay the cost of customs duty / brokerage fees to us in advance of our performing any service.

Risk During Shipment: We cannot assume responsibility for loss or damage during incoming shipment. For your protection, carefully package the product for shipment and insure it with the carrier. Be sure to enclose the following items with your appliance: any accessories related to your problem, your full return address and daytime phone number, a note describing the problem you experienced, a copy of your sales receipt or other proof of purchase to determine warranty status. C.O.D. shipments cannot be accepted.

To return the appliance, ship to:

Attn: Repair Center
Salton, Inc.
708 South Missouri Street
Macon, MO 63552

To contact us, please write to, call, or email:

Salton, Inc.
P.O. Box 6916
Columbia, MO 65205-1637
1(800) 934-7455
Email: Salton@Saltonusa.com

Limitation of Remedies: No representative or person is authorized to assume for Salton, Inc. any other liability in connection with the sale of our products. There shall be no claims for defects or failure of performance or product failure under any theory of tort, contract or commercial law including, but not limited to negligence, gross negligence, strict liability, breach of warranty and breach of contract. Repair, replacement or refund shall be the sole remedy of the purchaser under this warranty, and in no event shall Salton be liable for any incidental or consequential damages, losses or expenses. Some states do not allow the exclusion or limitation of incidental or consequential damages, so the above limitation or exclusion may not apply to you.

Legal Rights: This warranty gives you specific legal rights, and you may also have other rights which vary from state to state.

WESTINGHOUSE,  and "YOU CAN BE SURE...IF IT'S WESTINGHOUSE" are trademarks of WESTINGHOUSE ELECTRIC CORPORATION and used under license by Salton, Inc.

For more information on Salton products: Visit our website: www.eSalton.com