

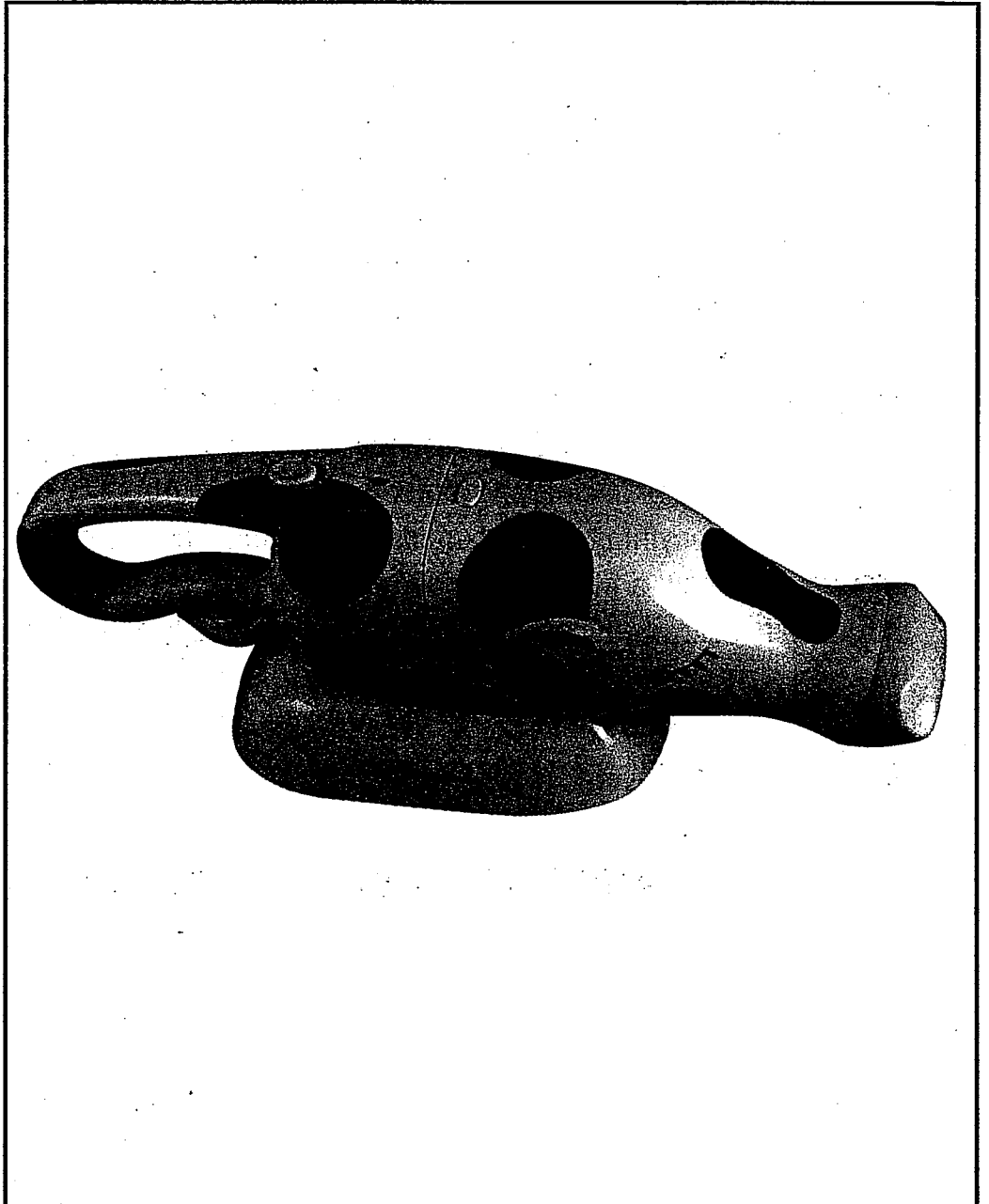

Westinghouse

cowVAC™

cute as a cow, strong as a bull™



WST1100

You can be sure...if it's Westinghouse

IMPORTANT SAFEGUARDS

When using an electric appliance, basic precautions should always be followed, including the following:

READ ALL INSTRUCTIONS BEFORE USING THIS VACUUM CLEANER.

WARNING: To reduce the risk of fire, electric shock, or injury:

1. Do not use outdoors or on wet surfaces.
2. If this appliance is not working as it should, or it has been dropped, damaged, left outdoors or dropped in water, return it to an authorized Service Center for inspection or repair. Do not repair the appliance yourself, as this will invalidate your warranty. Contact Consumer Service for return authorization, examination, repair or adjustment.
3. Do not allow to be used as a toy. Close attention is necessary when used by or near children.
4. Use only as described in this manual.
5. Use only the charger provided with this product to recharge.
6. Do not pull or carry the charger by cord, use cord as a handle, close a door on cord, or pull cord around sharp edges or corners. Keep cord away from heated surfaces.
7. Do not unplug by pulling on cord. To unplug, grasp the charger, not the cord.
8. Do not handle charger or vacuum cleaner with wet hands.
9. This vacuum cleaner creates suction. Keep hair, loose clothing, fingers, and all parts of body away from openings and moving parts.
10. Do not pick up anything that is burning or smoking, such as cigarettes, matches, or hot ashes.
11. Do not use without a filter in place. When servicing the unit, never put fingers or other objects into the fan chamber in case the unit would accidentally be turned on.
12. Use extra care when cleaning on stairs.
13. Do not use to pick up flammable or combustible liquids such as gasoline, or use in areas where they may be present.

WARNING: SAVE THESE INSTRUCTIONS

ADDITIONAL IMPORTANT SAFEGUARDS

1. To avoid excessive heat and damage to the unit or batteries, do not operate the vacuum cleaner while in the charging stand.
2. Do not use extension cords or outlets with inadequate current carrying capacity.
3. The main unit of this product contains nickel cadmium batteries. **DO NOT MUTILATE OR INCINERATE BATTERIES AS THEY WILL EXPLODE AT HIGH TEMPERATURES.**
4. Locate the wall bracket indoors in a cool, dry area not exposed to the weather to avoid electrical shock and/or cleaner damage.
5. Keep your work area well lighted.
6. Unplug electrical appliances before vacuuming them.
7. The terminal on the vacuum cleaner should be kept free and clean of objects. While there is no shock hazard from the terminal, a burn could occur if metal objects are inserted into the terminal area.

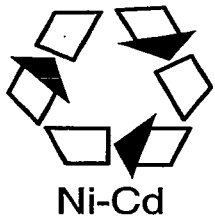

RECYCLING OF NI-CAD BATTERIES

This product contains nickel cadmium rechargeable batteries. Batteries must be recycled or disposed of properly.

This **cowVAC** is equipped with long lasting, Rechargeable Nickel Cadmium batteries. To protect the environment, they should be removed at the end of the batteries' life for safe disposal in accordance with your local and state requirements.

To recycle your nickel-cadmium batteries, follow the directions provided below. Please **DO NOT** put the main unit or batteries in the trash. Use the collection system provided in your community. Contact your local battery recycling center.

Batteries should be removed **ONLY WHEN UNIT IS TO BE DISCARDED.**

Make sure **cowVAC** is unplugged before dismantling for battery removal.

To remove the batteries: Remove the 7 screws on the side of main unit. Remove the bottom plate. Take off the tape holding the batteries in place. Unclip the connectors on both sides of the batteries. Dispose of batteries according to local regulations.

All repairs or battery replacement should be performed by an Authorized Service Location.

GETTING TO KNOW YOUR cowVAC:

The box containing your **Westinghouse® cowVAC** should include the following parts.

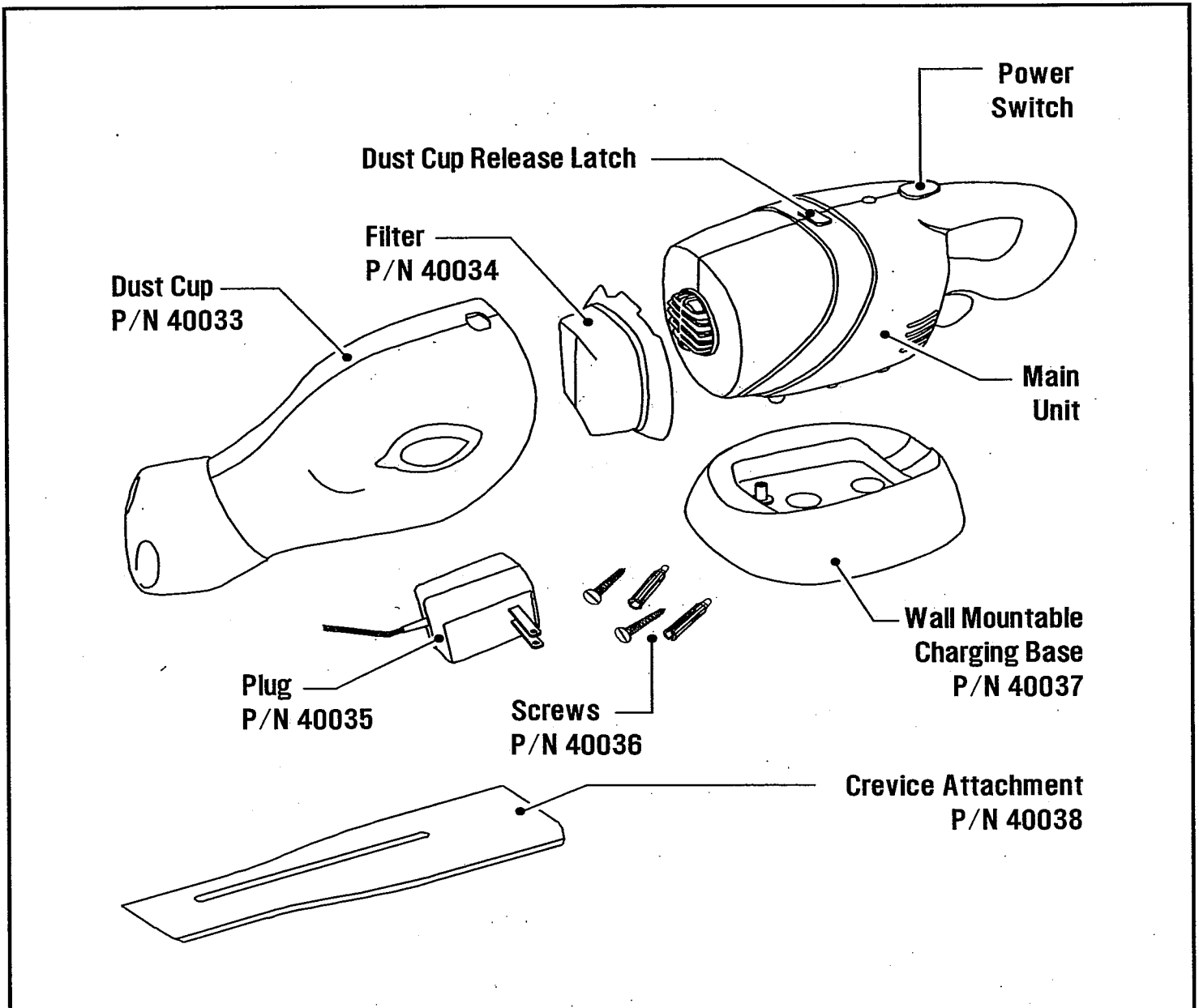

BEFORE FIRST USE:

1. Carefully unpack the **cowVAC** and remove all packaging material.
2. To remove any dust that may have accumulated during packaging, simply wipe the **cowVAC** exterior with a clean, damp cloth.
3. Do not use abrasive cleaners.
4. Do not put the **cowVAC** cord or plug in water.

MOUNTING AND USING THE CHARGING BASE:

You can mount the charging base on a wall or simply place (or mount) it on a horizontal surface.

To mount on a wall, use the two mounting screws to fix the base within convenient reach of an electrical outlet.

Once the charging base is mounted, insert the plug into the electrical outlet.

To charge the cowVAC, place the front of the unit onto the charging base making sure the metal contact enters the contact receptacle. Then gently push the rear of the **cowVAC** down until it snaps into place.

The power switch must be in the OFF position for the unit to charge. The bottom of the **cowVAC** may get slightly warm during charging - this is normal and perfectly safe.

The **cowVAC** can remain on the charging base indefinitely without damage to the unit - it is impossible to "overcharge" the **cowVAC**.

Make sure you charge the **cowVAC** for at least 24 hours before using it for the first time. You should try to fully discharge the unit the first few times you use it, as this will help it recharge faster for subsequent usage. Once the unit has been recharged several times, this procedure is not necessary - simply place the **cowVAC** on the charging base when you are finished vacuuming, regardless of whether or not any power remains.

A full charge should give you about 8-10 minutes of continuous use.

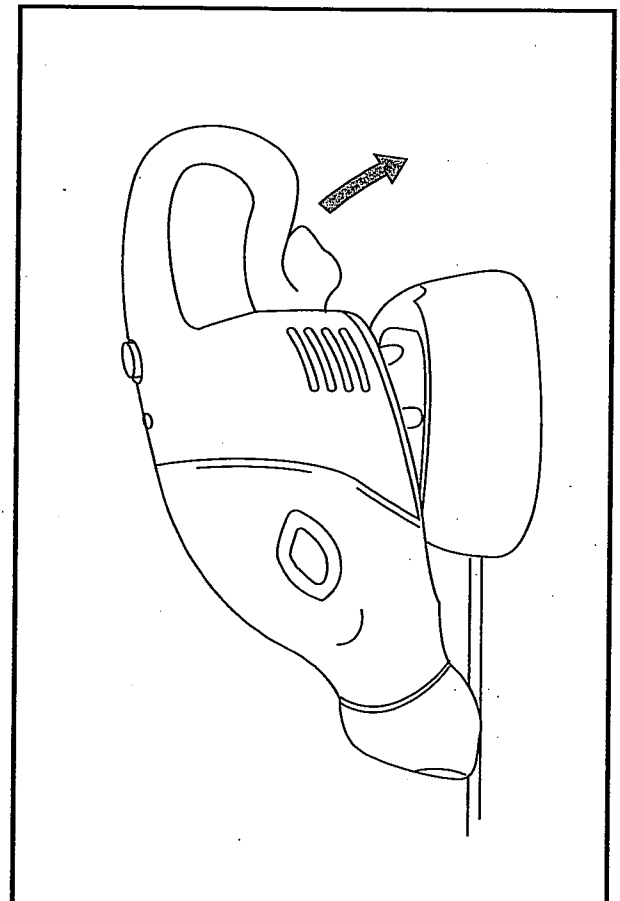
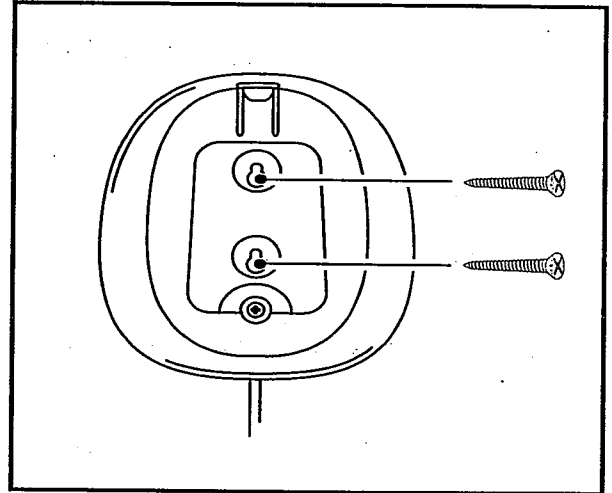

OPERATING YOUR cowVAC:

To activate the **cowVAC**, push the power switch forward to the ON position. To deactivate, slide the switch back to the OFF position. Return the **cowVAC** to the charger base when you are finished vacuuming, so it will be fully charged for the next use.

SAFETY REMINDERS:

- * NEVER USE THE **cowVAC** TO PICK UP LIQUIDS OF ANY KIND.
- * DO NOT HANDLE THE **cowVAC** WITH WET HANDS.
- * DO NOT VACUUM BURNING OR SMOKING MATERIALS.
- * GRASP THE **cowVAC** FIRMLY.
- * NEVER USE THE **cowVAC** WITHOUT A FILTER.

TROUBLESHOOTING:

Problem: Unit will not operate

If your **cowVAC** will not operate at all, it may simply be out of power. Return the unit to the charging base and let it charge for an extended period. Make sure the cord from the charging base is plugged into an electrical outlet.

Problem: Suction power is weak

If the **cowVAC** is not picking up dust very well, the dust cup may be full. Remove the dust cup from the unit and check it carefully. Also check the filter and clean it if necessary. See CARE AND CLEANING section of this book.

Problem: Dust escapes from the **cowVAC**

If dust escapes from the **cowVAC** when you turn it off, the dust cup is probably full. Remove the dust cup from the unit and observe its contents. Also check the filter to make sure it is installed properly. Another possibility is that there is a hole in the filter; check it carefully and replace it if necessary.

CARE AND CLEANING:

The filter in your **cowVAC** is reusable. Depending on how often you use your **cowVAC**, the filter should be replaced every 6-12 months.

TO CLEAN the **cowVAC**, perform the following steps:

1) Open the **cowVAC** by pressing the dust cup release latch and pulling the dust cup forward:

2) Remove the filter from the dust cup:

3) Empty dust from the dust cup: You can rinse the inside with warm soapy water if necessary. Dry thoroughly before reassembling.

4) Wash the filter in warm, soapy water and dry thoroughly before reusing.

5) To clean the exterior of your **cowVAC**, use a damp cloth and warm soapy water if necessary. Always ensure the unit is completely dry before reusing. Never immerse the unit in water.

6) Reassemble the **cowVAC** by inserting the clean filter back into the dust cup and reattaching the dust cup to the main unit. Make sure the dust cup is firmly in position and the release latch has clicked into place.

After cleaning any part of your **cowVAC**, always check for damage before re-assembly. If any part of the unit is chipped or cracked, do not use it. Contact your authorized service center for repair.

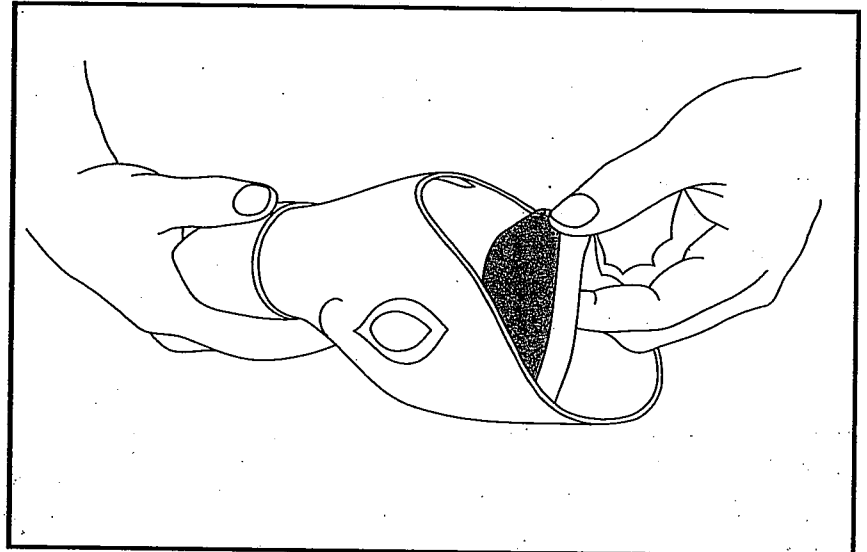
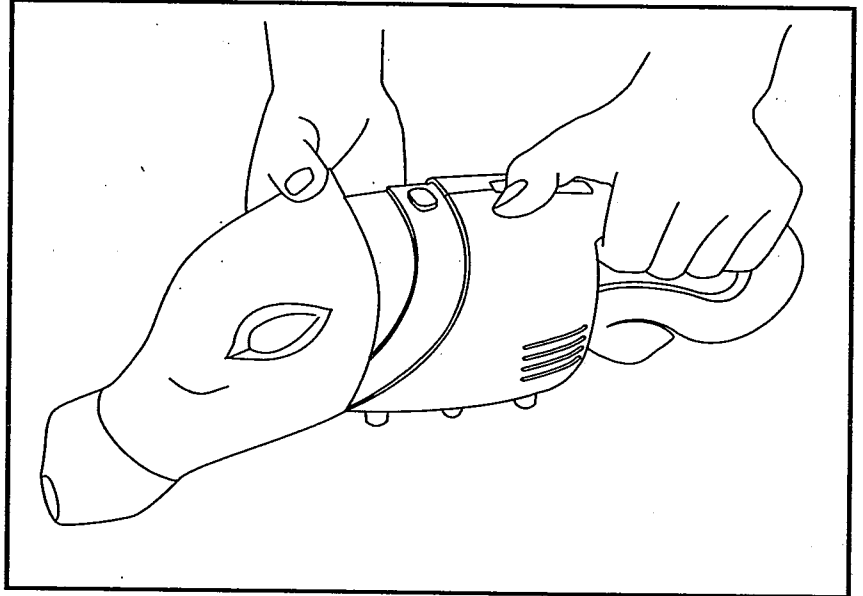

Important note:

Your **cowVAC** will vacuum most efficiently when the dust cup is empty and the filter is free of large clumps of dust. If dust falls from the nozzle of the **cowVAC** when the unit is turned off, the dust cup is probably full and requires emptying.

LIMITED ONE YEAR WARRANTY

Warranty: This Westinghouse® product is warranted by Salton, Inc. to be free from defects in materials or workmanship for a period of (1) year from the original purchase date. This product warranty covers only the original consumer purchaser of the product.

Warranty Coverage: This warranty is void if the product has been damaged by accident in shipment, unreasonable use, misuse, neglect, improper service, commercial use, repairs by unauthorized personnel, normal wear and tear, improper assembly, installation or maintenance abuse or other causes not arising out of defects in materials or workmanship. This warranty is effective only if the product is purchased and operated in the USA, and does not extend to any units which have been used in violation of written instructions furnished with the product or to units which have been altered or modified or to damage to products or parts thereof which have had the serial number removed, altered, defaced or rendered illegible.

Implied Warranties: ANY IMPLIED WARRANTIES WHICH THE PURCHASER MAY HAVE ARE LIMITED IN DURATION TO ONE (1) YEAR FROM THE DATE OF PURCHASE. Some states do not allow limitations on how long an implied warranty lasts, so the above limitation may not apply to you.

Warranty Performance: During the above one-year warranty period, a product with a defect will be either repaired or replaced with a reconditioned comparable model (at our option) when the product is returned to the Repair Center, or the purchase price refunded. The repaired or replacement product will be in warranty for the balance of the one-year warranty period and an additional one-month period. No charge will be made for such repair or replacement.

Service and Repair: Should the appliance malfunction, you should first call toll-free 1 (800) 934-7455 between the hours of 9:00 am and 5:00 pm Central Standard Time and ask for CONSUMER SERVICE stating that you are a consumer with a problem. Please refer to model number WST2000BLK when you call.

In-Warranty Service (USA): For an appliance covered under the warranty period, no charge is made for service or postage. Call for return authorization (1 800 934-7455).

Out-of Warranty Service: A flat rate charge by model is made for out-of-warranty service. Include \$8.00 (U.S.) for return shipping and handling. We will notify you by mail of the amount of the charge for service and require you to pay in advance for the repair or replacement.

For Products Purchased in the USA, but Used in Canada: You may return the product insured, packaged with sufficient protection, and postage and insurance prepaid to the USA address listed below. Please note that all customs duty / brokerage fees, if any, must be paid by you and we will require you to pay the cost of customs duty / brokerage fees to us in advance of our performing any service.

Risk During Shipment: We cannot assume responsibility for loss or damage during incoming shipment. For your protection, carefully package the product for shipment and insure it with the carrier. Be sure to enclose the following items with your appliance: any accessories related to your problem, your full return address and daytime phone number, a note describing the problem you experienced, a copy of your sales receipt or other proof of purchase to determine warranty status. C.O.D. shipments cannot be accepted.

To return the appliance, ship to:

Attn: Repair Center
Salton, Inc.
708 South Missouri Street
Macon, MO 63552

To contact us, please write to, call, or email:

Salton, Inc.
P.O. Box 6916
Columbia, MO 65205-1637
1(800) 934-7455
Email: Salton@Saltonusa.com

Limitation of Remedies: No representative or person is authorized to assume for Salton, Inc. any other liability in connection with the sale of our products. There shall be no claims for defects or failure of performance or product failure under any theory of tort, contract or commercial law including, but not limited to negligence, gross negligence, strict liability, breach of warranty and breach of contract. Repair, replacement or refund shall be the sole remedy of the purchaser under this warranty, and in no event shall Salton be liable for any incidental or consequential damages, losses or expenses. Some states do not allow the exclusion or limitation of incidental or consequential damages, so the above limitation or exclusion may not apply to you.

Legal Rights: This warranty gives you specific legal rights, and you may also have other rights which vary from state to state.

WESTINGHOUSE™, Ⓜ and "YOU CAN BE SURE...IF IT'S WESTINGHOUSE™" are trademarks of WESTINGHOUSE ELECTRIC CORPORATION and used under license by Salton, Inc.

For more information on Salton products: Visit our website: www.eSalton.com