

OWNER'S MANUAL
MODEL No. RA-6

Automatic Rice Cooker

Cocinar Arroz 電飯煲

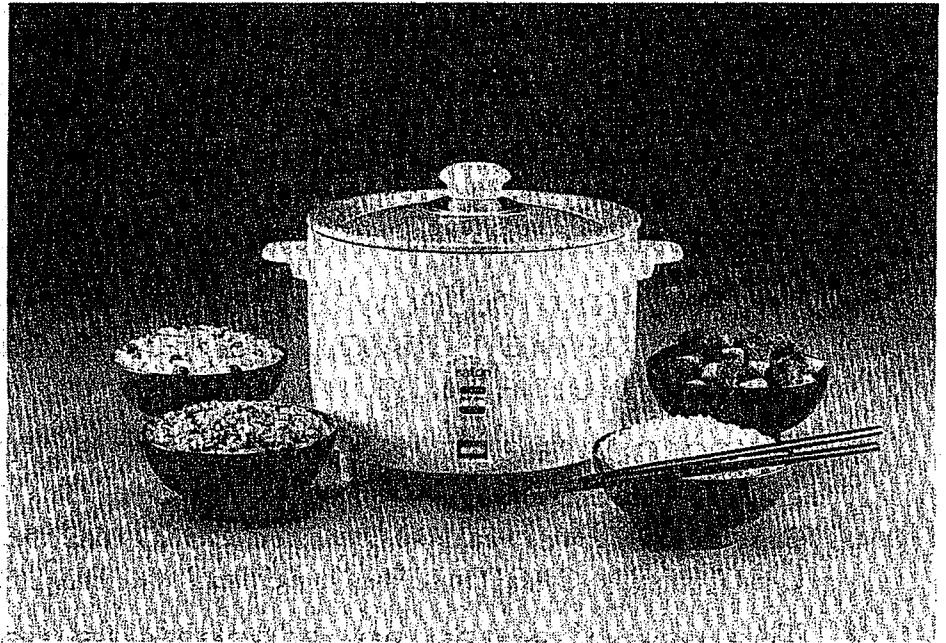

salton®

Get a taste of the good life with Salton.

IMPORTANT SAFEGUARDS

When using electrical appliances, basic safety precautions should always be followed, including the following:

- 1.** Read all instructions.
- 2.** Do not touch hot surfaces. Use pot holders when removing cover or handling hot containers.
- 3.** To protect against electrical shock, do not immerse cord, plug or base unit in water or other liquid.
- 4.** Close supervision is necessary when any appliance is used by or near children.
- 5.** Unplug from outlet when not in use and before cleaning. Unplug before putting on or taking off parts, and allow to cool before cleaning.
- 6.** Do not operate any appliance with a damaged cord or plug, or after the appliance malfunctions or has been damaged in any manner. Return appliance to the Salton/MAXIM Service Center for examination, repair or adjustment.
- 7.** The use of accessory attachments not recommended by Salton/MAXIM may cause hazards.
- 8.** Do not use outdoors.
- 9.** Do not let cord hang over edge of table or counter, or touch hot surfaces.
- 10.** Do not place on or near a hot gas or electric burner, or in a heated oven.
- 11.** Extreme caution must be used when moving an appliance containing hot food, water, or other hot liquids.
- 12.** Do not use appliance for other than intended use.
- 13.** Lift and open cover carefully to avoid scalding, and allow water to drip into rice cooker.

SAVE THESE INSTRUCTIONS

Short Cord Instructions

A short power-supply cord is provided to reduce the risk resulting from becoming entangled in or tripping over a longer cord.

Longer extension cords are available and may be used if care is exercised in their use.

If a longer extension cord is used, (1) the marked electrical rating of the extension cord should be at least as great as the electrical rating of the appliance, and (2) the cord should be arranged so that it will not drape over the counter top or table top where it can be pulled on by children or tripped over unintentionally.

Additional Important Safeguards

1. **CAUTION:** This appliance generates heat and escaping steam during use. Proper precautions must be taken to prevent the risk of burns, fires or other damage to persons or property.
2. All users of this appliance must read and understand this Owner's Manual before operating or cleaning this appliance.
3. The cord to this appliance should be plugged into a 120V AC electrical outlet only.
4. When using this appliance, provide adequate air space above and on all sides for air circulation. Do not allow this appliance to touch curtains, wall coverings, clothing, dishtowels or other flammable materials during use.
5. Do not leave this appliance unattended during use.
6. This appliance generates steam — do not operate uncovered.
7. If this appliance begins to malfunction during use, immediately unplug the cord. Do not use or attempt to repair the malfunctioning appliance! Do not use the inner pot or glass lid if cracked or chipped.
8. **THIS APPLIANCE IS FOR HOUSEHOLD USE ONLY.**

Before Using For The First Time

Clean the glass lid, inner pot, ladle and measuring cup, following the User Maintenance Instructions on page 5.

Do not immerse the heating body of your rice cooker in water or any other liquid!

Getting to Know Your Salton® RA-6 Electric Rice Cooker

Before using your Electric Rice Cooker for the first time, you must become familiar with all of the parts. Read all instructions and safeguards carefully.

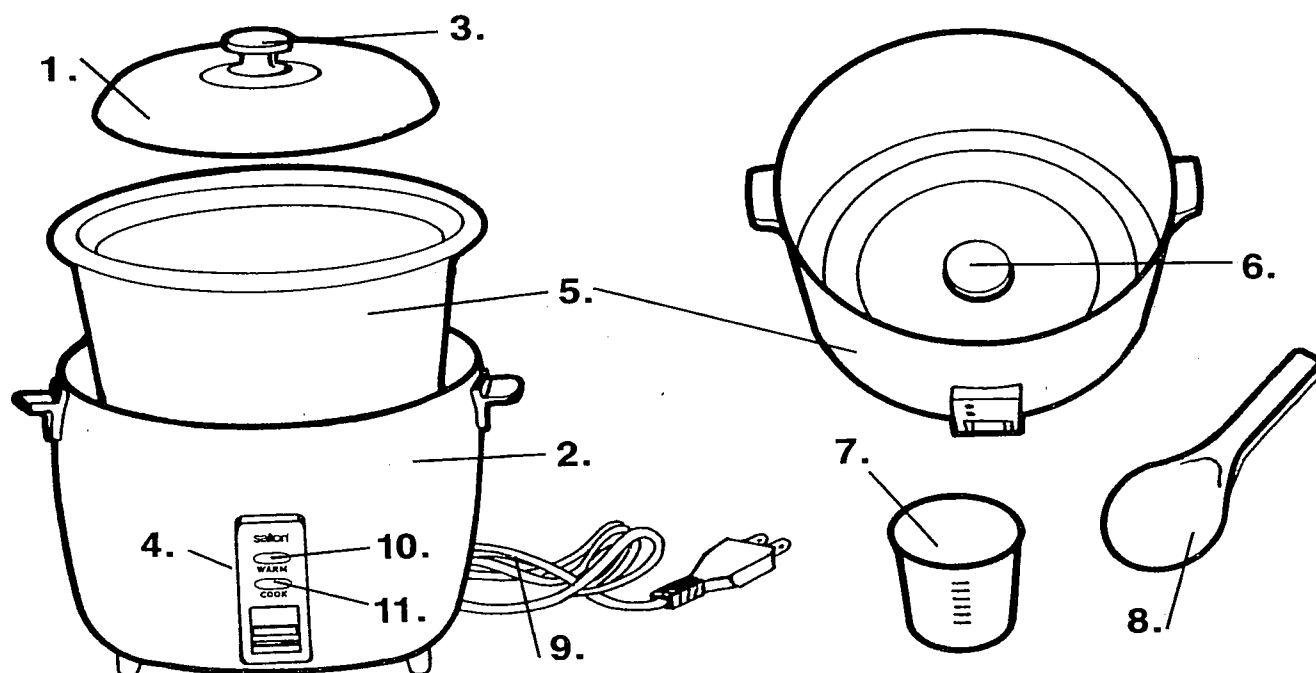

- | | | |
|-------------------------------|------------------|------------------|
| 1. Glass lid | 5. Inner pot | 9. Cord |
| 2. Heating body | 6. Heating plate | 10. "Warm" light |
| 3. Handle | 7. Measuring cup | 11. "Cook" light |
| 4. Rice cooking switch button | 8. Ladle | |

Instructions For Use

1. Measure the raw rice.

Measure raw rice for desired amount with the measuring cup provided, 180 ml. One (1) cup of the uncooked rice will make about 3 cups of cooked rice.

NOTE: The rice cooker is capable of cooking up to 6 cups of the uncooked rice only. (See figure below)



Many varieties of rice can be used, including basmati, wild, black rice, arborio risotto, saffron rice, and long grain. ***We do not recommend using instant rice with this rice cooker.***

Whole grains, such as barley, can also be prepared with the rice cooker. Follow package instructions.

2. Wash the measured rice in a separate bowl, if desired.

Instructions For Use *(continued)*

3. Make sure the appliance is unplugged. Put rice into the inner pot and add water.

For example, to cook 6 cups of uncooked rice, add 6 measuring cups of water. The WATER LEVEL of the inner pot is for reference, and adjust the amount of water to your personal taste. Do not use wine, broth or other liquids.

4. Set the inner pot into the cooker.

Clean inner surface of the cooker, and set the inner pot into the cooker. Make sure that the inner pot is directly in contact with the heating plate by turning it slightly from right to left until it seats properly.

NOTE: If the outside of the inner pot is wet when placed into the cooker, this may cause a cracking noise while the unit heats up. Also this may incur damages to the inner working of the appliance, so always wipe the outside of the pot completely before use.

5. Cover with the lid.

DO NOT OPERATE THIS APPLIANCE UNCOVERED — STEAM IS GENERATED DURING USE!

6. Plug the cord into a 120V AC electrical outlet. Switch the rice cooker on. Make sure the "Cook" light is on. Steaming will start.

7. Steam for 15 min. after the Rice Cooking switch is turned off.

When the Rice Cooking switch turns off by itself, (Cooking lamp will go off and "Warm" light will illuminate.) leave the lid closed to steam for approximately 15 minutes.

8. Mix the rice.

After 15 minutes of steaming, carefully open the lid taking care to avoid escaping steam. Use the ladle or other long-handle utensil to scoop and mix the rice well to allow steam to escape.

CAUTION: Steam will escape. **DO NOT TOUCH THE INNER POT OR THE HEATING BODY!**

9. Keep Warm.

When the cooking is completed, the rice cooker will automatically go on to "Warm" mode and "Warm light" will illuminate.

NOTE: DO NOT WARM FOR MORE THAN 12 HOURS. IT IS RECOMMENDED TO CONSUME WITHIN 12 HOURS FROM COOKING.

If the "Warm" mode is not desired, unplug cord from the wall outlet. **DO NOT TOUCH THE INNER POT OR THE HEATING BODY UNTIL THEY HAVE COOLED!**

10. Allow the appliance to cool completely before cleaning.
11. Disconnect the plug from the wall outlet when not in use.

To Keep Cooked Rice Warm & Tasty

- ☐ **Washing rice** — Bran gives an unpleasant smell to the cooked rice. Be sure to wash rice thoroughly. Washing with water will be effective to quickly and thoroughly remove bran.

NOTE: Some rice suppliers suggest not to wash rice because vitamins may be lost.

- ☐ Keep the lid securely closed during Keep Warm operation. To prevent dry, discolored effect and unpleasant smell of rice, keep the glass lid perfectly closed.
- ☐ If the plug must be removed during the Keep Warm operation to move the rice cooker or for any other reason, plug it back in as soon as possible.
- ☐ Keep the inner pot and glass lid clean after use. Wash in warm soapy water. Rinse thoroughly and dry.
- ☐ Avoid using Keep Warm operation —
 - When there is only small amount of rice to keep warm,
 - When the operation exceeds 12 hours,
 - When the rice scoop is inside the cooker,
 - To warm up cold rice, and
 - To add cold rice when there is already some rice being kept warm.

User Maintenance Instructions

This appliance should be cleaned after every use.

1. Unplug the appliance from outlet when not in use and before cleaning. **NEVER immerse heating body in water.** Allow the rice cooker to cool before cleaning.
2. **DO NOT use abrasive cleaners or scouring pads or steel wool to clean this appliance.**
3. **Heating body.** Lightly wipe the exterior with a damp cloth. **DO NOT IMMERSE THE HEATING BODY IN WATER OR ANY OTHER LIQUID!** Dry thoroughly with a soft cloth.
4. **Inner pot.** Fill with hot water and let sit for a while, and then wash in hot, soapy water with a sponge and dry thoroughly with a cloth.
5. **Glass lid, Measuring cup, Ladle.** Wash in warm, soapy water. Rinse thoroughly and dry.

CAUTION: Handle the glass lid with extreme care, as it may become slippery when wet.
6. **Heating plate, Thermostat.** Grains of rice or other foreign matters may stick to the heating plate. These must be removed to prevent inadequate cooking. To remove the cooked rice, smooth sand paper can be used. Smooth out and polish the spot for good contact between the heating plate and the bottom of the inner pot.
7. There are no user serviceable parts inside this appliance. Do not attempt to repair this appliance yourself, as you could render it dangerous to use. Return it to the Salton/MAXIM Service Center for repairs.

THIS APPLIANCE IS FOR HOUSEHOLD USE ONLY!

LIMITED WARRANTY

Products distributed by Salton/MAXIM Housewares, Inc. are warranted for one year from date of purchase against defects in workmanship and material. During that period these defects will be repaired or the product will be replaced at Salton/MAXIM's option, without charge. This warranty covers normal consumer usage and does not cover damage which occurs in shipment or failure which results from alteration, accident, misuse, abuse, neglect, installation, commercial use or improper maintenance. This warranty is effective only if the product is purchased and operated in the USA, and does not extend to any units which have been used in violation of written instructions furnished by Salton/MAXIM Housewares, Inc., or to units which have been altered or modified without authorization of Salton/MAXIM Housewares, Inc., or to damage to products or parts thereof which have had the serial number removed, altered, defaced or rendered illegible. This warranty does not cover damage which results from unauthorized repairs.

Service and Repair

DO NOT attempt to repair your SALTON® RA-6 Automatic Rice Cooker. Attempts to repair this appliance yourself may render it dangerous to use. Should the appliance malfunction, you should first call toll free 1-800-233-9054 between the hours of 9:00 am and 5:00 pm Central Standard Time and ask for CONSUMER CUSTOMER SERVICE stating that you are a consumer with a problem. If the problem cannot be resolved, you will be asked to return the appliance to the factory for repair. Under no circumstances should you attempt to open the housing and repair the appliance. Should you do this, your warranty will be voided.

To Return for Service

1. Securely package and return the product, PREPAID to:
Salton/MAXIM Housewares, Inc., Repair Department
550 Business Center Drive, Mt. Prospect, IL 60056
2. Be sure to enclose:
 - a. Your name, address and phone number.
 - b. The date of purchase (or receipt as a gift).
 - c. An explanation of the malfunction or reason for return.
 - d. Eight dollars (\$8.00) Check or Money Order payable to Salton/MAXIM Housewares, Inc. for return postage and handling.
 - e. To insure prompt "In-Warranty" service, be sure to include proof of date of purchase.

We recommend you take the necessary precaution of insuring the parcel.

3. **Toll Free** Number: 1-800-233-9054.



salton®