

cook's essentials®

HIGH PERFORMANCE KITCHENWARE

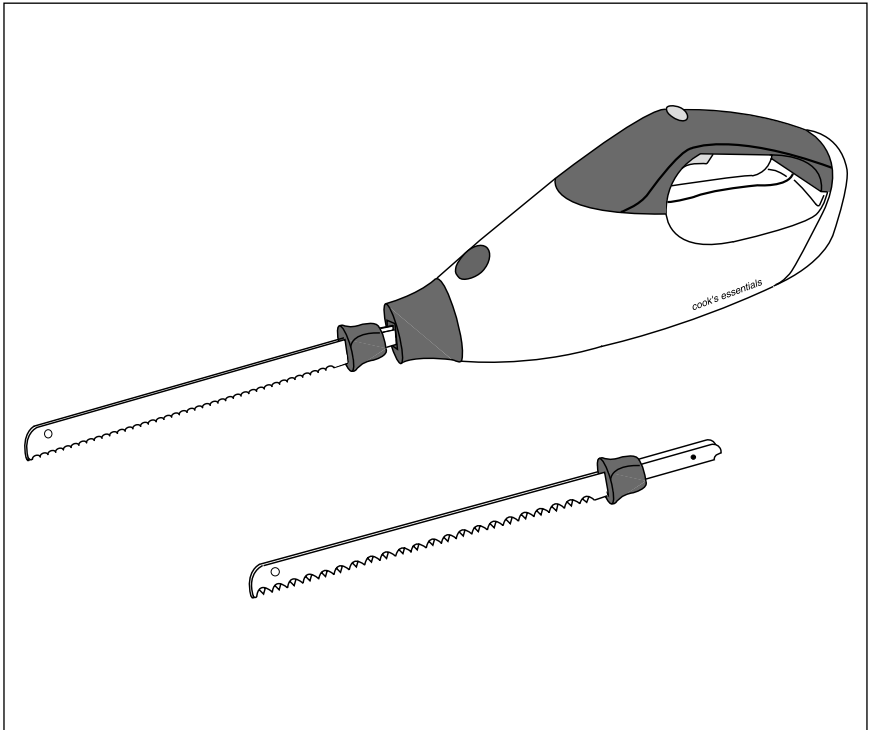

ELECTRIC KNIFE WITH DUAL BLADE SYSTEM

Model CEEK1
Owner's Manual and Recipe Guide

IMPORTANT SAFEGUARDS

When using electrical appliances, basic safety precautions should always be followed including the following:

1. Read all instructions.
2. To protect against risk of electrical shock, do not put Cord, Plug or appliance in water or other liquid.
3. Close supervision is necessary when any appliance is used by or near children.
4. Unplug from outlet when not in use, before putting on or taking off parts and before cleaning.
5. Avoid contacting moving parts.
6. Do not operate any appliance with a damaged cord or plug or after the appliance malfunctions, or is dropped or damaged in any manner. Contact Consumer Service.
7. The use of attachments not recommended or sold by the manufacturer may cause fire, electric shock or injury.
8. Do not use outdoors.
9. Do not let cord hang over edge of table or counter.
10. Do not let cord contact hot surface, including the stove.
11. Do not operate knife in water or under running water.
12. Disconnect when changing blades.
13. Blades are sharp. Handle carefully. Always handle blades with hand away from cutting edge. Always store blades with cutting edge away from you.

SAVE THESE INSTRUCTIONS

THIS PRODUCT IS FOR HOUSEHOLD USE ONLY

ADDITIONAL IMPORTANT SAFEGUARDS

1. All users of this appliance must read and understand this Owner's Manual before operating or cleaning this appliance.
2. The cord to this appliance should be plugged into a 120V AC electrical outlet only.
3. If this appliance begins to malfunction during use, immediately release "ON/OFF" Button and unplug the cord. Do not use or attempt to repair the malfunctioning appliance.
4. To avoid electric shock, unplug the Electric Knife before cleaning.

POLARIZED PLUG

This appliance has a polarized plug (one blade is wider than the other). To reduce the risk of electrical shock, this plug is intended to fit in a polarized outlet only one way. If the plug does not fit fully into the outlet, reverse the plug. If it still does not fit, contact a qualified electrician. Do not attempt to modify the plug in any way.

Introduction

Congratulations on your purchase of the cook's essentials® CEEK1 Electric Knife with dual blade system. This Electric Knife, with its classic looks and styling, features a comfort-grip handle design, push button operation, two dual blade sets with self sharpening action, a sleek brushed aluminum exterior and swivel power cord. The Universal Blades are suitable for cutting a wide range of foods, such as, crusty foods, cooked meats, breads, fruits and vegetables. The Bread and Frozen Food Blades cut through frozen foods and breads. The self sharpening blade action ensures long lasting performance.

Before Using for the First Time

1. Carefully unpack the Electric Knife.
2. Make sure the unit is unplugged and then wipe all surfaces with a slightly damp, soft cloth and dry thoroughly. Never immerse the Electric Knife in water or any other liquid. Do not use steel wool, scouring pads or abrasive cleansers as they will damage the finish.

CAUTION: Blades are very sharp; keep hands away from cutting edges. Always hold the Blades with the serrated edges away from you.

3. Remove the Protective Sleeve from both sets of Blades. Save Protective Sleeve for Blade storage.
4. The blades are extremely sharp. Always handle by the side opposite the cutting edge, or by the blade guards.
5. Wash both sets of Blades in warm soapy water. Rinse and dry thoroughly.
6. If blades are separated, slide the rivet on one blade into the keyhole slot in the other blade until they are locked together.
NOTE: When connecting the blades, make sure not to mix blade types.
7. To protect against accidental injury, slide Protective Sleeves back on Blades when not in use.

Getting To Know Your cook's essentials® CEEK1 Electric Knife with Dual Blade System

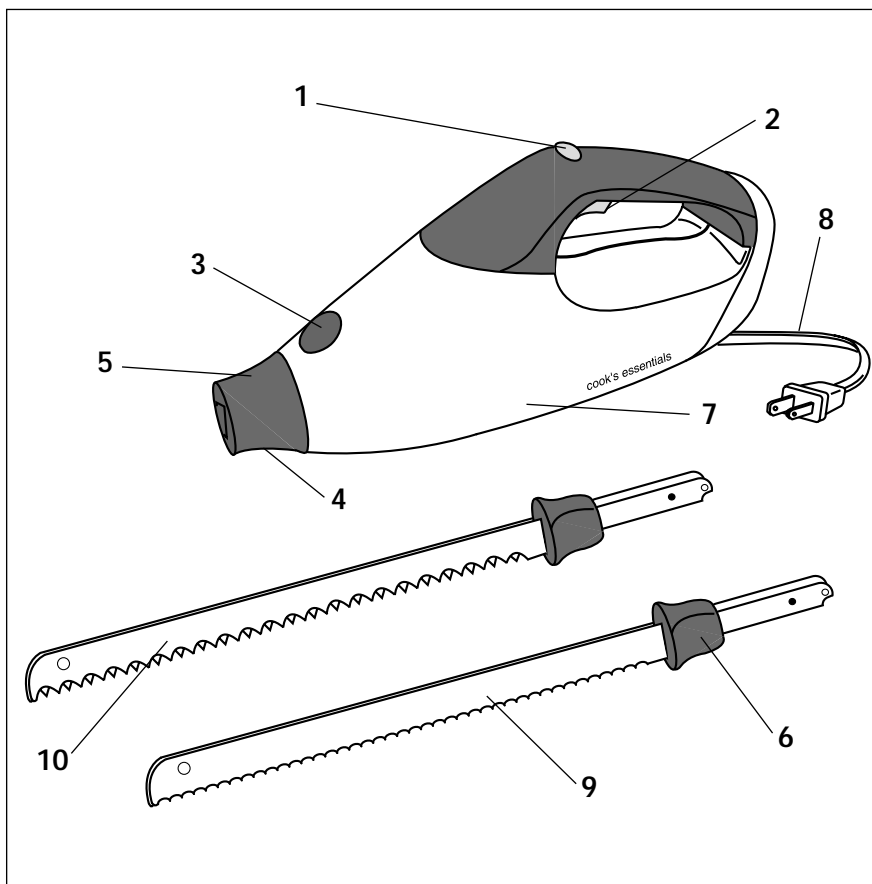

- | | |
|------------------------------|---|
| 1. "ON/OFF" Button | 8. Swivel Power Cord. |
| 2. Safety Switch | 9. Universal Blade Set
(P/N 70667) |
| 3. Blade Eject Button | 10. Bread and Frozen Food
Blade Set
(P/N 70668) |
| 4. Swivel Turret Lock Button | 11. Protective Sleeve for Blades
(2) (Not Shown) (P/N 70669) |
| 5. Swivel Turret | |
| 6. Blade Guard | |
| 7. Motor Body | |

Operating Instructions

CAUTION: Always unplug Electric Knife before inserting or removing Blades or when the Electric Knife is not in use.

1. Be sure cord is unplugged.
2. Choose which Blade Set you will be using. The Universal Blade Set or the Bread and Frozen Food Blade Set.
3. Before removing the Protective Sleeve, carefully insert Blade Set (cutting edge down) into the Swivel Turret. Push the Blade Guard into the Swivel Turret until you hear the Blades click into position.
4. The Swivel Turret can be turned at a 90° angle to the left or the right to facilitate horizontal cutting. To use this feature, press the Lock Button at the bottom of the Swivel Turret and turn 90° until it locks into position. **Note:** To remove the Blades when cutting is complete, the Swivel Turret must be turned back to the Vertical Position.

CAUTION: Blades are very sharp; keep hands away from cutting surfaces. Always hold the Blades with the serrated edges away from you.

5. Remove the Protective Sleeve from the Blade Set and save it for later storage.
6. Plug Cord into a 120V AC electrical outlet. Turn the Swivel Cord at the base of the unit so that it is in a position that does not interfere with cutting operation.
7. To carve/slice, pull up on the "SAFETY SWITCH" on the underside of the Handle, then press down on the "ON/OFF" Button located on the top of the Handle. The Blades will quickly move back and forth. The Knife will stop when the "SAFETY SWITCH" or "ON/OFF" Button is released.
8. Use a carving board to avoid damaging Blades and counter tops.
9. When meat contains a bone, cut down to the bone, but do not attempt to cut through the bone.
10. When cutting with the Universal Blade, gently guide the knife through the food. Excessive sawing or pressure is unnecessary. When cutting with the Bread and Frozen Food Blade, a back and forth sawing motion may be necessary.

Operating Instructions (Cont.)

Removing the Blades

CAUTION: *Always unplug Electric Knife before removing Blades. Blades are sharp; handle carefully. Always hold the Blades with the serrated edges away from you.*

1. Unplug cord from electric outlet.
2. Press Blade Eject Button.
3. Grasp Blade Set at Blade Guard and carefully pull Blades from nose of Knife.

User Maintenance Instructions

This cook's essentials® CEEK1 Electric Knife with dual blade system requires little maintenance. It contains no user-serviceable parts. Any servicing requiring disassembly must be performed by a qualified appliance repair technician.

CAUTION: *Do not immerse Motor Body, Cord, or Plug in water or any other liquid.*

Cleaning

1. Unplug the Electric Knife before cleaning.
2. Press the Eject Button and Carefully remove the Blades by pulling gently on the Blade Guards. Never touch the cutting edge of the Blades as they are very sharp.

WARNING: *Blades are sharp. Handle carefully. Always handle Blades with hand away from cutting edge. Always store Blades with cutting edge away from you.*

3. Wash the Blades in warm soapy water and dry thoroughly.
4. Wipe the exterior with a soft, damp cloth. Dry thoroughly. Never immerse the Motor Body in water or any other liquid.
5. Do not use steel wool, scouring pads, or abrasive cleaners, as they will damage the finish.
6. DO NOT WASH BLADES IN DISHWASHER.

Storage

1. Clean the Electric Knife as instructed above.
2. Carefully slide the Protective Sleeve onto the Blade Set.
3. **Never wrap cord tightly around the appliance.** Do not put any stress on the cord where it enters the unit, as it could cause the cord to fray and break.
4. Store Electric Knife in its original box in a clean, dry location.

LIMITED ONE YEAR WARRANTY

Warranty: This cook's essentials® product is warranted by the manufacturer to be free from defects in materials or workmanship for a period of (1) year from the original purchase date. This product warranty covers only the original consumer purchaser of the product.

Warranty Coverage: This warranty is void if the product has been damaged by accident in shipment, unreasonable use, misuse, neglect, improper service, commercial use, repairs by unauthorized personnel, normal wear and tear, improper assembly, installation or maintenance abuse or other causes not arising out of defects in materials or workmanship. This warranty is effective only if the product is purchased and operated in the USA, and does not extend to any units which have been used in violation of written instructions furnished with the product or to units which have been altered or modified or to damage to products or parts thereof which have had the serial number removed, altered, defaced or rendered illegible.

Implied Warranties: ANY IMPLIED WARRANTIES WHICH THE PURCHASER MAY HAVE ARE LIMITED IN DURATION TO ONE (1) YEAR FROM THE DATE OF PURCHASE. Some states do not allow limitations on how long an implied warranty lasts, so the above limitation may not apply to you.

Warranty Performance: During the above one-year warranty period, a product with a defect will be either repaired or replaced with a reconditioned comparable model (at our option) when the product is returned to the Repair Center, or the purchase price refunded. The repaired or replacement product will be in warranty for the balance of the one-year warranty period and an additional one-month period. No charge will be made for such repair or replacement.

Service and Repair: Should the appliance malfunction, you should first call toll-free 1 (800) 233-9054 between the hours of 9:00 am and 5:00 pm Central Standard Time and ask for CONSUMER SERVICE stating that you are a consumer with a problem. Please refer to model number CEEK1 when you call.

In-Warranty Service (USA): For an appliance covered under the warranty period, no charge is made for service or postage. Call for return authorization a(1 800 233-9054).

Out-of Warranty Service: A flat rate charge by model is made for out-of-warranty service. Include \$8.00 (U.S.) for return shipping and handling. We will notify you by mail of the amount of the charge for service and require you to pay in advance for the repair or replacement.

For Products Purchased in the USA, but Used in Canada: You may return the product insured, packaged with sufficient protection, and postage and insurance prepaid to the USA address listed below. Please note that all customs duty / brokerage fees, if any, must be paid by you and we will require you to pay the cost of customs duty / brokerage fees to us in advance of our performing any service.

Risk During Shipment: We cannot assume responsibility for loss or damage during incoming shipment. For your protection, carefully package the product for shipment and insure it with the carrier. Be sure to enclose the following items with your appliance: any accessories related to your problem, your full return address and daytime phone number, a note describing the problem you experienced, a copy of your sales receipt or other proof of purchase to determine warranty status. C.O.D. shipments cannot be accepted.

To return the appliance, ship to:

Attn: Repair Center
708 South Missouri Street
Macon, MO 63552

To contact us, please write or call:

P.O. Box 7366
Columbia, MO 65205-7366
1(800) 233-9054

Limitation of Remedies: No representative or person is authorized to assume for the manufacturer any other liability in connection with the sale of our products. There shall be no claims for defects or failure of performance or product failure under any theory of tort, contract or commercial law including, but not limited to negligence, gross negligence, strict liability, breach of warranty and breach of contract. Repair, replacement or refund shall be the sole remedy of the purchaser under this warranty, and **in no event shall the manufacturer be liable for any incidental or consequential damages, losses or expenses.** Some states do not allow the exclusion or limitation of incidental or consequential damages, so the above limitation or exclusion may not apply to you.

Legal Rights: This warranty gives you specific legal rights, and you may also have other rights which vary from state to state.

cook's essentials® is a registered trademark of QVC, Inc.

© 2001 cook's essentials®

All Rights Reserved

P/N 60826

Printed in China 8/01