

intellichef[™]
by cook's essentials®



**HIGH SPEED BREWER
10 CUP COFFEEMAKER**

MODEL CEIRB10B

IMPORTANT SAFEGUARDS

When using electrical appliances, basic safety precautions should always be followed, including the following:

1. Read all instructions.
2. Do not touch hot surfaces. Use handles or knobs.
3. To protect against fire, electric shock and injury to persons do not immerse cord, plugs, or appliance in water or other liquid.
4. Close supervision is necessary when any appliance is used by or near children.
5. Unplug from outlet when not in use and before cleaning. Allow to cool before putting on or taking off parts, and before cleaning the appliance.
6. Do not operate any appliance with a damaged cord or plug or after the appliance malfunctions, or has been damaged in any manner. Contact Consumer Service for examination, repair or adjustment.
7. The use of accessory attachments not recommended by the appliance manufacturer may result in fire, electric shock or injury to persons.
8. Do not use outdoors.
9. Do not let cord hang over edge of table or counter, or touch hot surfaces.
10. Do not place on or near a hot gas or electric burner, or in a heated oven.
11. To disconnect remove plug from wall outlet.
12. Do not use appliance for other than intended use.
13. The Carafe is designed for use with this appliance. It must never be used on a range top.
14. Do not set a hot Carafe on a wet or cold surface.
15. Do not use a cracked Carafe or a Carafe having a loose or weakened handle.
16. Do not clean Carafe with cleansers, steel wool pads, or other abrasive material.

**SAVE THESE INSTRUCTIONS
FOR HOUSEHOLD USE ONLY**

ADDITIONAL IMPORTANT SAFEGUARDS

WARNING: This appliance generates heat and escaping steam during use. Proper precautions must be taken to prevent the risk of burns, fires, or other injury to persons or damage to property.

1. All users of this appliance must read and understand this Owner's Manual before operating or cleaning this appliance.
2. The cord to this appliance should be plugged into a 120V AC electrical outlet only.
3. Use **water only** in this appliance! Do not put any other liquids or food products in this appliance. Do not mix or add anything to the water placed in this appliance, except as instructed in the User Maintenance Instructions to clean the appliance.
4. DO NOT attempt to move an appliance containing hot liquids. Allow appliance to cool completely before moving.
5. Keep appliance at least 4 inches away from walls or other objects during operation. Do not place any objects on top of appliance while it is operating. Place the appliance on a surface that is resistant to heat.
6. If this appliance begins to malfunction during use, immediately unplug the cord. Do not use or attempt to repair the malfunctioning appliance.
7. If this appliance falls or accidentally becomes immersed in water or any other liquid, unplug it immediately. **Do not reach into the water! Do not use this appliance after it has fallen into or has become immersed in water.** Contact Consumer Service for examination and repair.
8. Do not leave this appliance unattended during use.
9. The appliance must be left to cool down sufficiently before adding more water to avoid splattering.
10. Always use fresh, cool water in your appliance. Warm water or other liquids, except as listed in the ROUTINE CLEANING section of this Owner's Manual, may cause damage to the appliance.
11. DO NOT put Carafe into a microwave.
12. DO NOT leave empty Carafe on Warming Plate when appliance is turned ON, as the Carafe may crack or become otherwise damaged.

SHORT CORD INSTRUCTIONS

A short power-supply cord is provided to reduce the risk resulting from becoming entangled in or tripping over a longer cord.

Do not use an extension cord with this product.

POLARIZED PLUG

This appliance has a polarized plug (one blade is wider than the other). To reduce the risk of electric shock, this plug is intended to fit into a polarized outlet only one way. If the plug does not fit fully in the outlet, reverse the plug. If it still does not fit, contact a qualified electrician.

Do not attempt to modify the plug in any way.

ELECTRIC POWER

If the electrical circuit is overloaded with other appliances, your appliance may not operate properly. It should be operated on a separate electrical circuit from other appliances.

PLASTICIZER WARNING

CAUTION: To prevent Plasticizers from migrating from the finish of the countertop or tabletop or other furniture, place **NON-PLASTIC** coasters or placemats between the appliance and the finish of the countertop or tabletop.

Failure to do so may cause the finish to darken, permanent blemishes may occur or stains can appear.

INTRODUCTION

Congratulations on your purchase of the cook's essentials® 10 Cup High Speed Brewer. This heavy-duty Coffeemaker instantly brews 10 cups of coffee in less than 4 minutes! Your High Speed Brewer is designed to brew Carafe after Carafe of fresh, delicious coffee on demand.

GETTING TO KNOW YOUR cook's essentials® 10 CUP HIGH SPEED BREWER

PRODUCT MAY VARY SLIGHTLY FROM ILLUSTRATIONS

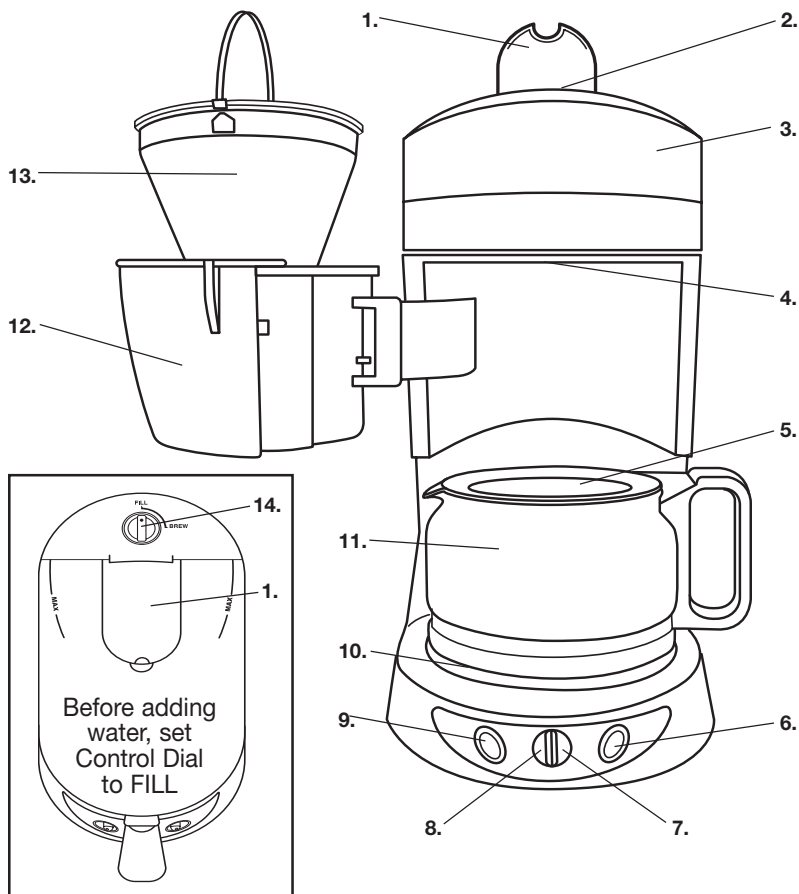

TOP VIEW

- | | |
|----------------------------------|--|
| 1. Water Chamber Lid | 9. ON/OFF Power Button |
| 2. Water Fill Area | 10. Warming Plate |
| 3. Water Chamber | 11. Glass Carafe w/Lid (P/N 31188B) |
| 4. Shower Head | 12. Swing-Out Filter Holder (P/N 31187B) |
| 5. Carafe Lid (P/N 31189B) | 13. Removable Filter (P/N 31186B) |
| 6. Warming Plate Button | 14. FILL/BREW Control Dial |
| 7. Warming Plate Indicator Light | |
| 8. Power Indicator Light | |

COFFEEMAKER FEATURES AND BENEFITS

The one-time initial set-up of the Coffeemaker (see BEFORE USING YOUR HIGH SPEED BREWER FOR THE FIRST TIME section of this Owner's Manual) prepares the Coffeemaker by filling the Water Chamber completely full of water and allowing time for the water to heat to proper brewing temperature. After this initial set-up is completed, each time you brew a pot of coffee the cold water you pour into the Coffeemaker pushes out an equal amount of pre-heated hot water from the Water Chamber. The hot water flows over the coffee grounds and produces a fresh, hot pot of coffee. The cold water you just poured in remains in the Water Chamber where it is heated in preparation to brew the next pot!

10-Cup Brewing Capacity: The Coffeemaker is designed to brew 6 to 10 cups of coffee at a time.

Removable Filter: The Removable Filter pulls out for fast and easy cleaning and filling.

Non-Stick Warming Plate: This feature allows you to keep your coffee hot after brewing. The non-stick coating prevents the Carafe from sticking to the surface of the Warming Plate.

To avoid damaging the Carafe, press the Warming Plate Button to turn the Warming Plate OFF when the Carafe is empty or when the Coffeemaker is not in use. The Light will turn OFF.

ON/OFF Power Button: Allows you to turn OFF the power to the Water Chamber Heater if the Coffeemaker will not be used for a few days.

NOTE: The Coffeemaker is designed to remain plugged in with the ON/OFF Power Button turned ON except during those times when your Coffeemaker is emptied for transport or storage or during times when it will not be used for several days.

If the Coffeemaker has been unplugged or if the Power Button is turned OFF for longer than a few hours it will take approximately 20 minutes, after the unit is plugged back in and the Power Button turned ON, to reheat the water supply to the proper temperature for brewing.

If the Coffeemaker has not been used for 3 or more days, it is recommended that the Water Chamber be emptied and replaced with fresh water.

BEFORE USING YOUR HIGH SPEED BREWER FOR THE FIRST TIME

Before using your High Speed Brewer for the first time, we suggest you become familiar with all of its parts. Read all instructions and cautions carefully.

INITIAL SET-UP

This initial set-up procedure prepares the Coffeemaker for use by filling the Water Chamber completely full of water and allowing time for the water to reach proper brewing temperature. This procedure is only required the first time the Coffeemaker has not been used, if your Coffeemaker has not been used for several days and has been emptied, or after the Coffeemaker has been drained for transport or long term storage. (See DRAINING YOUR COFFEEMAKER FOR TRANSPORT OR STORAGE section of this Owner's Manual.)

CAUTION: To avoid damage to the Coffeemaker, do not connect the power cord to a power outlet until the following steps have been completed.

NOTE: The Coffeemaker will be heavy after the initial set-up steps are completed. For that reason it is recommended you place your Coffeemaker where you intend to use it before following the initial set-up procedure.

1. Make sure the Coffeemaker is unplugged. Wash the Carafe, Carafe Lid and the Removable Filter in warm water and mild detergent. Rinse thoroughly then dry with a clean cloth. Place the Removable Filter in the Swing-Out Filter Holder.
2. For this initial set-up, set the Control Dial to BREW.
3. Fill the Carafe with fresh, cold water to the "10 cup" line.
4. Slowly empty the water into the Water Fill Area on top of the Coffeemaker. Allow a few minutes for the water to drain into the Water Chamber.
5. Fill the Carafe a second time with fresh, cold water to the "10 cup" line.
6. Slowly empty the water into the Water Fill Area on the top of the Coffeemaker. Allow a few minutes for the water to drain into the Water Chamber.
7. Fill the Carafe a third (final) time with fresh, cold water to the "2 cup" line corresponding to the top of the metal band.
8. Slowly empty the water into the Water Fill Area on top of the Coffeemaker and close the Water Chamber Lid.

NOTE: Adding more water than the amount specified may cause water to flow from the Removable Filter. If this occurs, replace the Carafe under the Swing-Out Filter Holder or use a separate container to collect the excess water. Make sure all excess water has been collected and Carafe has been emptied before moving on to the next step.

9. Plug the power cord into a working 120 Volt AC power outlet and press the Power Button. The Power Indicator Light will illuminate while appliance is ON.

NOTE: The Coffeemaker is designed to remain plugged in with the Power Button turned ON except during those times when your Coffeemaker is emptied for transport or storage or during times when it will not be used for several days.

10. Wait 20 minutes to allow the water in the Water Chamber to reach the proper brewing temperature.

BREWING COFFEE

Make sure that you have completed the initial set-up before brewing.

1. Set the Control Dial to FILL. This setting prevents the water from entering the Water Chamber and allows time for the Carafe to be placed in position before starting the brew cycle.
2. With the Removable Filter in position in the Swing-Out Filter Holder, place a standard #4 Cone Filter into the Removable Filter.
3. Use the SUGGESTED COFFEE MEASUREMENT CHART on the following page and add the appropriate amount of ground coffee to the cone filter. Move the Swing-Out Filter Holder in position on the Coffeemaker; it will snap when it is secure.

WARNING: To avoid risk of personal injury or damage to property, be sure that the Swing-Out Filter Holder is securely in place. Failure to secure the Swing-Out Filter Holder may result in hot water overflowing and spilling out of the machine.

SUGGESTED COFFEE MEASUREMENT CHART

For best results, use a level tablespoon for ground coffee measurement. We recommend using medium grind coffee for a perfect brew. *Use more or less coffee to adjust to your taste.

Number of Cups	Level Tablespoons*
10	7.5
8	6
6	4.5

NOTE: A 5 oz. cup is the American industry standard and is used by most Coffeemaker manufacturers.

4. Fill the Carafe with 6 to 10 cups of cold water.

NOTE: The Coffeemaker is designed to brew 6 to 10 cups of coffee at a time. Attempting to brew less than 6 cups is not recommended.

5. Carefully pour the water into the Water Fill Area on top of the Coffeemaker.
6. Place the Carafe on the Warming Plate.
7. To start the brew cycle, turn the Control Dial to BREW.
8. Press the Warming Plate Button to ON. The Warming Plate Indicator Light will illuminate.

NOTE: To avoid damaging the Carafe, the Warming Plate Button must be turned OFF when the Carafe is empty or when the Coffeemaker is not in use. The Warming Plate Indicator Light will turn OFF.

9. When the brew cycle is complete set the Control Dial to FILL to prepare machine for the next pot of coffee.
10. After allowing the coffee grounds to cool, carefully remove and discard the used coffee grounds and filter.

WARNING: Brewed coffee and grounds, both in the Removable Filter and Carafe are very hot! Handle with care to avoid scalding. If Removable Filter overflows, or if the Removable Filter fails to drain the coffee into the Carafe during the brew cycle, do not open or handle the Swing-Out Filter Holder and Removable Filter. Turn the Control Dial to FILL, unplug the Coffeemaker and wait for the contents to cool before opening.

DRAINING YOUR COFFEEMAKER FOR TRANSPORT OR STORAGE

The Water Chamber in your Coffeemaker should be emptied whenever the Coffeemaker will be transported, or stored for extended lengths of time.

WARNING: The Coffeemaker is very heavy. Use caution when draining the Water Chamber.

1. Press the Power Button to OFF and unplug the Coffeemaker power cord from the power outlet.

CAUTION: TO PREVENT INJURY DO NOT ATTEMPT TO DRAIN THE UNIT UNTIL THE WATER IN THE WATER CHAMBER HAS COOLED. THIS WILL TAKE SEVERAL HOURS.

NOTE: To shorten the length of time required for the water to cool, the hot water in the Water Chamber can be flushed out and replaced with cold water. To do this:

- a. Press the Power Button OFF and unplug the unit from the power outlet.
 - b. Using 10 cups of cold water follow the instructions outlined in the BREWING COFFEE section of this Owner's Manual. While performing this procedure do not use a filter or coffee grounds.
 - c. Repeat the 10 cup brewing process at least 3 times to ensure that the hot water in the Water Chamber has been replaced with cold water.
2. Turn the Control Dial to FILL.
 3. Remove the Carafe, Removable Filter and Swing-Out Filter Holder.
 4. Grasp the back of the Coffeemaker firmly and tip the unit forward over a sink at a 45 degree angle until the water begins to flow out of the Shower Head.
 5. Slowly tip the Coffeemaker to a 90 degree angle until the flow of water stops.

NOTE: To ensure that your Coffeemaker will function properly in the future **NEVER TIP THE COFFEEMAKER BEYOND 90 DEGREES.** The small amount of water remaining in the Coffeemaker following this procedure will evaporate in a few days time.

USER MAINTENANCE INSTRUCTIONS

ROUTINE CLEANING

Before cleaning, always make sure that the Warming Plate is powered OFF and is completely cool.

Before cleaning, remove the Carafe from unit, make sure Carafe is completely cool.

The Carafe, Carafe Lid and the Removable Filter should be rinsed with water after each use.

After daily use, hand wash the Carafe and Carafe Lid in hot, sudsy water. **DO NOT PLACE IN DISHWASHER.**

The Removable Filter and Swing-Out Filter Holder are top rack dishwasher-safe.

If necessary, wipe the outside of the Coffeemaker with a soft, damp cloth and wipe dry. Do not use abrasive cleansers, scouring pads or steel wool.

Occasionally, window cleaners, vinegar and water solutions, standard non-abrasive kitchen cleaning fluids, or commercially available products for stainless steel surfaces can be used. After cleaning, use a soft cloth to dry and buff the surface to a brilliant shine.

DESCALING

We recommend that you descale your Coffeemaker once a month because mineral deposits can form a coating in the Coffeemaker, causing slower brewing time and possibly an off flavor in the coffee. Use a cleaner recommended for coffeemakers or the solution described below.

1. Press the Power Button OFF. Unplug the Coffeemaker power cord from the power outlet.
2. Place the Swing-Out Filter Holder in position on the Coffeemaker.
3. Place the Carafe on the Warming Plate.
4. Slowly pour 1 quart (32 fluid ounces) of undiluted white household vinegar into the top of the Coffeemaker.

NOTE: As the vinegar is poured in, hot water will be pushed from the Water Chamber and flow through the Removable Filter into the Carafe.

5. When the flow of water stops, empty the Carafe then replace it on the Warming Plate.
6. Wait 2 hours before proceeding. This will allow the vinegar time to break down the lime and mineral deposits.
7. After 2 hours, the vinegar may be rinsed from the Coffeemaker.
 - a. Using 10 cups of cold water follow the instructions outlined in the BREWING COFFEE section of this Owner's Manual. While performing this procedure do not use a filter or coffee grounds.
 - b. Repeat the 10 cup brewing process at least 8 times to ensure that the vinegar in the Water Chamber has been replaced with cold water.

NOTE: An easy way to determine if all the vinegar has been rinsed out is to sprinkle a small amount of baking soda into the water in the Carafe after it has completed the brewing cycle. The baking soda will react with the vinegar. A gentle fizzing indicates that there is still vinegar in the water and the procedure should be repeated. If there is no reaction then it means that all of the vinegar has been rinsed clean.

CLEANING THE CARAFE

Hard water can leave a whitish mineral deposit inside the Carafe. Coffee can discolor these deposits, sometimes leaving a brownish stain. To remove these stains, follow these simple steps:

1. Use a solution of equal parts: white household vinegar and hot water.
2. Let solution stand in Carafe for about 20 minutes and then discard.
3. Wash and rinse the Carafe thoroughly using a soft cloth. Do not use harsh abrasive cleaners. These may cause scratches which can lead to breakage.

WARNING: NEVER IMMERSE THE COFFEEMAKER IN WATER OR OTHER LIQUIDS.

