

OWNER'S MANUAL

Model No. BL6LG

Salton®

PERSONAL BLENDER



IMPORTANT SAFEGUARDS

When using electrical appliances, basic safety precautions should always be followed including the following:

1. Read all instructions.
2. To protect against risk of electrical shock do not put cord, plugs, or appliance in water or other liquid.
3. Close supervision is necessary when any appliance is used by or near children.
4. Unplug from outlet when not in use, before putting on or taking off parts, and before cleaning.
5. Avoid contacting moving parts.
6. Do not operate any appliance with a damaged cord or plug or after the appliance malfunctions, or is dropped or damaged in any manner. Contact Consumer Service for examination, repair or electrical or mechanical adjustment.
7. The use of attachments, including canning jars, not recommended by the manufacturer may cause a risk of injury to persons.
8. Do not use outdoors.
9. Do not let cord hang over edge of table or counter.
10. Do not let cord contact hot surface, including the stove.
11. Keep hands and utensils out of the Blending Jar while blending to reduce the risk of severe injury to persons or damage to the Blender. A scraper may be used but must be used only when the Blender is not running.
12. Blades are sharp. Handle carefully.
13. Always operate Blender with Blending Jar Lid in place.
14. When blending hot liquids, remove center piece of two-piece Lid.

SAVE THESE INSTRUCTIONS
THIS PRODUCT IS FOR HOUSEHOLD USE ONLY

ADDITIONAL IMPORTANT SAFEGUARDS

1. All users of this appliance must read and understand this Owner's Manual before operating or cleaning this appliance.
2. The cord to this appliance should be plugged into a 120V AC electrical outlet only.
3. Do not leave this appliance unattended during use.
4. If this appliance begins to malfunction during use, immediately turn the Control Switch to the (O) OFF position and unplug the cord. Do not use or attempt to repair the malfunctioning appliance.
5. If this appliance falls or accidentally becomes immersed in water, unplug it immediately. **Do not reach into the water!** Do not use this appliance after it has fallen into or becomes immersed in water.
6. To reduce the risk of injury to persons or property, never use this appliance in an unstable position.
7. Do not use this appliance for other than its intended use.
8. Do not use if the Blending Jar is cracked or chipped.

POLARIZED PLUG

This appliance has a polarized plug (one blade is wider than the other). To reduce the risk of electric shock, this plug is intended to fit into a polarized outlet only one way. If the plug does not fit fully in the outlet, reverse the plug. If it still does not fit, contact a qualified electrician. Do not attempt to modify the plug in any way.

SHORT CORD INSTRUCTIONS

A short power supply cord is provided to reduce the risk resulting from becoming entangled in or tripping over a longer cord. Do not use an extension cord with this product.

PLASTICIZER WARNING

CAUTION: To prevent Plasticizers from migrating from the finish of the counter top or table top or other furniture, place NON-PLASTIC coasters or place mats between the appliance and the finish of the counter top or table top.

Failure to do so may cause the finish to darken, permanent blemishes may occur or stains can appear.

ELECTRIC POWER

If the electrical circuit is overloaded with other appliances, your appliance may not operate properly. It should be operated on a separate electrical circuit from other appliances.

GETTING TO KNOW YOUR **SALTON®** PERSONAL BLENDER

PRODUCT MAY VARY SLIGHTLY FROM ILLUSTRATIONS

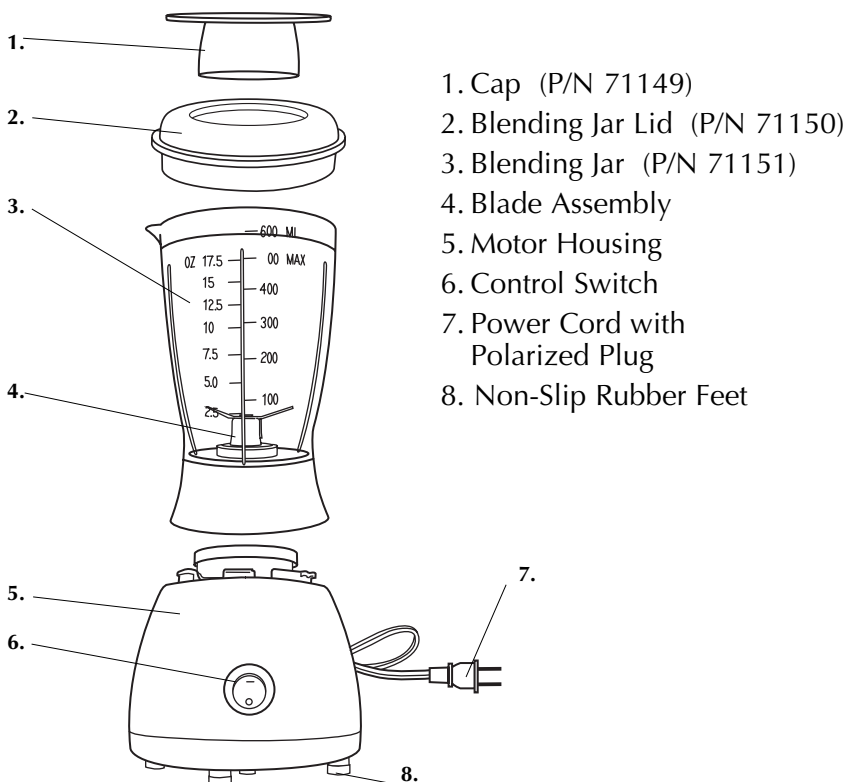

BEFORE USING FOR THE FIRST TIME

CAUTION: Use extreme care when handling the Blade Assembly.

Do not touch the Blades with your fingers. The Blades are very sharp and can cause injury if touched.

1. Carefully unpack the Blender, Blending Jar, and all parts.
2. Wash the Cap, Blending Jar and Blending Jar Lid in warm soapy water. Rinse and dry thoroughly.
3. Make sure the cord is unplugged and the Control Dial is in the (O) OFF position.

CAUTION: To protect against risk of electrical shock, do not place Motor Housing, plug or cord in water or any other liquid.

4. Wipe the Motor Housing clean with a moistened cloth. Dry thoroughly.

BLENDER ASSEMBLY INSTRUCTIONS

NOTE: Before assembling, make sure the cord is unplugged and the Control Dial is in (O) OFF position.

CAUTION: Use extreme care when handling the Blade Assembly. Do not touch Blades with your fingers. The Blades are very sharp and can cause injury if touched.

1. Carefully place the Blending Jar over the Motor Housing by aligning the Arrow with the Unlock Position (see Figure 1.)
2. Once Blending Jar is in place, turn counterclockwise until the arrow is aligned with the Lock Position and the Blending Jar locks into place (see Figure 2.)



Figure 1

NOTE: The Blending Jar must be firmly attached to the Motor Housing before putting any foods or liquids into the Blending Jar.



Figure 2

OPERATING INSTRUCTIONS

CAUTION: Keep hands and utensils out of the Blending Jar while blending to prevent the possibility of severe injury to persons or damage to the unit. A scraper may be used but must only be used when the unit is not running.

CAUTION: Use extreme care when handling the Blender Blade. Do not touch Blades with your fingers. The Blades are very sharp and can cause injury if touched.

1. Before starting, make sure power cord is unplugged and the Control Dial is in (O) OFF position.
2. Make sure that the Blending Jar is securely fastened to the Motor Housing. See Assembly Instructions for details.

CAUTION: Never place the Blade Assembly on the Motor Housing without the Blending Jar being completely assembled and securely tightened.

3. Add ingredients to the Blending Jar and secure the Blending Jar Lid.

NOTE: Do not fill the Blending Jar more than 3/4 full (13-oz.) Never operate when the Blending Jar is empty.

4. Place Blending Jar Lid with Cap on Blending Jar. Remember: Always hold Lid in place during processing.

OPERATING INSTRUCTIONS (CONTINUED)

5. Plug the power cord into a 120V AC electrical outlet. Press the Control Switch to ON (--). Blend until ingredients have reached desired consistency.

CAUTION: If Blending Jar rotates during blending, immediately turn Control Dial to (O) OFF, then secure by turning until the arrow is aligned with the Lock Position and the Blending Jar locks into place as described in the BLENDER ASSEMBLY INSTRUCTIONS (see Figure 2.)

- Do not touch Blades
 - Do not interfere with the Blade movement
 - Do not remove Blending Jar Lid
7. When blending is completed, press the Control Switch to (O) OFF to stop the Blender and unplug the unit.

HOT INGREDIENTS

CAUTION: Use extreme caution when blending hot liquids to avoid accidental scalding or burns. Do not use your hand to cover opening!

NOTE: When processing hot foods, always remove the Cap from the Lid before beginning.

- DO NOT put more than 2.5 ounces of hot ingredients into the Blending Jar before beginning to blend.
- After the blending process has begun, you may slowly add up to an additional 2.5 ounces of hot ingredients through the center hole in the Lid.
- Always use a vessel with a pouring spout when adding hot ingredients.

USER MAINTENANCE INSTRUCTIONS

This appliance requires little maintenance. It contains no user serviceable parts. Do not try to repair it yourself. Any servicing that requires disassembly other than cleaning must be performed by a qualified appliance repair technician.

CAUTION: Never immerse the Motor Housing, plug or cord in water or any other liquid.

1. Always unplug the unit before cleaning.
2. Whenever possible, rinse parts immediately after processing to make cleanup easier.

CAUTION: Use extreme care when handling the Blade Assembly. Do not touch the Blades with your fingers. The Blades are very sharp and can cause injury if touched.

3. Wash the Blending Jar, Lid, and Cap in warm soapy water. Rinse and dry thoroughly. Never use rough scouring pads or abrasive cleansers on any plastic or metal parts as the surface may be damaged. Do not wash the Lid, Cap and Blending Jar in the dishwasher.
4. If necessary, wipe exterior surface with a moist cloth or sponge and dry thoroughly.
5. Do not fill the Blending Jar with boiling water or place any of the parts in boiling water.
6. Do not allow the Blade Assembly to soak in water for long periods of time.
7. For quick clean-ups, the interior of the Blending Jar can be cleaned by turning the Blender ON and OFF for several short bursts. The unit will clean itself, without you having to handle the sharp Blades. Unplug the Blender, rinse and dry thoroughly, being careful as the Blades are sharp.
8. Properly reassemble all parts before storing.

STORAGE

CAUTION: Always assemble clean and dry Blender parts correctly before storing on the Motor Housing. Severe injury can result if Blender is accidentally turned ON when not properly assembled.

Unplug and clean unit. Store in original box or in a clean, dry place. Never store Blender while it is hot or plugged in. Never wrap cord tightly around the appliance. Never place any stress on cord, especially where the cord enters the unit, as this could cause the cord to fray and break.

LIMITED ONE YEAR WARRANTY

Warranty Coverage: This product is warranted to be free from defects in materials or workmanship for a period of one (1) year from the original purchase date. This product warranty is extended only to the original consumer purchaser of the product and is not transferable. For a period of one (1) year from the date of original purchase of the product, our Repair Center will, at its option, either (1) repair the product or (2) replace the product with a reconditioned comparable model. These remedies are the purchaser's exclusive remedies under this warranty.

Warranty Service: To obtain warranty service, you must call our warranty service number at 1-800-233-9054 for return instructions on how to deliver the product, in either the original packaging or packaging affording an equal degree of protection to the Repair Center specified below. You must enclose a copy of your sales receipt or other proof of purchase to demonstrate eligibility for warranty coverage.

To return the appliance, ship to:

ATTN: Repair Center
708 South Missouri Street
Macon, MO 63552 USA

To contact us, please write to, call, or email:

Consumer Relations Department
PO Box 7366
Columbia MO 65205-7366 USA
1-800-233-9054
E-mail:
consumer_relations@toastmaster.com

What Is Not Covered: This warranty does not cover damage resulting from misuse, accident, commercial use, improper service or any other damage caused by anything other than defects in material or workmanship during ordinary consumer use. This warranty is invalid if the serial number has been altered or removed from the product. This warranty is valid only in the United States and Canada.

LIMITATION ON DAMAGES: THERE SHALL BE NO LIABILITY FOR ANY INCIDENTAL OR CONSEQUENTIAL DAMAGES FOR BREACH OF ANY EXPRESS OR IMPLIED WARRANTY OR CONDITION ON THIS PRODUCT.

DURATION OF IMPLIED WARRANTIES: EXCEPT TO THE EXTENT PROHIBITED BY APPLICABLE LAW, ALL IMPLIED WARRANTIES AND CONDITIONS, INCLUDING, WITHOUT LIMITATION, IMPLIED WARRANTIES AND CONDITIONS OF MERCHANTABILITY AND FITNESS FOR A PARTICULAR PURPOSE OR USE ON THIS PRODUCT ARE LIMITED IN DURATION TO THE DURATION OF THIS WARRANTY.

Some jurisdictions do not allow the exclusion or limitation of incidental or consequential damages, or allow limitations on how long an implied warranty lasts, so the above limitations or exclusions may not apply to you. This warranty gives you specific legal rights and you may have other rights under the laws of your jurisdiction.

For more information on our products, visit our website: www.maxim-toastmaster.com.

Made in China
05/05

P/N 61689

OWNER'S MANUAL

Model No. PC6LG

Salton®

POPCORN MAKER



IMPORTANT SAFEGUARDS

When using electrical appliances, basic safety precautions should always be followed including the following:

1. Read all instructions.
2. Do not touch hot surfaces. Use handles or knobs.
3. To protect against electric shock do not immerse cord, plugs, or appliance in water or other liquid.
4. Close supervision is necessary when any appliance is used by or near children.
5. Unplug from outlet when not in use and before cleaning. Allow to cool before putting on or taking off parts, and before cleaning the appliance.
6. Do not operate any appliance with a damaged cord or plug or after the appliance malfunctions or has been damaged in any manner. Contact Consumer Service for examination, repair or adjustment.
7. The use of accessory attachments not recommended by the appliance manufacturer may cause injuries.
8. Do not use outdoors.
9. Do not let cord hang over edge of table or counter, or touch hot surfaces.
10. Do not place on or near a hot gas or electric burner, or in a heated oven.
11. To disconnect turn any control to "off", then remove plug from wall outlet.
12. Do not use appliance for other than intended use.
13. A popper that is plugged into an outlet should not be left unattended.
14. This popper will not shut off automatically. To avoid overheating add corn before operating.
15. Extreme caution must be used when unloading popcorn.

SAVE THESE INSTRUCTIONS

For Household Use Only

ADDITIONAL IMPORTANT SAFEGUARDS

CAUTION HOT SURFACES: This appliance generates heat and escaping steam during use. Proper precautions must be taken to prevent the risk of burns, fires, or other injury to persons or damage to property.

CAUTION: This appliance is hot during operation and retains heat for some time after turning off. Always use oven mitts when handling hot materials and allow metal parts to cool before cleaning. Do not place anything on top of the appliance while it is operating or while it is hot.

1. All users of this appliance must read and understand this Owner's Manual before operating or cleaning this appliance.
2. The cord to this appliance should only be plugged into a 120V AC electrical wall outlet.
3. If this appliance begins to malfunction during use, immediately unplug the cord. Do not use or attempt to repair the malfunctioning appliance.
4. Do not leave this appliance unattended during use.

Polarized Plug

This appliance has a polarized plug (one blade is wider than the other). To reduce the risk of electrical shock, this plug is intended to fit into a polarized outlet only one way. If the plug does not fit fully in the outlet, reverse the plug. If it still does not fit, contact a qualified electrician. Do not attempt to modify the plug in any way.

Short Cord Instructions

A short power-supply cord is provided to reduce the risk resulting from becoming entangled in or tripping over a longer cord.

Do not use an extension cord with this product.

Electric Power

If the electrical circuit is overloaded with other appliances, your appliance may not operate properly. It should be operated on a separate electrical circuit from other appliances.

Plasticizers Warning

CAUTION: To prevent Plasticizers from migrating from the finish of the countertop or tabletop or other furniture, place NON-PLASTIC coasters or placemats between the appliance and the finish of the countertop or tabletop.

Failure to do so may cause the finish to darken, permanent blemishes may occur or stains can appear.

CAUTION: UNPLUG APPLIANCE FROM ELECTRICAL OUTLET WHEN ASSEMBLING, REMOVING PARTS OR CLEANING. NEVER PLACE BASE OR CORD IN WATER OR OTHER LIQUIDS.

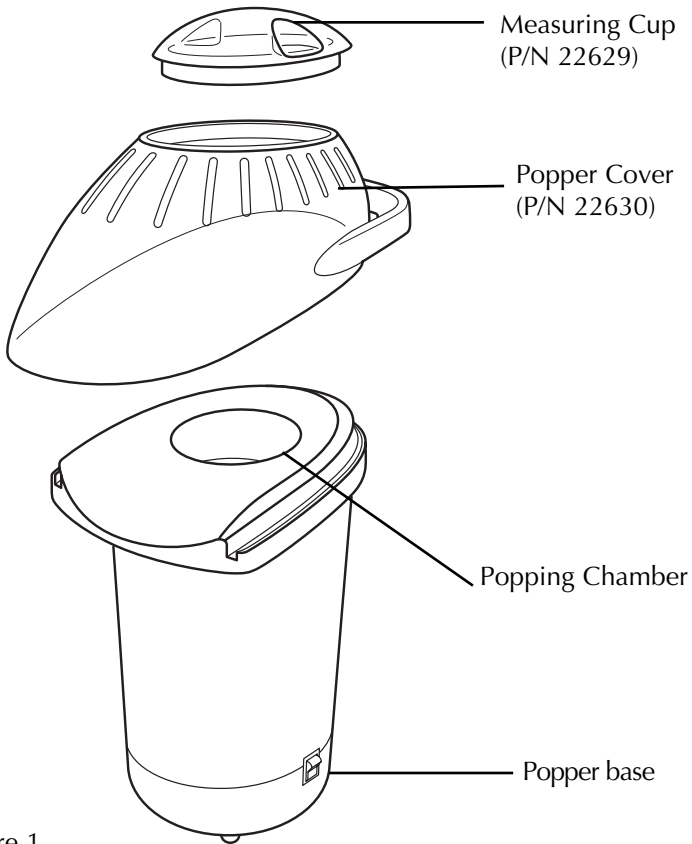

Figure 1

Using Your Hot Air Popcorn Popper

NEVER IMMERSE THE POPPER BASE IN WATER OR OTHER LIQUID.

ONLY MELT BUTTER WHILE POPPING KERNELS!

1. Before using for the first time, wash popper cover and measuring cup in warm, soapy water; rinse and dry thoroughly.
2. Remove popper cover and measuring cup from popper base. Fill the measuring cup to the Max line with kernels and add to popping chamber. Do not fill measuring cup past the Max line - Kernels should be level in measuring cup. Measuring cup = 1/2 cup. Never add more than 1/2 cup of popcorn kernels to the popping chamber at one time. Do not put any other ingredients such as oil, shortening, butter, margarine, salt and sugar into popping chamber as damage will occur.
3. Place popper cover onto base, positioning bottom edge of cover into groove of base. The measuring cup may be used to melt butter while the unit pops the kernels. If not melting butter, place measuring cup onto popper cover as shown in Figure 1. If melting butter, turn measuring cup over and place inverted onto the popper cover. Never add more than 1/4 cup of butter to the measuring cup. Make sure butter is at room temperature. Cut butter into 8 slices before placing in measuring cup. Note: When using the measuring cup to measure kernels, always wash and dry the measuring cup after each batch of popcorn when melting butter.
4. Place a heat-proof popcorn serving bowl under the front of the popper cover. If a plastic bowl is used, be sure it will withstand heat without melting. A metal bowl may become hot to the touch, but it will tend to keep the popcorn warmer.
5. Plug unit into a 120V~60 Hz outlet and press the On/Off Switch to On (—).
6. Press the On/Off Switch to Off (O) and unplug when popping is complete. **DO NOT OPERATE THIS UNIT EMPTY. DO NOT ATTEMPT TO MELT BUTTER WITHOUT POPCORN IN CHAMBER.** Due to variances in the popcorn type, freshness and moisture content, some popped or unpopped kernels may remain in the chamber after the popping has stopped. To prevent scorching, unplug the popper without waiting for this corn to clear the unit.

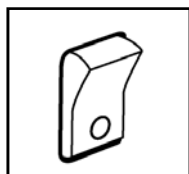

On/Off Switch

CAUTION: AS KERNELS MAY CONTINUE TO POP EVEN AFTER UNIT IS UNPLUGGED, MAKE SURE ALL POPPING HAS STOPPED BEFORE REMOVING COVER.

CAUTION: USE OVEN MITTS WHEN HANDLING HOT SURFACES OF THE UNIT. TO AVOID TEMPORARY MALFORMATION OF THE COVER, ALLOW IT TO COOL ON THE UNIT BASE AFTER POPPING.

7. For additional batches, unplug unit. Make sure the popping chamber is empty. Carefully remove excess popcorn or left over unpopped kernels. Then repeat steps 2 through 6. Note: When popping more than one or two batches of corn, allow the popper to cool down for at least 10 minutes.

Helpful Hints

- This popcorn popper is designed to pop regular and premium brands of popcorn. Try different brands to find the one you like best. Yellow kernels generally pop larger than white. One half cup unpopped kernels will yield approximately 3.5 quarts of popcorn.
- Always use fresh popcorn. Stale or dried-out popcorn pops poorly and may cause scorching or smoking.
- Carefully select the bowl you will be using to collect popped corn. A metal bowl may become very hot to the touch due to the flow of hot air from the chute and must be handled carefully. It will, however, tend to keep the popcorn warm. If a plastic bowl is used, be certain it can withstand the heat caused by the warm air flow without melting.
- Never use more than 1/2 cup of kernels per batch.
- Never add salt, sugar or other flavorings into popping chamber.
- This is an AIR corn popper. Popcorn will pop by circulating hot air. Oils, fats or shortening are not needed and should never be used. Do not use microwave popcorn in this appliance.

How to Clean Your Popcorn Popper

1. Unplug and allow unit to cool before cleaning.
2. Wash the popper cover and measuring cup in warm, soapy water. Rinse and dry thoroughly. Do not wash in dishwasher. Wipe the corn popper base, including the popping chamber, clean and dry with a soft dry cloth. Never immerse the corn popper base in water or other liquid. Do not scour surfaces with steel wool or abrasive cleaners.
3. Store fully assembled with cover in place.

Any servicing requiring disassembly other than the above cleaning must be performed by a qualified appliance repair technician.

Cord Storage

Unplug appliance and allow to cool. There is convenient cord storage area on the bottom of the machine. Simply wind the Cord around the Cord Storage area and store in its box or in a clean, dry place.

LIMITED ONE YEAR WARRANTY

Warranty Coverage: This product is warranted to be free from defects in materials or workmanship for a period of one (1) year from the original purchase date. This product warranty is extended only to the original consumer purchaser of the product and is not transferable. For a period of one (1) year from the date of original purchase of the product, our Repair Center will, at its option, either (1) repair the product or (2) replace the product with a reconditioned comparable model. These remedies are the purchaser's exclusive remedies under this warranty.

Warranty Service: To obtain warranty service, you must call our warranty service number at 1-800-233-9054 for return instructions on how to deliver the product, in either the original packaging or packaging affording an equal degree of protection to the Repair Center specified below. You must enclose a copy of your sales receipt or other proof of purchase to demonstrate eligibility for warranty coverage.

To return the appliance, ship to:

ATTN: Repair Center
708 South Missouri Street
Macon, MO 63552 USA

To contact us, please write to, call, or email:

Consumer Relations Department
PO Box 7366
Columbia MO 65205-7366 USA
1-800-233-9054
E-mail:
consumer_relations@toastmaster.com

What Is Not Covered: This warranty does not cover damage resulting from misuse, accident, commercial use, improper service or any other damage caused by anything other than defects in material or workmanship during ordinary consumer use. This warranty is invalid if the serial number has been altered or removed from the product. This warranty is valid only in the United States and Canada.

LIMITATION ON DAMAGES: THERE SHALL BE NO LIABILITY FOR ANY INCIDENTAL OR CONSEQUENTIAL DAMAGES FOR BREACH OF ANY EXPRESS OR IMPLIED WARRANTY OR CONDITION ON THIS PRODUCT.

DURATION OF IMPLIED WARRANTIES: EXCEPT TO THE EXTENT PROHIBITED BY APPLICABLE LAW, ALL IMPLIED WARRANTIES AND CONDITIONS, INCLUDING, WITHOUT LIMITATION, IMPLIED WARRANTIES AND CONDITIONS OF MERCHANTABILITY AND FITNESS FOR A PARTICULAR PURPOSE OR USE ON THIS PRODUCT ARE LIMITED IN DURATION TO THE DURATION OF THIS WARRANTY.

Some jurisdictions do not allow the exclusion or limitation of incidental or consequential damages, or allow limitations on how long an implied warranty lasts, so the above limitations or exclusions may not apply to you. This warranty gives you specific legal rights and you may have other rights under the laws of your jurisdiction.

For more information on our products, visit our website: www.maxim-toastmaster.com.

Made in China
05/05

P/N 61688