

# Westinghouse



**WST7502 WARM MIST HUMIDIFIER**

You can be sure...if it's Westinghouse

# IMPORTANT SAFEGUARDS

When using electrical appliances, basic safety precautions should always be followed to reduce the risk of fire, electric shock, and injury to persons, including the following:

1. Read all instructions before using the appliance.
2. To avoid fire or shock hazard, plug the appliance into a 3-prong grounded 120V AC electrical outlet.
3. Keep the cord out of heavy traffic areas. To avoid fire hazard, NEVER put the cord under rugs, near heat registers, radiators, stoves, or heaters.
4. DO NOT place Humidifier near heat sources such as stoves, radiators, and heaters. For best results, place your Humidifier on an inside wall near an electrical outlet, with the back of the unit at least 4 inches (102 mm) from the wall.
5. NEVER place Humidifier in an area where it is accessible to children.
6. NEVER use Humidifier in a closed room, particularly where a child may be sleeping, resting, or playing (a closed room may result in excessive humidity).
7. **WARNING: Do not attempt to refill Humidifier without first unplugging the unit from its electrical outlet. Failure to heed this warning may cause personal injury.**
8. Never place anything over Warm Mist Outlet when the unit is running.
9. NEVER drop or insert any object into any openings.
10. DO NOT operate any appliance with a damaged cord or plug, if the appliance malfunctions, or if it has been dropped or damaged in any manner. Return appliance to manufacturer for examination, electrical or mechanical adjustment, or repair.
11. Use appliance only for intended household use as described in this manual. Any other use not recommended by the manufacturer may cause fire, electric shock, or injury to persons. The use of attachments not recommended or sold by the manufacturer may cause hazards.
12. DO NOT use outdoors.
13. Always place Humidifier on a firm, flat, level surface, with the front of the Warm Mist Outlet at least 6 feet 6 inches from the nearest wall. A waterproof mat or pad is recommended for underneath the Humidifier. NEVER place it on a rug or carpet, or on a finished floor that may be damaged by exposure to water or moisture.

14. DO NOT allow the Warm Mist Outlet to directly face the wall. Moisture could cause damage, particularly to wall paper.
15. The Humidifier should be unplugged when not in use.
16. NEVER tilt, move, or attempt to empty while the Warm Mist Humidifier is operating. Press the ON/OFF Button to turn the unit OFF and unplug before removing the Water Tank and moving the unit.
17. This Humidifier requires daily and weekly maintenance. Refer to daily and weekly cleaning procedures. Use only cleaners and additives recommended by the manufacturer.
18. NEVER use detergents, gasoline, glass cleaner, furniture polish, paint thinner, or other household solvents to clean any part of the Humidifier.
19. Excessive humidity in a room can cause water condensation on windows and some furniture. If this happens, turn the Humidifier OFF.
20. Do not use Humidifier in an area where humidity level is in excess of 50%. The built-in digital humidistat is for reference only.
21. DO NOT attempt to repair or adjust any electrical or mechanical functions on this unit. Doing so will void your warranty. The inside of the unit contains no user serviceable parts. All servicing should be performed by qualified personnel only.
22. Never place Humidifier Housing under water flow or immerse in liquids.
23. Do not plug in the cord with wet hands: electric shock could result.
24. Do not block air inlets or outlet grills.
25. Do not fill through openings other than the Water Tank.
26. Keep Humidifier upright at all times. Do not turn it on its side or upside down.

## **READ & SAVE THESE INSTRUCTIONS**

### **FOR HOUSEHOLD USE ONLY**

## CONSUMER SAFETY INFORMATION

**NOTE:** This is an electrical appliance and requires attention when in use.

**NOTE:** If moisture forms on the walls or windows of the room, turn OFF the Humidifier. The room already has plenty of humidity and additional moisture may cause damage.

**NOTE:** DO NOT block air inlets or Warm Mist outlet.

## GROUNDING 3-CONDUCTOR PLUG

This appliance is equipped with a grounded-type 3-wire cord (3-prong plug). This plug will only fit into an electrical outlet made for a 3-prong plug. This is a safety feature. If the plug should fail to fit the outlet, contact an electrician to replace the obsolete outlet. Do not attempt to defeat this safety feature.

## SHORT CORD INSTRUCTIONS

A short power-supply cord is provided to reduce the risk resulting from becoming entangled in or tripping over a longer cord.

Do not use an extension cord with this product.

## ELECTRIC POWER

If the electrical circuit is overloaded with other appliances, your appliance may not operate properly. It should be operated on a separate electrical circuit from other appliances.

## PLASTICIZER WARNING

**CAUTION:** To prevent Plasticizers from migrating from the finish of the countertop or tabletop or other furniture, place NON-PLASTIC coasters or placemats between the appliance and the finish of the countertop or tabletop.

**Failure to do so may cause the finish to darken, permanent blemishes may occur or stains can appear.**

# Getting To Know Your Westinghouse WST7502 Warm Mist Humidifier

Product may vary slightly from illustrations.

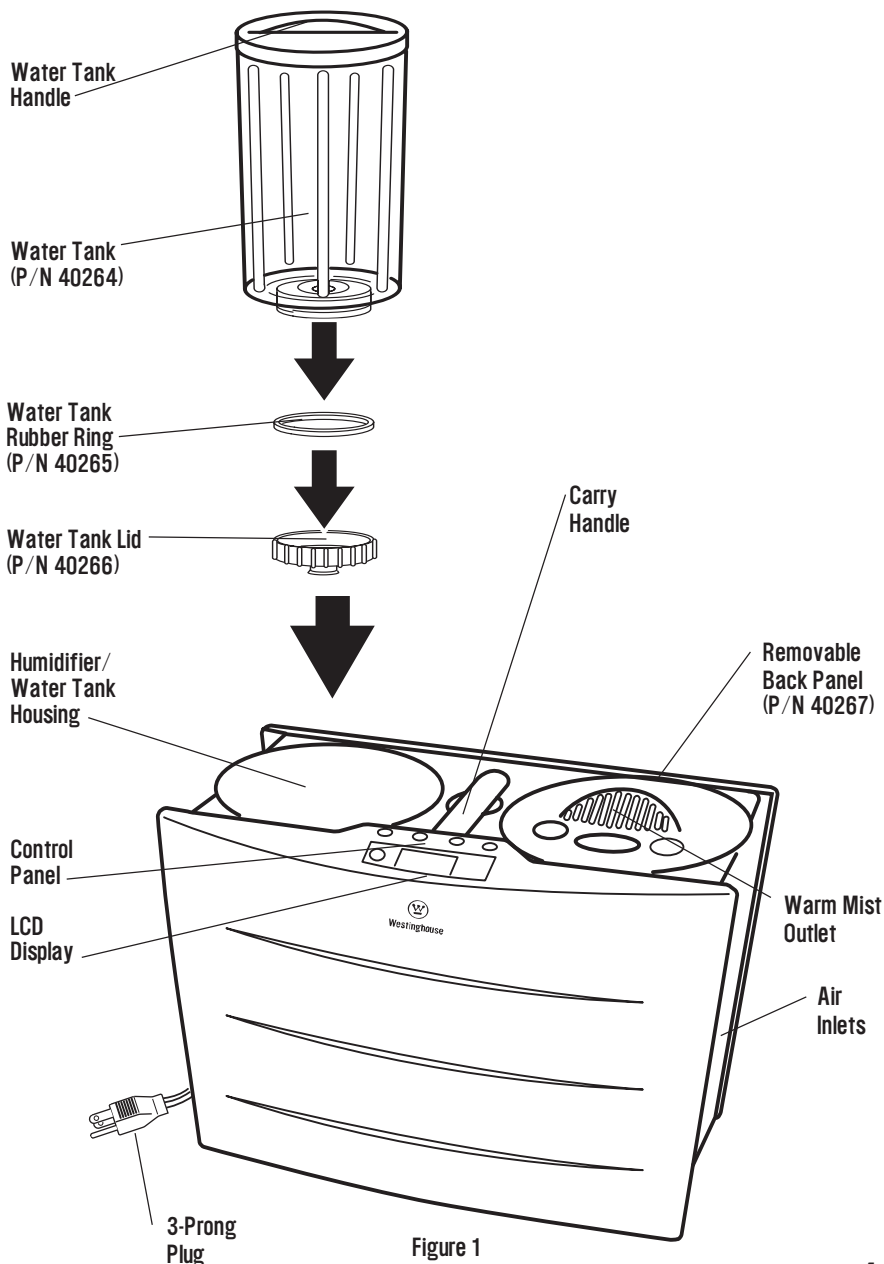

Figure 1

# INTRODUCTION

Your Warm Mist Humidifier is designed to dispense a warm mist quietly and efficiently while maintaining your preferred level of humidity. Enjoy continuous warm air misting or program the Humidifier to run from 1 to 8 hours with automatic shut off.

**NOTE: The Warm Mist Humidifier holds 1.2 gallons of water and will run for 7 hours of continuous operation before refilling is necessary.**

**NOTE: A humidity level below 20% can be unhealthy and uncomfortable. The recommended humidity level is between 40% and 50%.**

## BEFORE USING FOR THE FIRST TIME

1. Be sure the Humidifier is switched to OFF and the unit is unplugged.
2. Choose a suitable location for the Warm Mist Humidifier on a flat surface, with the front of the Warm Mist Outlet at least 6 feet 6 inches from the nearest wall. DO NOT place the Humidifier on a finished floor or near furniture, which can be damaged by moisture or water. NEVER place the Humidifier in a closed room.
3. Lift the Warm Mist Humidifier using the Carry Handle and place on a moisture-resistance surface.

## FILLING THE WATER TANK

1. Use the Water Tank Handle (on the top of the Water Tank) to lift the Tank straight up and out of the Humidifier Housing. Turn the empty Tank upside down; unscrew the Water Tank Lid by turning counter-clockwise. Remove the Lid.
2. Fill Tank with cool, tap water or bottled distilled water.\*

**\*In areas where tap water is hard, it is recommended that distilled water be used.**

**CAUTION: The Water Tank is delicate and may crack if dropped or bumped. To ensure proper performance of your Warm Mist Humidifier, use care when filling and transporting the Water Tank.**

**WARNING: DO NOT fill with warm water as this may cause leaking.**

**IMPORTANT: Check the inside of the Lid to make sure the Rubber Seal Ring is correctly positioned before replacing the Lid.**

3. Make sure the Rubber Ring is in position, sitting flat in the groove on the inside of the Lid. Twist the Lid clockwise and firmly lock onto the Tank.
4. Firmly grasping the Water Tank Handle, re-insert into the Humidifier Housing inside the Water Basin. The Tank will immediately begin to empty into the Water Basin of the Humidifier.

**NOTE: Replace the Water Tank so that the Water Tank Handle faces left.**

# OPERATING INSTRUCTIONS

## CONTROL PANEL

Figure 2

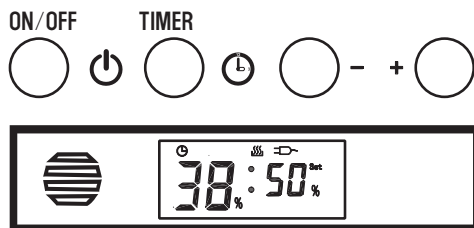

## LCD DISPLAY

Figure 3

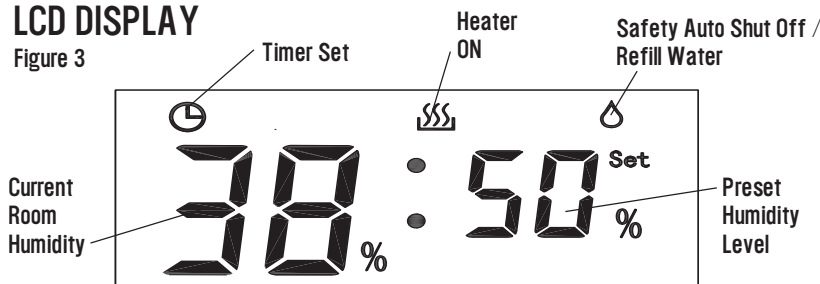

Your Humidifier is operated directly from the Control Panel located on the top of the unit. Timer Set, Heater ON, remaining time, current room humidity, preset humidity level, Safety Auto Shut Off/Refill Water are shown on the LCD Display.

1. Plug the Warm Mist Humidifier into a 3-prong grounded 120V AC electrical outlet. The current room humidity will illuminate.
2. Press the ON/OFF Button to turn the unit ON. As the unit is on, the Heater ON symbol will appear on the LCD Display.
3. The Warm Mist Humidifier displays current humidity and the previously preset humidity. When the current humidity level is less than the preset humidity level, a fine mist will moisten the air until the preset humidity level is reached. The Humidifier will automatically cycle ON and OFF as it maintains the proper humidity level.

**NOTE:** The Warm Mist Outlet may be rotated from the front to 45 degrees to the right. Adjust for your comfort and make sure the front of the Warm Mist Outlet is at least 6 feet 6 inches from the nearest wall.

**NOTE:** If the current room humidity is greater or equal to the preset humidity level, the unit will not operate.

**NOTE:** If the water droplet appears on the LCD Display, check the water level in the Water Tank and refill if necessary. It is recommended that the Water Tank be refilled BEFORE it runs completely empty. The unit cannot be operated until the water droplet stops flashing.

4. Press the ON/OFF Button again to turn the unit OFF.

## ADJUSTING THE HUMIDITY

**NOTE:** The Warm Mist Humidifier allows you to adjust humidity levels between 30% to 70%. For maximum comfort, the recommended humidity level is between 40% and 50%.

1. Plug the Warm Mist Humidifier into a 3-prong grounded 120V AC electrical outlet. The current room humidity will be illuminated on the LCD Display.
2. Press the ON / OFF Button to turn the unit ON. The preset room humidity will be shown.
3. To adjust the current room humidity, press '+' or '-' Button to increase or decrease the humidity level. Each time the Button is pressed, the SET humidity level % on the right side of the LCD Display will increase or decrease 1%. Hold the Button to advance the setting continuously. When the desired humidity level is shown, release the Button.

**NOTE:** If the current room humidity is greater or equal to the preset humidity level, the unit will not operate.

**NOTE:** If moisture forms on the walls or windows, turn the Humidifier OFF.

## HARD WATER

Hard water contributes to inefficient humidifier results. Hard water forms a scale of limescale deposits that can cause a film on the Heater Surface, Water Basin and Water Tank and cause the water to become cloudy.

**NOTE:** In areas where tap water is hard, it is recommended that distilled water be used.

## SAFETY AUTO SHUT OFF

**NOTE:** When the Water Tank/Water Basin is empty during operation, the Humidifier will automatically shut itself OFF. The water droplet symbol will appear on the LCD Display to signal the Water Tank should be refilled and the current room humidity will be displayed. The unit cannot be operated until the water droplet stops flashing.

If this happens, follow these Reset Instructions to re-start your Humidifier:

1. Unplug the unit.
2. Allow at least 20 minutes for the Heating Element to cool down completely.
3. Remove and refill the Water Tank, replace the Tank into the Humidifier Housing on the Water Basin.
4. Plug the Warm Mist Humidifier into a 3-prong grounded 120V AC electrical outlet. Follow "Operating Instructions" outlined in this Owner's Manual to restart operation.



## USING THE PROGRAMMABLE TIMER

The Warm Mist Humidifier can be programmed to run for a preset duration and then automatically turn itself OFF after the set amount of time.

1. Press the TIMER Button to select run time of the unit. Each time the Button is pressed, the Display will advance from 8hr, 4hr, 2hr or 1hr and then back to CONTINUOUS RUN.

**NOTE: The Warm Mist Humidifier holds 1.2 gallons of water and will run for 7 hours of continuous operation before refilling is necessary.**

2. The clock symbol will flash for 5 seconds after the Timer selection is made. The Timer program is now set for the selected duration. The Display will revert back the current room humidity.
3. The clock symbol will illuminate in the Display to show the TIMER has been set. After the pre-determined length of time has passed, the Humidifier will automatically shut itself OFF. The TIMER Button may be pressed at any time to show "time remaining" on the LCD Display.
4. If the clock symbol is not illuminated, the Humidifier is set to CONTINUOUS RUN and will continue to operate as long as the Water Tank has an adequate amount of water to run, or until the Humidifier reaches the desired set humidity.

# DISASSEMBLY/REASSEMBLY DIAGRAM

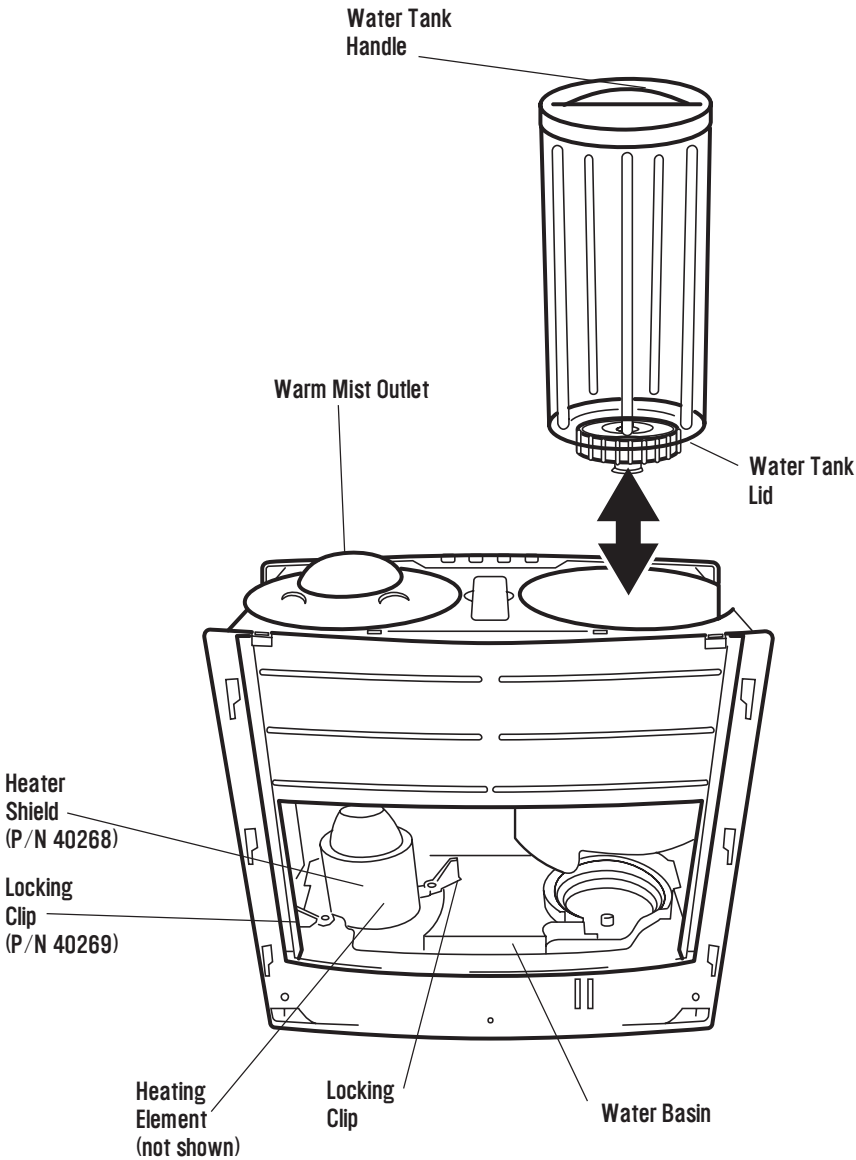

**Figure 4**  
Warm Mist Humidifier with back removed.  
Humidifier must be set up with the back facing any wall.

# USER MAINTENANCE INSTRUCTIONS

This appliance requires little maintenance. It contains no user serviceable parts. Do not try to repair it yourself. Any servicing requiring disassembly other than cleaning, must be performed by a qualified appliance repair technician.

## CARE AND CLEANING

The following maintenance procedure must be routinely followed in order to ensure proper, efficient operation of your Humidifier.

**IMPORTANT: The unit WILL NOT WORK CORRECTLY if it is not cleaned and maintained properly. Proper cleaning is absolutely essential to avoid algae or bacteria build-up.**

When the unit is in use, daily and weekly maintenance is recommended to prevent scale buildup and micro-organisms from growing on both the Heating Element and the Water Basin. This ensures that maximum efficiency will be achieved.

## Instructions for Disassembly

1. Unplug Humidifier from the electrical outlet. Allow at least 20 minutes for the Heating Element to cool before beginning daily maintenance.
2. Use the Water Tank Handle (on the top of the Water Tank) to lift the Tank straight up and out of the Humidifier Housing. Remove Water Tank Lid and discard water.
3. Lift the Back Panel straight up and off the Warm Mist Humidifier to expose the inner parts. (See Figure 4.) Turn the 2 Locking Clips located on the floor of the Water Basin of the unit to release the Heater Shield. Remove the Heater Shield to expose the Heating Element.

## Cleaning Instructions

1. Tip the Water Basin over a sink to empty the water. **Take care not to immerse the plug or the LCD Display in water.** Rinse the Water Basin thoroughly with clear tap water. Wipe the Water Tank and Warm Mist Outlet clean with a damp sponge. Carefully dry with a clean lint-free cloth or paper towel.
2. The Heating Element is lined with a coating that is designed to provide the easiest cleaning and prolong the operating efficiency of the Humidifier. **DO NOT** use any metal or hard objects to clean the Heating Element. Never use detergents, gasoline, kerosene, glass cleaner, furniture polish, paint thinner or and other household solvent to clean any part of the Humidifier.
3. Reassemble the Warm Mist Humidifier following the instructions outlined in the “instructions for Reassembly” section of this Owner’s Manual..

## WEEKLY MAINTENANCE: Scale Removal

1. Allow 20 minutes for the Heating Element to cool down completely. Follow procedures outlined in the section entitled Instructions for Disassembly.
2. Drain Water Basin of unused water. Then partially fill the Water Basin with one 8-oz cup of undiluted white vinegar. Allow this solution to remain sitting in the Water Basin for 20 minutes, while cleaning the interior surfaces with a soft brush. Dampen a lint-free cloth with undiluted white vinegar and wipe down the Water Basin thoroughly.
3. Rinse with clean warm water to remove the cleaning solution before disinfecting the Tank. **Take care not to immerse the plug in water.**

## Disinfect the Water Tank

1. Fill the Tank half full with water and 1/2 teaspoon of chlorine bleach. Replace Lid.
2. Allow the solution to stand in the Water Tank for 20 minutes, swishing every few minutes. Make sure all surfaces are wet.
3. Carefully empty the Tank after 20 minutes, and rinse with water until you cannot detect any bleach smell.
4. Refill the Water Tank with cool tap water. Replace Water Tank by inserting into the Humidifier Housing. Repeat all Operation Instructions.

## Instructions for Reassembly

1. Reassemble the Humidifier. After all parts are cleaned, replace the Heater Shield over the Heating Element. Turn the 2 Locking Clips into position at the base of the unit and lock into place.
2. Replace the Back Panel by holding it against the back of the unit. The top of the Back Panel has 4 tabs and both the left and right sides have 3 tabs respectively that fit easily into the back top of the unit. Slide the Back Panel down until all tabs are locked into position.
3. If you have cleaned the unit for the next season, replace the Water Tank without the Lid. Follow Storage Instructions outlined in this Owner's Manual.

# TROUBLESHOOTING

TROUBLE	PROBABLE CAUSE	SOLUTION
Unit does not operate when power is ON.	Unit not plugged in.	Plug in unit.
	Power failure.	Check circuit breaker.
	Current room humidity is equal to or greater than preset room humidity.	Increase desired humidity to a higher level.
	Water Tank and Water Basin are empty. Safety Auto Shut Off has turned unit OFF.	Refill Water Tank. Follow manual for Reset Instructions.
Humidity Display not illuminated.	Unit not plugged in.	Plug in unit.
	Power failure.	Check circuit breaker or outlet.
Water Droplet warning signal is displayed.	Water Tank and Water Basin needs refilling.	Refill Tank. Follow manual for Reset Instructions.
Mist output minimal to none.	Scale build-up in Water Basin or heating element.	Remove scale from Water Basin and heating element.
Water leaks from Tank.	Tank Rubber Ring is missing or improperly placed.	Remove Tank Lid and replace or reposition Ring.
	Cap not tight enough.	Tighten the Cap.
	Tank water hot.	Tank may be damaged call 1-800-233-9054.
Crack in Tank.	Hot water will cause Tank to pressurize.	Fill with cool water only.
	Tanks are delicate, and will crack if dropped.	Handle Tank with care.
Film on Tank.	Mineral deposits cause film on Tank to build-up.	Clean / disinfect Tank as instructed in cleaning instructions. To order call 1-800-233-9054.
Cloudy Water.	Mineral deposits cause film on Tank to build-up.	Clean / disinfect Tank as instructed in weekly cleaning instructions. To order call 1-800-233-9054.

## STORAGE INSTRUCTIONS

If your Humidifier will not be in use for 2 days or more, or at the end of the season follow these instructions.

1. Clean, rinse and thoroughly dry the Humidifier as directed in the weekly maintenance section. **DO NOT** leave any water inside the Water Basin.
2. Wait for the heating element to cool completely, and then clean the heating element with a damp soft cloth.
3. Remove the Tank Lid. **Do not store with the Tank Lid in place.**
4. Place the Humidifier in the original carton and store in a cool, dry place.
5. Always clean the Humidifier before the next season begins.

## PARTS REPLACEMENT

To order replacement parts:

- Visit our website at [www.maxim-toastmaster.com](http://www.maxim-toastmaster.com), or
- Call consumer service at 1-800-233-9054.

## LIMITED ONE-YEAR WARRANTY

**Warranty Coverage:** This product is warranted to be free from defects in materials or workmanship for a period of one (1) year from the original purchase date. This product warranty is extended only to the original consumer purchaser of the product and is not transferable. For a period of one (1) year from the date of original purchase of the product, our Repair Center will, at its option, either (1) repair the product or (2) replace the product with a reconditioned comparable model. These remedies are the purchaser's exclusive remedies under this warranty.

**Warranty Service:** To obtain warranty service, you must call our warranty service number at 1-800-233-9054 for return instructions on how to deliver the product, in either the original packaging or packaging affording an equal degree of protection to the Repair Center specified below. You must enclose a copy of your sales receipt or other proof of purchase to demonstrate eligibility for warranty coverage.

**To return** the appliance, ship to:

ATTN: Repair Center  
708 South Missouri Street  
Macon, MO 63552 USA

**To contact us**, please write to, call, or email:

Consumer Relations Department  
PO Box 7366  
Columbia MO 65205-7366 USA  
1-800-233-9054  
E-mail: [consumer\\_relations@toastmaster.com](mailto:consumer_relations@toastmaster.com)

**What Is Not Covered:** This warranty does not cover damage resulting from misuse, accident, commercial use, improper service or any other damage caused by anything other than defects in material or workmanship during ordinary consumer use. This warranty is invalid if the serial number has been altered or removed from the product. This warranty is valid only in the United States and Canada.

**LIMITATION ON DAMAGES:** THERE SHALL BE NO LIABILITY FOR ANY INCIDENTAL OR CONSEQUENTIAL DAMAGES FOR BREACH OF ANY EXPRESS OR IMPLIED WARRANTY OR CONDITION ON THIS PRODUCT.

**DURATION OF IMPLIED WARRANTIES:** EXCEPT TO THE EXTENT PROHIBITED BY APPLICABLE LAW, ALL IMPLIED WARRANTIES AND CONDITIONS, INCLUDING, WITHOUT LIMITATION, IMPLIED WARRANTIES AND CONDITIONS OF MERCHANTABILITY AND FITNESS FOR A PARTICULAR PURPOSE OR USE ON THIS PRODUCT ARE LIMITED IN DURATION TO THE DURATION OF THIS WARRANTY.

Some jurisdictions do not allow the exclusion or limitation of incidental or consequential damages, or allow limitations on how long an implied warranty lasts, so the above limitations or exclusions may not apply to you. This warranty gives you specific legal rights and you may have other rights under the laws of your jurisdiction.

For more information on our products, visit our website: [www.maxim-toastmaster.com](http://www.maxim-toastmaster.com).

WESTINGHOUSE,  and "You Can Be Sure...If It's Westinghouse" are trademarks of WESTINGHOUSE ELECTRIC CORPORATION and used under license.

©2005 Patents Pending. All rights reserved.

Made in China

P/N 61762

7/05